

Standalone Presence Detectors

Exceptional lighting control solutions



CP Electronics

A brand of **legrand**



Contents

Infrared Handsets



UNLCDHS

Professional programming/
commissioning LCD handset

4



UHS5

Compact programming/
commissioning handset

4



UHS7

Compact user handset

4

PIR Presence Detectors



EBDSPIR

Compact, flush mounted detectors

5



EBDSM

Compact, surface mounted
detectors

6



EBDMR

Mid range, flush mounted detectors

7



EBMHS

Miniature, flush/surface mounted
detectors

8



EBMPIR-MB

Miniature, retrofit, luminaire
mounted detectors

9



EBDRC

Long range, adjustable head,
flush mounted detectors

10

CP Electronics offer building-wide control.



Our wide range of presence detectors are designed to reduce the amount of time lighting or HVAC equipment is left on unnecessarily – for example if an area is unoccupied or if there is sufficient natural light.

Controlling lighting with a presence detector can save up to 60% of lighting energy usage dependent on occupancy behaviour and the amount of natural light available. Selected PIR and microwave presence detectors can also be used to control heating and ventilation.

In our range you are sure to find a presence detector that will suit any space.









PIR Presence Detectors

	EBDHS High bay/high level, flush mounted detectors	11
	EBDHS-MB High bay/high level, luminaire mounted detectors	12

Air Conditioning Controller

	GESM-AC Surface mounted controller for air conditioning	13
---	---	----



Microwave Presence Detectors

	MWS3A Adjustable head, long range, flush mounted detectors	14
	MWS5 Compact, flush/surface mounted detectors	15
	MWS6 Compact, flush mounted detectors	16
	MWS6SM Compact, surface mounted detectors	17
	MWS1A Low profile, back box mounted detectors	18
	MWS1A-IP Rugged, surface mounted detectors	19

Light Level Controls

	ALC Compact, flush mounted switching and dimming photocells	20
--	---	----

Product Spotlight

	Low Temperature detectors	21
	KNX presence detectors	21

Technology Guide

Presence and absence detection explained	22
PIRs and microwave detectors compared	23
Walk towards & walk across explained (PIR Detectors)	23
PRM detectors – switching with lux level sensing	24
DD & AD detectors – dimming with lux level sensing	25

Order Codes

26

Infrared Handsets

Our range of infrared (IR) handsets have been designed to allow simple configuration, programming and maximum user convenience.

There's a handset to suit every user, whether it's the commissioning engineer configuring hundreds of detectors, a contractor setting up two or three, or a user who simply wishes to override a setting or switch between pre-programmed scenes.



UNLCDHS

UNLCDHS – Professional commissioning LCD programming handset

- The UNLCDHS is used for the operation, configuration and programming of CP products that have the ability to be programmed via IR. These include the PRM, DD, AD, Vitesse Plus, RAPID, D-Mate and An-10 ranges.
- Infrared range up to 20m.



UHS5



UHS7

UHS5 – Commissioning handset

- The UHS5 is a compact infrared handset used for the basic programming of IR enabled CP products
- Infrared range up to 7m.

UHS7 – User handset

- User handset for simple scene setting, on & off, raise & lower
- Infrared range up to 7m.

EBDSPIR | Compact, flush mounted detectors



This compact ceiling mounted PIR presence detector provides automatic control of lighting, heating and ventilation loads.

- Low profile design
- Self contained unit
- Pluggable
- Programme time delay and lux settings via infrared handset (excluding Basic variant).
- Available in a wide range of RAL colours
- 5 year warranty.

Available control methods

- B – Basic switching
- PRM – Switching
- DD – DALI/DSI dimming
- AD – Analogue dimming
- KNX – See page 22

Special order variants

- LT30 – Low temperature
 - LV – Low voltage
 - VFC – Voltage free contact
 - 2CH – 2 channel
- Additional variants available – please see our website.

Detection pattern

high < sensitivity > low

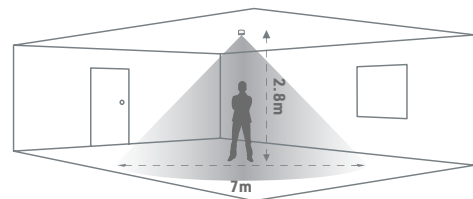

Dimensions (mm)

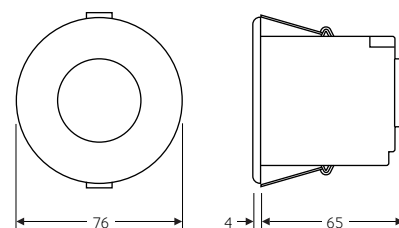

EBDSM | Compact, surface mounted detectors



This series of surface mounted PIR presence/absence detectors is perfect for simple attachment when flush mounting is not possible.

- Self contained unit
- Easy to install via back plate
- Programme time delay and lux settings via infrared handset
- IP40 (no gasket); IP54 when fitted with gasket
- 5 year warranty.

Available control methods

- PRM – Switching
- DD – DALI/DSI dimming
- AD – Analogue dimming

Detection pattern

high < sensitivity > low

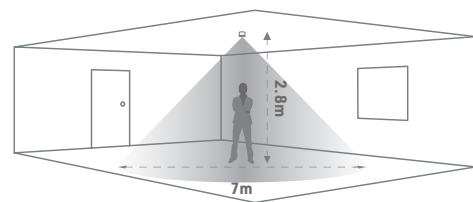

Dimensions (mm)

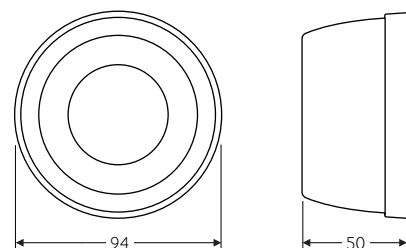

EBDMR | Mid range, flush mounted detectors



Our series of compact flush mounted PIR presence/absence detectors with high performance faceted lens is suitable for use in open spaces or where a larger detection range is required.

- Mid range lens with concentric lens facets for improved detection
- Ideal for open spaces
- Programme time delay and lux settings via infrared handset
- IP40 rated
- Available in a wide range of RAL colours
- 5 year warranty.

Available control methods

- PRM – Switching
- DD – DALI/DSI dimming
- AD – Analogue dimming

Special order variants

- LV – Low voltage
- Additional variants available to special order – please see our website.

Detection pattern

high < sensitivity > low

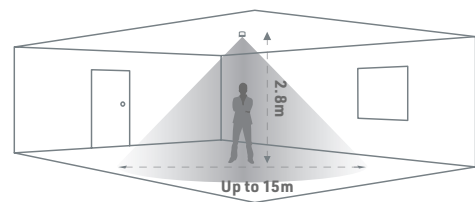

Dimensions (mm)

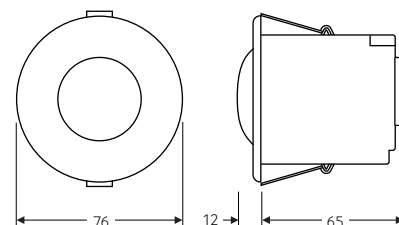

EBMHS | Miniature, flush/surface mounted detectors



This small, unobtrusive, but highly capable PIR presence/absence detector is supplied pre-wired and with a connector that snap-fits into the power supply unit (PSU) for ease of installation.

- Small and unobtrusive design
- High sensitivity head for increased detection range
- Programme time delay and lux settings via infrared handset
- Supplied pre-wired with an RJ11 plug for connection into the power supply
- Supplied with a flush mounting ring for easy fitting into the ceiling.
- Available with standard or slim line PSU
- 5 year warranty.

Available control methods

- PRM – Switching
- DD – DALI/DSI dimming
- AD – Analogue dimming

Special order variants

- LV – Low voltage

Detection pattern

high < sensitivity > low

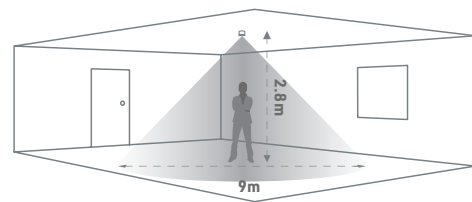

Dimensions (mm)

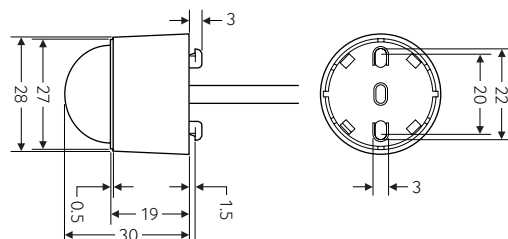

EBMPIR-MB | Miniature, retrofit, luminaire mounted detectors



The EBMPIR-MB series of batten mount PIR presence detectors have been designed specifically for mounting on to a batten style luminaire.

- Batten mount retrofit solution
- Integrated power supply
- Suitable for a wide range of luminaires
- Pre wired with 1m cable
- Programme time delay and lux settings via infrared handset
- IP65 rated for wet and damp environments
- For mounting at heights up to 7m
- 5 year warranty.

Available control methods

- PRM – Switching
- DD – DALI/DSI dimming
- AD – Analogue dimming

Special order variants

- LT30 – Low temperature
- LV – Low voltage (110V)

Detection pattern

high < sensitivity > low

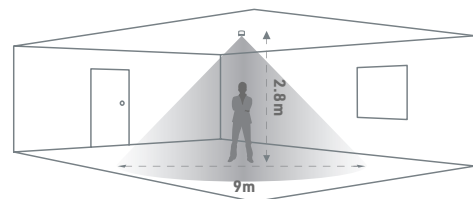

Dimensions (mm)

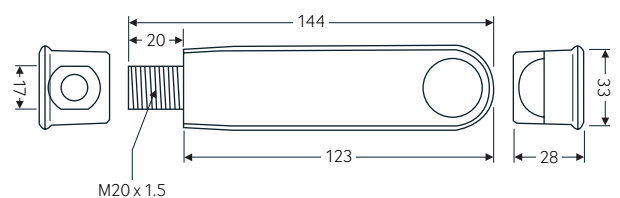

EBDRC | Long range, adjustable head, flush mounted detectors



Head can be adjusted to suit the detection pattern required

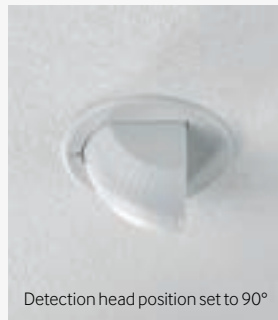

The EBDRC series of PIR presence/absence detectors contains an adjustable head, and is fitted with a curtain lens for long range detection. Our directional PIR is suitable for mounting in aisleway and corridor applications where a long narrow detection pattern is required.

- Adjustable head
- Curtain lens for longer detection range
- Programme time delay and lux settings via infrared handset
- IP40 rated
- Ideal for corridor applications
- 5 year warranty.

Available control methods

- PRM – Switching
- DD – DALI/DSI dimming
- AD – Analogue dimming

Special order variants

Additional variants available to special order – please see our website.

Detection pattern

high < sensitivity > low

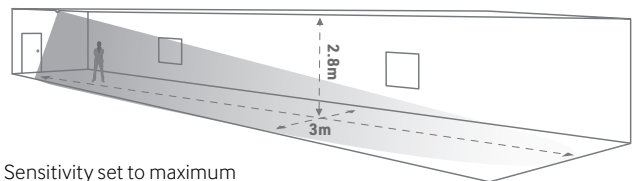

Sensitivity set to maximum
Detector head position set to 90°

Range	
Walk towards	10m
Walk across	24m

See page 23 for Walk towards and Walk across explained.

Dimensions (mm)

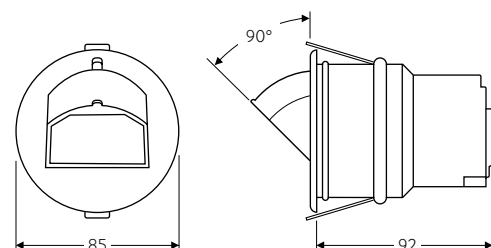

EBDHS | High bay/high level, flush mounted detectors



The EBDHS PIR presence/absence detector is developed for lighting control in areas with demanding spaces and increased mounting heights.

- Ground breaking detection range
- For mounting at heights up to 20m depending on operating parameters
- Unique lens technology – high sensitivity
- Ideal for high level/high bay applications
- Programme time delay and lux settings via infrared handset
- Supplied with adjustable masking shields to tailor detection zones
- 5 year warranty.

Available control methods

- PRM – Switching
- DD – DALI/DSI dimming
- AD – Analogue dimming
- KNX – See page 22

Special order variants

- LT30 – Low temperature
- LV – Low voltage

Detection pattern

high < sensitivity > low

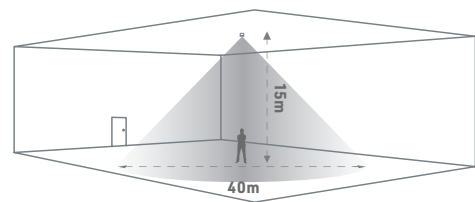

Dimensions (mm)

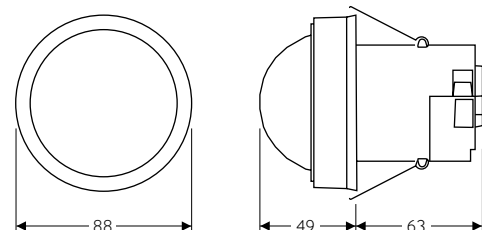

EBDHS-MB | High bay/high level, luminaire mounted detectors

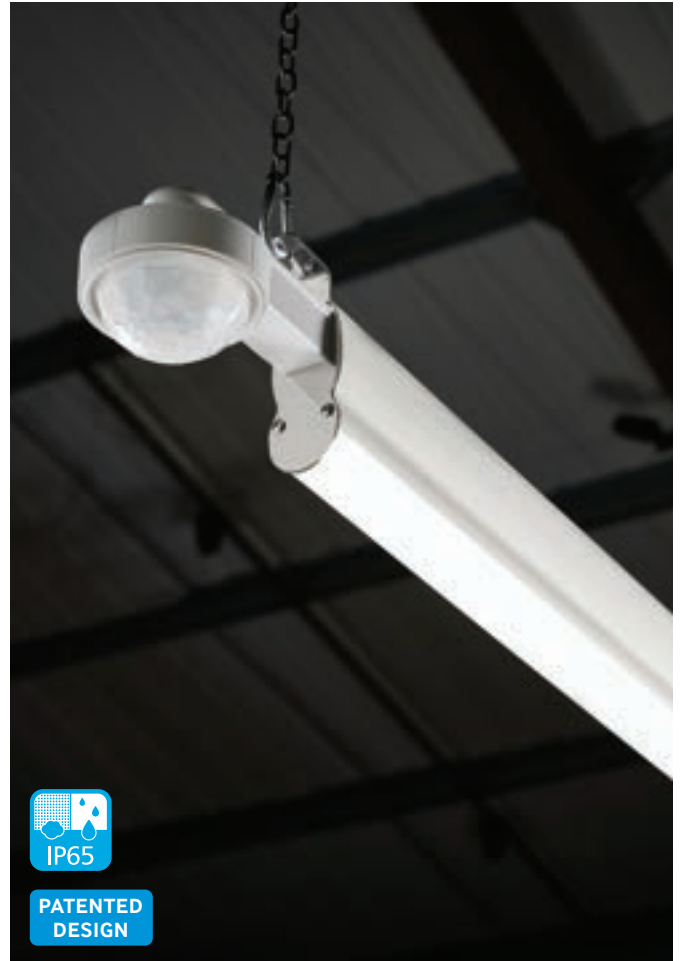

PATENTED DESIGN

The EBDHS-MB luminaire mounted PIR presence detector series provides exceptionally sensitive and long range detection. Ideal for high bay lighting control in areas with demanding spaces and increased mounting heights.

- Ground breaking detection range
- For mounting at heights up to 20m depending on operating parameters
- Unique lens technology – high sensitivity
- Ideal for high level/high bay applications
- Programme time delay and lux settings via infrared handset
- Easy to retrofit to commercial luminaires and basic battens
- 5 year warranty.

Available control methods

- PRM – Switching
- DD – DALI/DSI dimming
- AD – Analogue dimming

Special order variants

- LT30 – Low temperature

Detection pattern

high < sensitivity > low

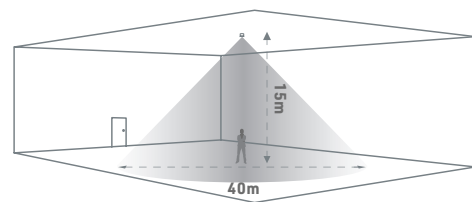

Dimensions (mm)

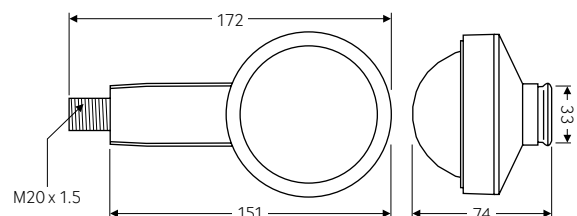

GESM-AC | Surface mounted controller for air conditioning



This AC unit simply 'learns' an AC unit's infrared code, then controls its operation, based on occupancy. As it is surface mounted and battery powered, installation is simplified and disruption is reduced.

- Compatible with most infrared controlled AC units
- Battery operated
- Presence detection - auto on, auto off
- Adjust time delay settings via push buttons
- Lockable settings
- Sleep mode extends battery life
- 5 year warranty.

Detection pattern

high < sensitivity > low

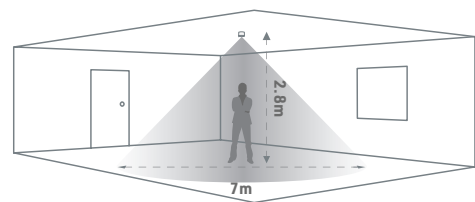

Dimensions (mm)

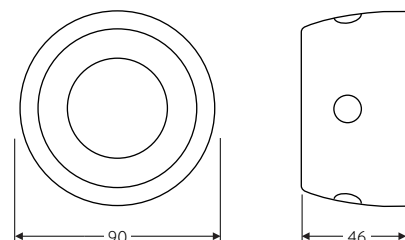

MWS3A | Adjustable head, long range, flush mounted detectors



Unlike fixed head microwave detectors, the MWS3A series of presence/absence detectors offers a unique adjustable head to suit the required detection pattern.

- Unique adjustable head design to achieve the required detection pattern
- Locking mechanism to prevent tampering
- Can be flush or surface mounted
- Programme time delay and lux settings via infrared handset
- IP40 rated
- 5 year warranty.

Available control methods

- PRM – Switching
- DD – DALI/DSI dimming
- AD – Analogue dimming
- KNX – See page 22

Special order variants

- LV – Low voltage
- VFC – Voltage free contact
- VFC NC – Voltage free contact normally closed
- 2CH – 2 channel
- 2CH-NC – 2 channel normally closed



Detection pattern

high < sensitivity > low

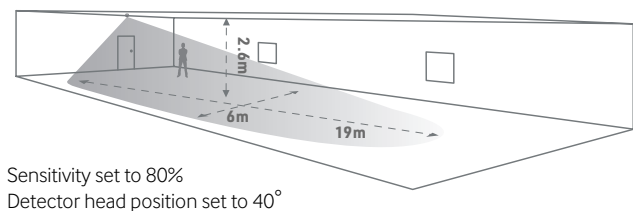
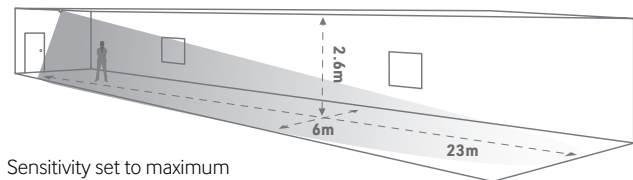
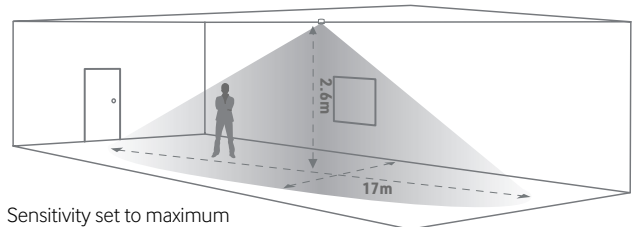

Dimensions (mm)

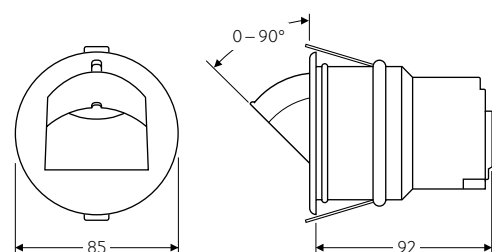

MWS5 | Compact, flush/surface mounted detectors



The MWS5 series of compact microwave presence/absence detectors has been specifically designed to be mounted within a luminaire. They are sensitive to movement and are ideal for large spaces that have an awkward shape.

- Can be flush or surface mounted
- Remote power supply allows head to be fitted in confined spaces
- Suitable for wall or ceiling mounted luminaires
- A selection of fixing clips to allow the unit to be mounted in or to the side of a luminaire is available
- Programme time delay and lux settings via infrared handset
- Standard and slimline power supply units also available
- 5 year warranty.

Available control methods

- PRM – Switching
- DD – DALI/DSI dimming
- AD – Analogue dimming

Detection pattern

high < sensitivity > low

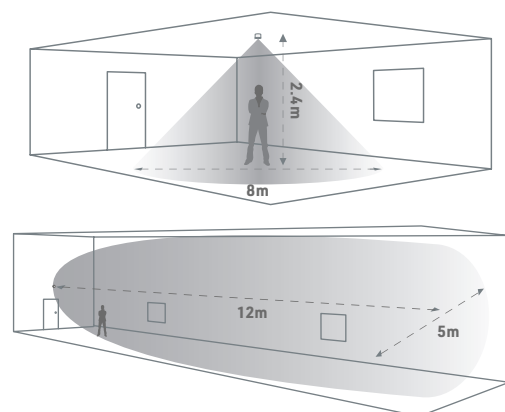

Dimensions (mm)

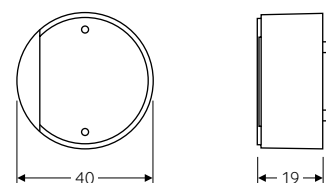

For power supply unit dimensions, please refer to the product installation guide on our website.

MWS6 | Compact, flush mounted detectors



The MWS6 is a low profile microwave presence/absence detector for the automatic control of lighting, heating and ventilation.

- Low profile design
- Self contained unit
- Pluggable
- IP40 rated
- Programme time delay and lux settings via infrared handset
- Available in a wide range of RAL colours
- 5 year warranty.

Available control methods

- PRM – Switching
- DD – DALI/DSI dimming
- AD – Analogue dimming
- KNX – See page 22

Special order variants

- LV – Low voltage
 - VFC – Voltage free contact
 - 2CH – 2 channel
- Additional variants available to special order – please see our website.

Detection pattern

high < sensitivity > low

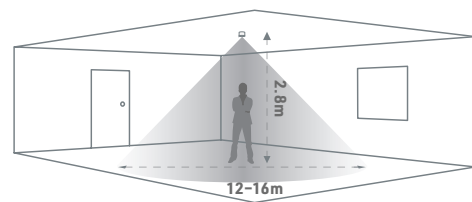

Dimensions (mm)

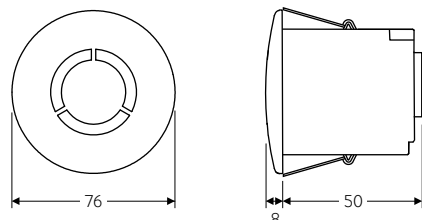

MWS6SM | Compact, surface mounted detectors



The MWS6SM is a surface mounted mid-range microwave presence/absence detector for the automatic control of lighting, heating and ventilation.

- Surface mounted
- IP40 rated
- Programme time delay and lux settings via infrared handset
- Self contained unit
- Easy to install via a back plate
- 5 year warranty.

Available control methods

- PRM – Switching
- DD – DALI/DSI dimming
- AD – Analogue dimming

Detection pattern

high < sensitivity > low

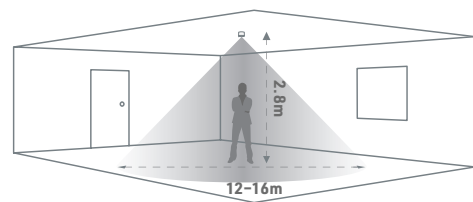

Dimensions (mm)

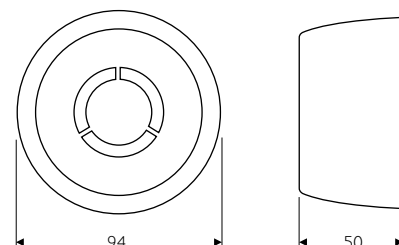

MWS1A | Low profile, back box mounted detectors



This discrete range of wall or ceiling mounted microwave presence detectors is designed to fit any single gang switch box.

- Presence detection
- Programme time delay and lux settings via infrared handset
- Suitable for heating and ventilation applications
- Compatible with European back boxes
- Fixing screw cap covers – smooth plate finish
- 5 year warranty.

Available control methods

- PRM – Switching

Special order variants

- LV – Low voltage
- VFC – Voltage free contact

Detection pattern

high < sensitivity > low

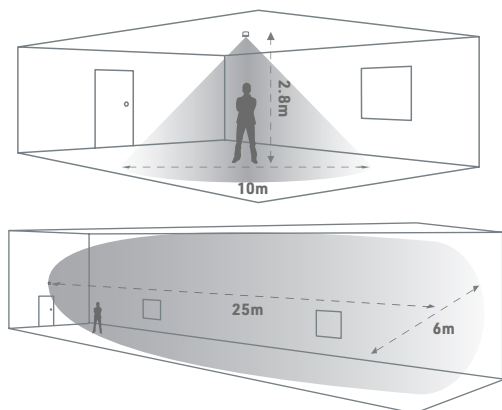

Dimensions (mm)

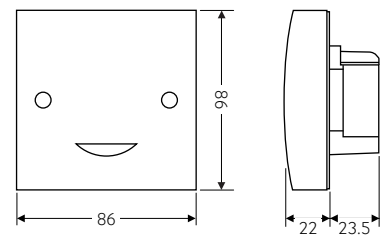

MWS1A-IP | Rugged, surface mounted detectors

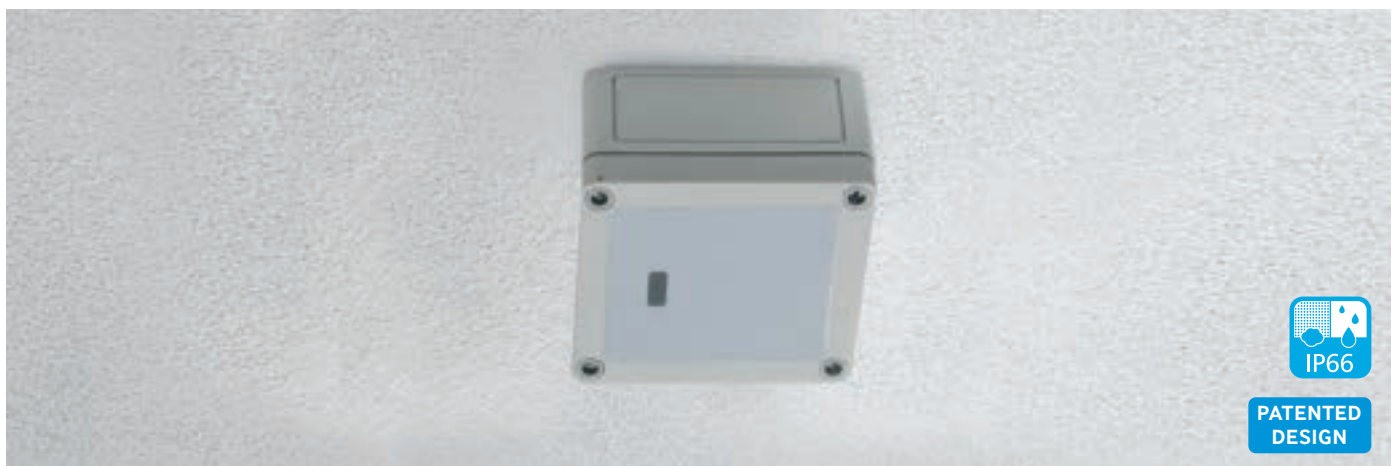

This rugged range of wall or ceiling mounted presence microwave detectors are rated IP66 – suitable for use in damp environments.

- Unobtrusive design – vandal resistant
- Programme time delay and lux settings via infrared handset
- Built in lux level sensing – enhanced energy saving
- Low voltage and volt free options – suitable for BMS and other control applications
- 5 year warranty.

Detection pattern

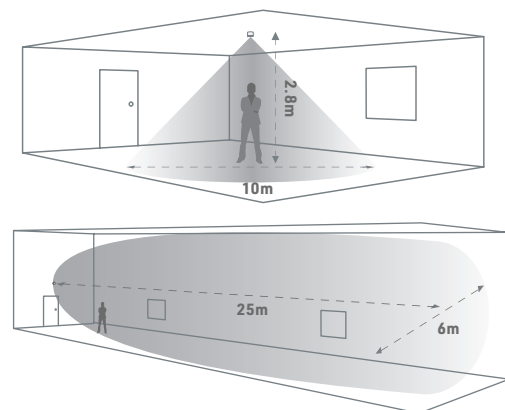

Available control methods

- PRM – Switching

Special order variants

- LV – Low voltage
- VFC – Volt free contact

Dimensions (mm)

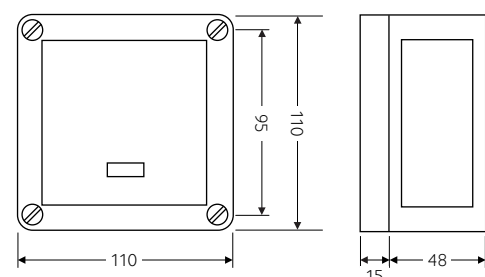

ALC | Compact, flush mounted switching and dimming photocells



The ALC dimming photocell automatically adjusts the light output of luminaires depending on the amount of natural light available, to a maintained illuminance level.

- Flush or surface mounted
- Adjustable preset levels for more control
- Programme time delay and lux settings via infrared handset
- Dimming version available to provide a maintained level of illuminance
- 5 year warranty.

Available control methods

- DD – DALI/DSI dimming
- AD – Analogue dimming

Dimensions (mm)

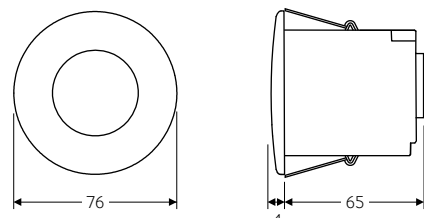

Low Temperature Detectors

Following rigorous testing in climatic chambers and on-site, our Minus30 range of lighting controls is specifically designed for the cold storage and refrigeration sector, performing down to aggressive -30° temperatures.



KNX Presence Detectors

CP Electronics brings its extensive functionality to KNX, the worldwide standard for unifying all communication between intelligent devices that light, heat and ventilate homes and buildings.

Key features:

- Presence detector, either PIR or microwave
- Absence detection
- Walk test LED
- Light level sensor
- Two ELV switch inputs
- User-configurable logic functions and timers.

Configuration of devices on the KNX bus takes place via the standard ETS software application, allowing all aspects of the presence detector's behavior to be configured and controlled.



Presence and absence detection explained

The choice between presence and absence detection for different spaces can make a big difference in user-friendliness and the amount of energy saved.

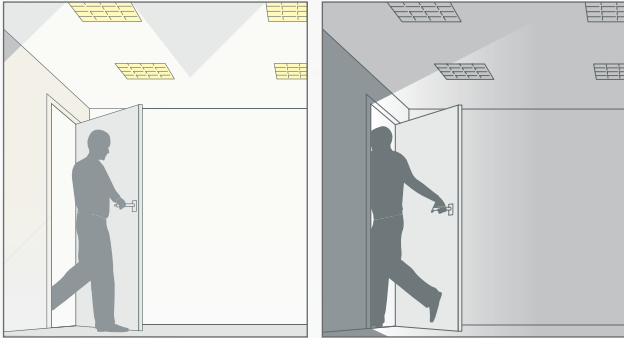

Presence Detection: Detectors will switch on lighting automatically when a person enters the room, and switches off lighting automatically when no movement is detected.

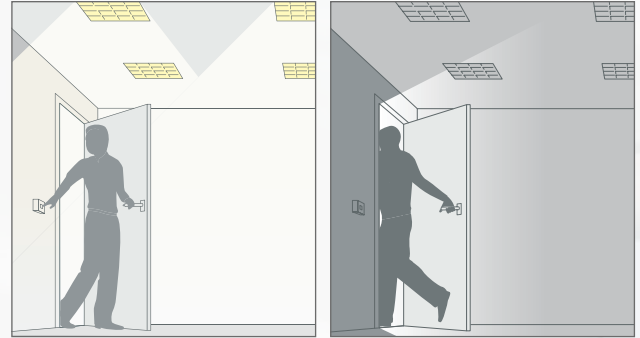

Absence Detection: Upon entering the room the person switches on the light as normal, but on leaving the detector switches off the lighting automatically. Lights can also be switched off manually.

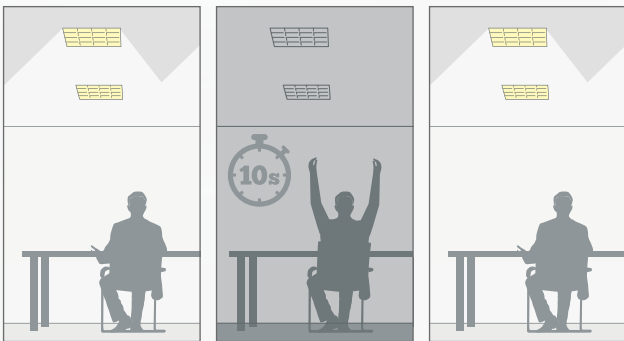

Absence Recovery: After an occupancy time out period has elapsed in absence mode, the unit temporarily enters a presence mode for 10 seconds allowing the occupants movement to bring the lights back on.

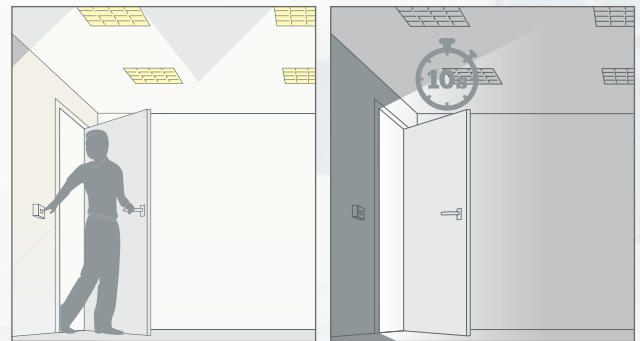

Switch Detection Time: This ensures that if a switch is activated and no movement is detected the lights will switch off after 10 seconds, minimising unnecessary lit space.

PIRs and microwave detectors compared

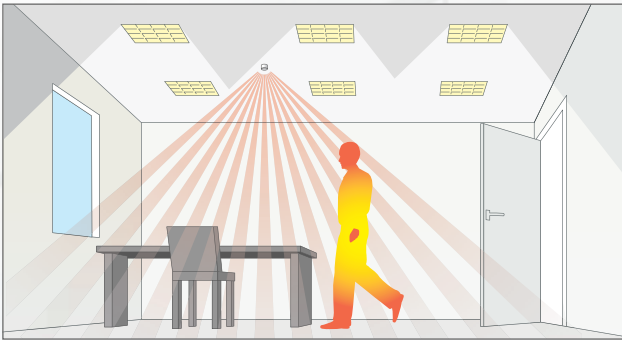

PIR (Passive Infrared) Detection: PIR detectors work on detecting the movement of body heat. They are better suited to smaller spaces or where a defined detection pattern is required.

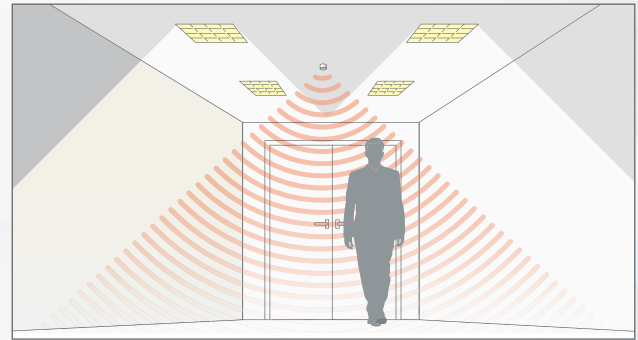

Microwave Detection: Microwave Detectors are sensitive to objects that move, with much greater coverage and sensitivity. They can detect through glass, therefore careful consideration on location is needed in certain applications.

Walk towards & walk across explained (PIR Detectors)

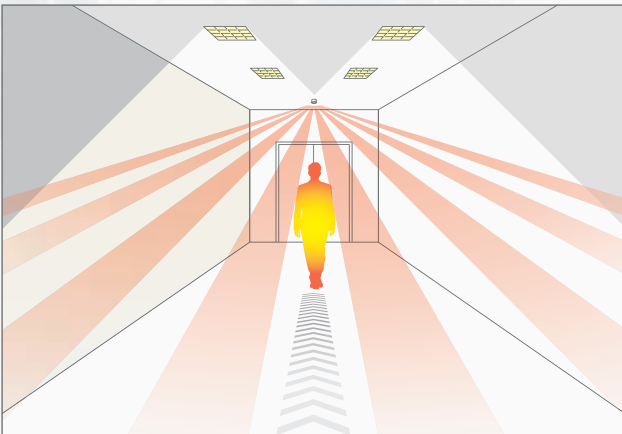

Walking towards the sensing area of a PIR detector may result in later detection as it is possible to walk towards the PIR sectors without crossing them (which is required for detection).



Walking across the detection area of a PIR detector results in a rapid detection because multiple sectors are crossed quickly triggering the detector.

PRM Detectors | Switching with lux level sensing

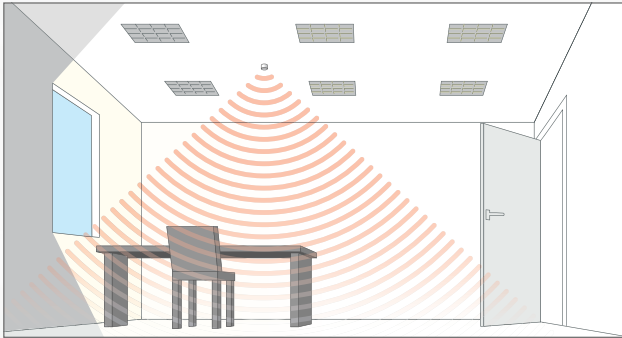

No presence detected, daylight, lights off.

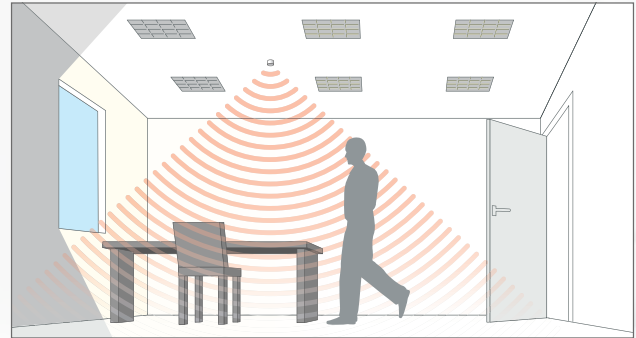

Presence detected, sufficient daylight, lights off.

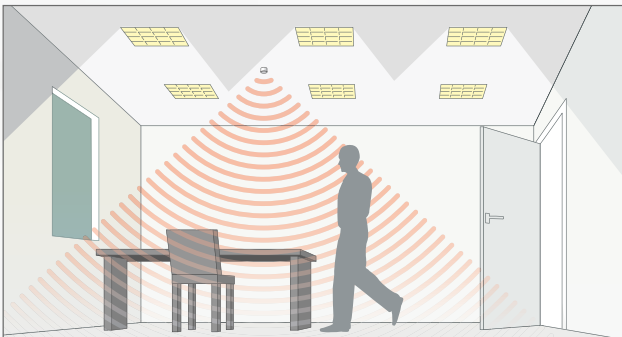

Presence detected, insufficient daylight, all lights on.

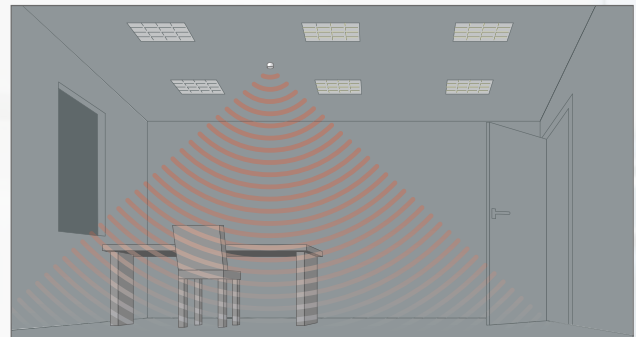

No presence detected, lights off.

These presence detectors have built-in adjustable lux sensors which will keep the lighting switched off if there is sufficient natural light.

Key features

- Switching with lux level sensing (infrared handset adjustment)
- Active photocell
- Time delay function
- Presence detection switching.
- Absence detection switching
- Programmable via Infrared handset
- Adjustable detection sensitivity
- On/off override via optional Infrared handset
- Manual on/off override via switch input.

DD & AD Detectors | Dimming with lux level sensing

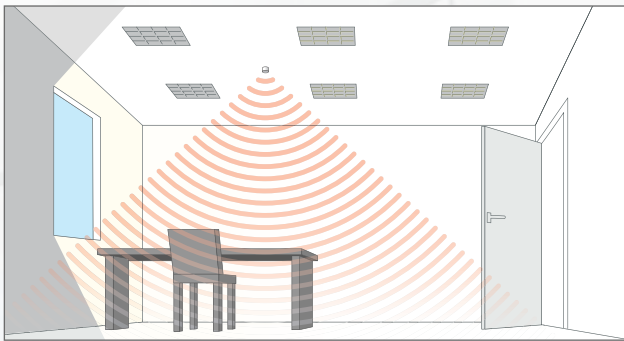

No presence detected, daylight, lights off.

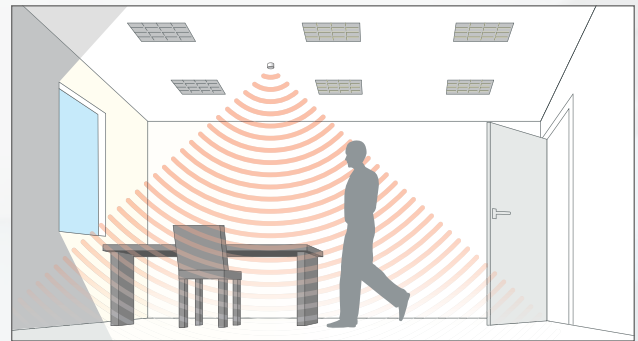

Presence detected, sufficient daylight, lights off.

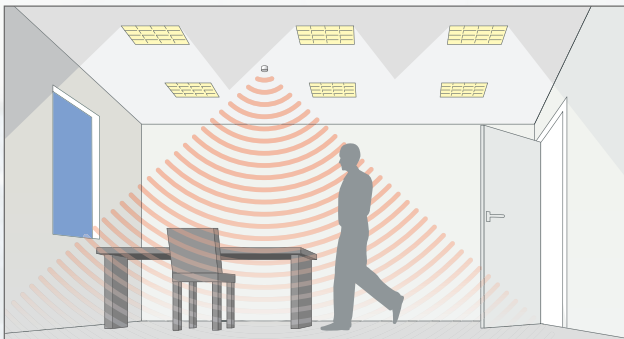

Presence detected, some daylight. Lights on and dimmed to maintain lux level.

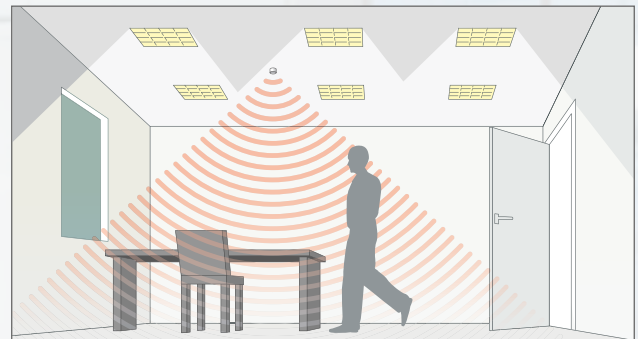

Presence detected, insufficient daylight. Detector measures and implements maintained illuminance.

These presence detectors have built-in adjustable lux sensors which will keep the lighting switched off if there is sufficient natural light.





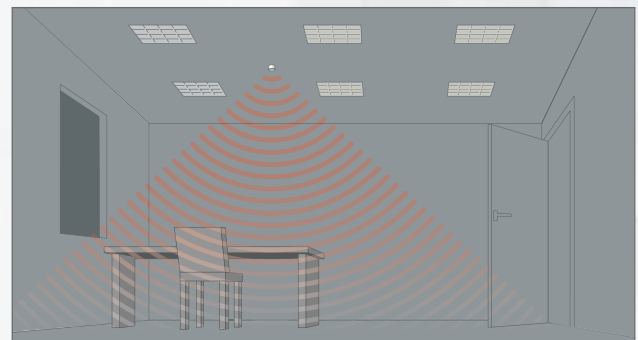

Key features (in addition to PRM detectors)

- Dimming functionality
- Two channel flexibility
- Step-down illuminance
- Maintained illuminance (daylight harvesting)
- Scene setting and recall
- Burn in feature for fluorescent tubes
- Control of DALI, DSI or 1–10V loads depending on product
- Integral relay to reduce parasitic power
- Suitable for all lighting types
- Manual dimming with infrared
- Manual dimming with switch inputs.



No presence detected, lights off.



Ceiling Mounted PIR Presence Detectors

Order Code	Description	PG
 EBDSPIR	Basic switching, compact, IP40, flush mounted, PIR, presence detector	5
EBDSPIR-VFC	Basic switching, compact, IP40, flush mounted, PIR, presence detector, volt free contact	
EBDSPIR-L3	Basic switching, compact, IP40, flush mounted, PIR, presence detector, c/w 3m lead	
EBDSPIR-IP	Basic switching, compact, IP55, flush mounted, PIR, presence detector	
EBDSPIR-AD	1–10V analogue dimming, compact, IP40, flush mounted, PIR, presence/absence detector,	
EBDSPIR-DD	DALI/DSI digital dimming, compact, IP40, flush mounted, PIR, presence/absence detector	
EBDSPIR-DD-LV	DALI/DSI digital dimming, compact, IP40, flush mounted, PIR, presence/absence detector, low voltage	
EBDSPIR-PRM	PRM switching, compact, IP40, flush mounted, PIR, presence/absence detector	
EBDSPIR-PRM-2CH	PRM switching, compact, IP40, flush mounted, PIR, presence/absence detector, 2-channel	
EBDSPIR-PRM-2CH-NC	PRM switching, compact, IP40, flush mounted, PIR, presence/absence detector, normally closed fail-safe contacts, 2-channel	
EBDSPIR-PRM-IP	PRM switching, compact, IP55, flush mounted, PIR, presence/absence detector	
EBDSPIR-PRM-L3	PRM switching, compact, IP40, flush mounted, PIR, presence/absence detector, c/w 3m lead	
EBDSPIR-PRM-LV	PRM switching, compact, IP40, flush mounted, PIR, presence/absence detector, low voltage	
EBDSPIR-PRM-VFC	PRM switching, compact, IP40, flush mounted, PIR, presence/absence detector, volt free contact	
 EBDSM-AD	1–10V analogue dimming, compact, IP54, surface mounted, PIR, presence/absence detector	6
EBDSM-DD	DALI/DSI digital dimming, compact, IP54, surface mounted, PIR, presence/absence detector	
EBDSM-PRM	PRM switching, compact, IP54, surface mounted, PIR, presence/absence detector	
 EBMHS-AD-SA-C	1–10V analogue dimming, miniature, IP40, flush/surface mounted, PIR, presence/absence detector, c/w pre-wired PSU	8
EBMHS-DD-SA-C	DALI/DSI digital dimming, miniature, IP40, flush/surface mounted, PIR, presence/absence detector, c/w pre-wired PSU	
EBMHS-PRM-SA-C	PRM switching, miniature, IP40, flush/surface mounted, PIR, presence/absence detector, c/w pre-wired PSU	
 EBMPIR-MB-AD	1–10V analogue dimming, miniature, retrofit, IP65, luminaire mounted, PIR, presence detector	9
EBMPIR-MB-DD	DALI/DSI digital dimming, miniature, retrofit, IP65, luminaire mounted, PIR, presence detector	
EBMPIR-MB-PRM	PRM switching, miniature, retrofit, IP65, luminaire mounted, PIR, presence detector	
EBMPIR-MB-PRM-110	PRM switching, miniature, retrofit, IP65, luminaire mounted, PIR, presence detector, 110V	
 EBDMR-PRM	PRM switching, compact, mid range, IP40, flush mounted, PIR, presence/absence detector	7
EBDMR-DD	DALI/DSI digital dimming, compact, mid range, IP40, flush mounted, PIR, presence/absence detector	
EBDMR-AD	1–10v analogue dimming, mid range, IP40, flush mounted, PIR, presence/absence detector	
 EBDRC-AD	1–10v analogue dimming, adjustable head, long range, IP40, flush mounted, PIR, presence/absence detector	10
EBDRC-DD	DALI/DSI digital dimming, adjustable head, long range, IP40, flush mounted, PIR, presence/absence detector	
EBDRC-PRM	PRM switching, adjustable head, long range, IP40, flush mounted, PIR, presence/absence detector	







Air Conditioning Controller

Order Code	Description	PG
 GESM-AC	Surface mount PIR AC controller	13



High Bay/High Level PIR Presence Detectors

Order Code	Description	PG
 EBDHS-AD	1–10v analogue dimming, IP65, high bay/high level, flush mounted, PIR, presence/absence detector	11
EBDHS-DD	DALI/DSI digital dimming, IP65, high bay/high level, flush mounted, PIR, presence/absence detector	
EBDHS-PRM	PRM switching, IP65, high bay/high level, flush mounted, PIR, presence/absence detector	
 EBDHS-MB-AD	1–10v analogue dimming, retrofit, IP65, high bay/high level, luminaire mounted, PIR, presence detector	12
EBDHS-MB-DD	DALI/DSI digital dimming, retrofit, IP65, high bay/high level, luminaire mounted, PIR, presence detector	
EBDHS-MB-PRM	PRM switching, retrofit, IP65, high bay/high level, luminaire mounted, PIR, presence detector	





Ceiling Mounted Microwave Presence Detectors

Order Code	Description	PG	
 MWS1A-C-IP-PRM	PRM switching, rugged, IP66, surface mounted, microwave, presence detector	19	
MWS1A-C-IP-PRM-LV	PRM switching, rugged, IP66, surface mounted, microwave, presence detector, low voltage		
MWS1A-C-IP-PRM-VFC	PRM switching, rugged, IP66, surface mounted, microwave, presence detector, volt free contacts		
 MWS1A-C-PRM	PRM switching, low profile, IP40, back box mounted, microwave, presence detector	18	
MWS1A-C-PRM-LV	PRM switching, low profile, IP40, back box mounted, microwave, presence detector, low voltage		
MWS1A-C-PRM-VFC	PRM switching, low profile, IP40, back box mounted, microwave, presence detector, volt free contacts		
 MWS3A-AD	1–10v analogue dimming, adjustable head, long range, IP40, flush mounted, microwave, presence/absence detector	14	
MWS3A-AD-LV	1–10v analogue dimming, adjustable head, long range, IP40, flush mounted, microwave, presence/absence detector, low voltage		
MWS3A-DD	DALI/DSI digital dimming, adjustable head, long range, IP40, flush mounted, microwave, presence/absence detector		
MWS3A-DD-LV	DALI/DSI digital dimming, adjustable head, long range, IP40, flush mounted, microwave, presence/absence detector, low voltage		
MWS3A-PRM	PRM switching, adjustable head, long range, IP40, flush mounted, microwave, presence/absence detector		
MWS3A-PRM-L3	PRM switching, adjustable head, long range, IP40, flush mounted, microwave, presence/absence detector, c/w 3m lead		
MWS3A-PRM-LV	PRM switching, adjustable head, long range, IP40, flush mounted, microwave, presence/absence detector, low voltage		
MWS3A-PRM-VFC	PRM switching, adjustable head, long range, IP40, flush mounted, microwave, presence/absence detector, volt free contact		
 MWS5-AD-SA-C	1–10v analogue dimming, miniature, IP40, flush mounted, microwave, presence/absence detector, c/w pre wired PSU		15
MWS5-DD-SA-C	DALI/DSI digital dimming, miniature, IP40, flush mounted, microwave, presence/absence detector, c/w pre wired PSU		
MWS5-PRM-SA-C	PRM switching, miniature, IP40, flush mounted, microwave, presence/absence detector, c/w pre wired PSU		
 MWS6-AD	1–10V analogue dimming, compact, IP40, flush mounted, microwave, presence/absence detector	16	
MWS6-DD	DALI/DSI digital dimming, compact, IP40, flush mounted, microwave, presence/absence detector		
MWS6-PRM	PRM switching, compact, IP40, flush mounted, microwave, presence/absence detector		
MWS6-PRM-2CH	PRM switching, compact, IP40, flush mounted, microwave, presence/absence detector, 2-channel		
MWS6-PRM-LV	PRM switching, compact, IP40, flush mounted, microwave, presence/absence detector, low voltage		
MWS6-PRM-VFC	PRM switching, compact, IP40, flush mounted, microwave, presence/absence detector, volt free contacts		
 MWS6SM-AD	1–10v analogue dimming, IP40, surface mounted, microwave, presence/absence detector	17	
MWS6SM-DD	DALI/DSI digital dimming, IP40, surface mounted, microwave, presence/absence detector		
MWS6SM-PRM	PRM switching, IP40, surface mounted, microwave, presence/absence detector		





Wall Mounted Microwave Presence Detectors

Order Code	Description	PG
 MWS1A-IP-PRM	PRM switching, rugged, IP66, wall, surface mounted, microwave, presence detector	19
MWS1A-IP-PRM-LV	PRM switching, rugged, IP66, wall, surface mounted, microwave, presence detector, low voltage	
MWS1A-IP-PRM-VFC	PRM switching, rugged, IP66, wall, surface mounted, microwave, presence detector, volt free contacts	
 MWS1A-PRM	PRM switching, long range, IP40, wall, back box mounted, microwave, presence detector	18
MWS1A-PRM-LV	PRM switching, long range, IP40, wall, back box mounted, microwave, presence detector, low voltage	
MWS1A-PRM-VFC	PRM switching, long range, IP40, wall, back box mounted, microwave, presence detector, volt free contact	

Minus30 Low Temperature Detector Range

Order Code	Description	PG
 EBDHS-AD-LT30	1–10v analogue dimming, low temp, IP65, high bay/high level, flush mounted, PIR, presence/absence detector	11
EBDHS-DD-LT30	DALI/DSI digital dimming, low temp, IP65, high bay/high level, flush mounted, PIR, presence/absence detector	
EBDHS-PRM-LT30	PRM switching, low temp, IP65, high bay/high level, flush mounted, PIR, presence/absence detector	
 EBDHS-MB-AD-LT30	1–10v analogue dimming, retrofit, low temp, IP65, high bay/high level, luminaire mounted, PIR, presence detector	12
EBDHS-MB-DD-LT30	DALI/DSI digital dimming, retrofit, low temp, IP65, high bay/high level, luminaire mounted, PIR, presence detector	
EBDHS-MB-PRM-LT30	PRM switching, retrofit, low temp, IP65, high bay/high level, luminaire mounted, PIR, presence detector	
 EBDSPIR-AD-IP-LT30	1–10V analogue dimming, compact, low temp, IP55, flush mounted, PIR, presence/absence detector	5
EBDSPIR-DD-IP-LT30	DALI/DSI digital dimming, compact, low temp, IP55, flush mounted, PIR, presence/absence detector	
EBDSPIR-PRM-IP-LT30	PRM switching, compact, low temp, IP55, flush mounted, PIR, presence/absence detector	
 EBMPIR-MB-AD-LT30	1–10V analogue dimming, miniature, retrofit, low temp, IP65, luminaire mounted, PIR, presence detector	9
EBMPIR-MB-DD-LT30	DALI/DSI digital dimming, miniature, retrofit, low temp, IP65, luminaire mounted, PIR, presence detector	
EBMPIR-MB-PRM-LT30	PRM switching, miniature, retrofit, low temp, IP65, luminaire mounted, PIR, presence detector	



KNX Presence Detectors

Order Code	Description	PG
 EBDHS-KNX	KNX, IP65, high bay/high level, flush mounted, PIR, presence/absence detector	11
 EBDSPIR-KNX	KNX, compact, IP40, flush mounted, PIR, presence/absence detector	5
 MWS3A-KNX	KNX, adjustable head, long range, IP40, flush mounted, microwave, presence/absence detector	14
 MWS6-KNX	KNX, compact, IP40, flush mounted, microwave, presence/absence detector	16



Light Level Controls

Order Code	Description	PG
 ALC-PRM-VFC	Compact, IP40, flush mounted, photocell switch, PRM switching, volt free contacts	20
ALC-DD	Compact, IP40, flush mounted, photocell switch, DALI/DSI digital dimming	
ALC-AD	Compact, IP40, flush mounted, photocell switch, 1–10V analogue dimming	

Infrared Handsets

Order Code	Description	PG
 UHS5	Compact, programming/commissioning handset	4
 UHS7	Compact, user handset	4
 UNLCDHS	Professional, programming/commissioning LCD handset	4

Accessories

Order Code	Description
 DBB	Surface mount back box, white*
 MWS3A-DBB	MWS3A Surface mount back box BESA fixing, white*
 DBB-EXT	Surface mount back box extender BESA fixing, white*
 MWS3A-DBB-EXT	MWS3A Surface mount back box extender BESA fixing, white**
 EBDHS-DBB-WBRKT	EBDHS Wall mount bracket, white*
 MWS3A-DBB-WBRKT	MWS3A Wall mount bracket, white**
 EBD-ENCIP1	IP65 detector enclosure, grey*
 EXD-HSC	Extended wiring compartment for use with flush mounted detectors, white*
 EBDSPIR-MS	Adhesive masking shields (pack of 10), white
 EBDHS-MS	Masking shields
MWS3A-VPPC	Wall mount protective cover for use with wall mount bracket, clear

*Compatible with EBDSPIR, EBDHS, ALC, MWS6 and EBDMR presence detectors.

** Also suitable for EBDRC.

Terms & Conditions

These General Conditions of Sale shall apply to and form part of every Contract. All orders are accepted and executed on the understanding that the Purchaser is bound by these General Conditions of Sale which shall govern the Contract to the exclusion of any other terms and conditions subject to which any such order is accepted or purported to be accepted, or any such order is made or purported to be made, by the Purchaser.

No Contract shall come into being unless and until the Purchaser has accepted these General Conditions of Sale either expressly or by implication.

The Purchaser shall ensure that under all reasonably foreseeable conditions the goods are NOT supplied or made available to consumers for Do It Yourself purposes. The goods are for professional use only – see section 14 SAFETY

1. Definitions

Company - means Legrand Electric Ltd and/or each of its subsidiary companies and/or their divisions as appropriate.

Conditions - means the terms and conditions set out herein and includes any special terms and conditions agreed in writing between the Company and the Purchaser.

Contract - means the contract between the Company and the Purchaser for the sale and purchase of the Goods in accordance with these General Conditions of Sale.

Purchaser - means the person, firm or body corporate which buys or has agreed to buy the goods. Goods - means any item of whatsoever nature (including any part or parts of them) which is to be sold or supplied by the Company including services.

Invoice - means the document sent to the Purchaser whether verbally or in writing by the Company in demand of payment for the Goods.

Order - means an order placed by a Purchaser and accepted by the Company.

Premises - means Brent Crescent, London NW10 7XR.

Specification - means any specification whether written or oral, drawings, designs or instructions furnished by the Purchaser to the Company.

2. Orders and Specifications

2.1 Each Order shall constitute a separate Contract between the Company and the Purchaser.

2.2 The Purchaser shall be responsible for ensuring the accuracy of the terms of any Order or Specification.

2.3 The Company's employees or agents are not authorised to make any representations concerning the Goods unless confirmed in writing by the Company.

2.4 The quantity and description of the Goods shall be as set out either in the Order or in the case where a quotation is given by the Company in the quotation. No other descriptive material, written or oral including promotional or sales literature, shall be incorporated into the Order or quotation.

2.5 The Company reserves the right to make any changes to the Goods which are required to conform with any applicable statutory or EU requirements.

2.6 Any typographical or other error in any document issued by the Company shall be subject to correction without any liability on the part of the Company.

3. Price and Payment

3.1 The price of the Goods shall be the Company's quoted price or where no price has been quoted for the quoted price (to change valid) the price listed in the Company's price list current at the date of the Order and in any case as shown on the Invoice.

3.2 Where the value of any Order exceeds £275 net, the cost of delivery of the goods to the Purchaser's premises on the mainland of Great Britain shall be included in the Contract price. A Purchaser requiring delivery to a non-mainland destination should contact the Company to obtain details of carriage costs.

3.3 Any Orders below £275 net will attract a £20 minimum order charge.

3.4 The Company reserves the right by giving written notice to the Purchaser at any time before delivery to alter the price of the Goods where such alteration is due to any factor beyond the control of the Company (such as, without limitation, any foreign exchange fluctuation, alteration of duties) any changes in delivery dates or quantities requested by the Purchaser or any delay caused by any instructions of the Purchaser.

3.5 All prices and charges are exclusive of VAT and any other applicable taxes, rates, governmental levies or duty.

3.6 The Company may invoice the Purchaser on or at any time after the Company's acceptance of an order. All prices and charges shall be due on or before the last working day of the month following the date of the Invoice. Time shall be of the essence in respect of payment of all prices and charges.

3.7 If the Purchaser fails to make any payment on the due date then, without limiting any other right or remedy available to the Company, the Company may:

3.7.1 cancel the Order or suspend any further deliveries to the Purchaser;

3.7.2 appropriate any payment made by the Purchaser to such of the Goods as the Company may deem fit (notwithstanding any purported appropriation by the Purchaser); and

3.7.3 charge interest on sums more than 7 days overdue on a daily basis (as well as before and after judgement) at a rate of 5% per annum compounded quarterly and payable on demand.

4. Delivery and Acceptance

4.1 Delivery shall be made by the Company delivering the Goods to the delivery address set out in the delivery note. Purchasers wishing to arrange collection of the Goods at the Premises can do so by prior agreement only. In all cases a correctly issued collection reference prefix must be obtained from the Company's Credit Control Department.

4.2 Any dates quoted for delivery are approximate only and the Company shall not be liable for any delay however caused. The Company may by written notice given to the Purchaser reschedule its delivery dates without liability.

4.3 If the Purchaser fails to take delivery or fails to give the Company adequate delivery instructions, without prejudice to any other right or remedy available to the Company, the Company may store the Goods until actual delivery and charge the Purchaser for any reasonable costs (including insurance) of storage. In such circumstances delivery is deemed to have taken place in the case of Goods delivered at the Premises on the date upon which the Company notified the Purchaser that the Goods were ready for collection and in the case of Goods delivered otherwise than at the Premises on the date upon which delivery was tendered by the Company.

4.4 Any claim by the Purchaser for short delivery must be notified to the Company in writing within seven days of delivery. The Company reserves the right to charge £30 where a claim for alleged shortage is received but on investigation the goods are shown to have been correctly delivered.

4.5 Failure by the Company to deliver one or more instalments of an Order in accordance with the Conditions shall not entitle the Purchaser to treat the Contract as a whole as repudiated.

4.6 If the Company fails to deliver the Goods for any reason other than any cause beyond the Company's reasonable control or the Purchaser's fault, the Company's liability shall be limited to the excess (if any) of the cost to the Purchaser (in the cheapest available market) of similar Goods.

4.7 The Purchaser shall be deemed to have accepted the Goods upon delivery.

5. Returns

5.1 Goods may not be returned unless a Returned Material Authorisation RMA number has been issued by the Company. Goods accepted for return are subject to a handling charge of 50% of the price of the Goods (exclusive of VAT), such charge to be paid on negotiation for settlement of the claim. The Company will bear the cost of any payment made in settlement of or as a result of an award in a judgement against the Purchaser.

5.2 All costs of returning the Goods to the Company shall be borne by the Purchaser. Goods are returned at the risk of the Purchaser and any repairs undertaken by the Company in respect of damage caused in transit during their return will be charged to the Purchaser. All returned Goods must be accompanied by the original packing note and a copy of the RMA together with details of the reason for return.

5.3 Any Goods in which title has passed to the Purchaser and which are returned to the Company shall become the property of the Company.

5.4 Luminaires and patch cords are not returnable under any circumstances.

5.5 All Goods returned must be the current version of the product within warranty and must be in good salable condition. Where Goods are returned outside these criteria the Purchaser will be advised accordingly. Within 14 days of such notification the Purchaser shall arrange for collection of the goods from the Premises. If the Purchaser fails to arrange for collection of the Goods within 14 days of such notification the Company will be entitled to dispose of the Goods.

5.6 Any non-standard labelled or packaged product cannot be returned.

6. Title and Risk

6.1 Title shall pass to the Purchaser on payment in full of the price of the Goods and of any other sums due and payable by the Purchaser at any time.

6.2 The Company shall be entitled to recover the price and any other sums notwithstanding that title in the Goods has not passed to the Purchaser.

6.3 Until such time as the property in the Goods passes to the Purchaser, the Purchaser shall hold the Goods as the Company's fiduciary agent and bailee, and shall keep the Goods separate from those of the Purchaser

and third parties and properly stored, protected and insured and identified as the Company's property, but shall be entitled to resell or use the goods in the ordinary course of its business. If the Purchaser resells the goods it does so as principal and not as the Company's agent and property to the Goods shall pass from the Company to the Purchaser immediately before the time at which resale by the Purchaser occurs.

6.4 Until such time as the property in the Goods passes to the Purchaser (and provided the Goods are still in existence and have not been resold), the Company shall be entitled at any time to require the Purchaser to deliver up the Goods to the Company and, if the Purchaser fails to do so forthwith, to enter upon any premises of the Purchaser or any third party where the Goods are stored and repossess the Goods.

6.5 The Purchaser shall not be entitled to pledge or in any way charge by way of security for any indebtedness any of the Goods which remain the property of the Company, but if the Purchaser does so all money owing by the Purchaser to the Company shall (without prejudice to any other rights or remedy of the Company) forthwith become due and payable.

6.6 Risk of damage to or loss of the Goods shall pass to the Purchaser, in the case of Goods delivered at the Premises at the time when the Company notifies the Purchaser that the Goods are available for collection or, in the case of Goods to be delivered otherwise than at the Premises at the time of delivery.

7. Warranty

7.1 The Company warrants that on delivery, and for a period of 5 years from the date of delivery (warranty period) the Goods shall:

7.1.1 conform in all material respects with any applicable specification agreed by both parties in writing in advance;

7.1.2 be free from material defects in design, material and workmanship; and

7.1.3 be of satisfactory quality (within the meaning of the Sale of Goods Act 1979).

7.2 Subject to clause 7.3 if:

7.2.1 the Purchaser gives notice in writing to the Company during the warranty period within a reasonable time of discovery that some or all of the Goods do not comply with the warranty set out in clause 7.1;

7.2.2 the Company is given a reasonable opportunity of examining such Goods; and

7.2.3 the Purchaser (if asked to do so by the Company) returns such Goods to the Company's place of business at the Purchaser's cost, the Company shall, at its option, repair or replace the defective Goods, or refund the price of the defective Goods in full.

7.3 The warranty given in Clause 7.1 is subject to the following provisos, namely:

7.3.1 that the defects shall not have arisen through fair wear and tear, willful damage, negligence, abnormal working conditions, misuse, alteration or repair of Goods by the Purchaser without the Company's approval;

7.3.2 that the Purchaser shall have followed all instructions issued by the Company in relation to the Goods;

7.3.3 that in the case of defects which should have been reasonably apparent to the Purchaser on reasonable examination of the Goods on delivery, the Purchaser shall notify the Company of the defects in writing within 14 working days of delivery;

7.3.4 that in the case of any other defects, the Purchaser shall notify the Company of the defects in writing within 7 working days of the date when the defect becomes apparent and the Purchaser shall not make use of such Goods after giving notice;

7.3.5 that when in discharge of its obligations under the warranty given in this Clause the Company agrees that the Purchaser may undertake any repair or remedial work on its behalf, the cost of such work shall be agreed in writing between the Purchaser and the Company before the commencement of any such repair or remedial work.

7.4 The terms implied by sections 13 to 15 of the Sale of Goods Act 1979 are, to the fullest extent permitted by law, excluded from the Contract.

7.5 Clause 7.1 to Clause 7.4 shall apply to any repaired or replacement Goods supplied by the Company except that in the case of repaired Goods, the 5 year period referred to in Clause 7.1 shall be replaced by the unexpired period of the warranty.

7.6 The Company shall have no liability for defects in the Goods arising or resulting from parts, materials, or equipment not manufactured by the Company in respect of which the Purchaser shall only be entitled to the benefit of any such warranty or guarantee as is given by the manufacturer to the Company.

7.7 The Company shall at its sole discretion be entitled to supply an advance replacement of the defective Goods. For the avoidance of doubt it is confirmed that the Company has no obligation to supply an advance replacement of the defective Goods. In the event that an advance replacement is supplied and the Goods are not defective the Purchaser shall be liable to pay the price of both the advance replacement and the Goods.

8. Intellectual Property Rights

8.1 Subject to clause 8.2 in the event that any claim is made against the Purchaser for infringement of intellectual property rights arising directly from the use or sale by the Purchaser of the Goods, the Company at its own expense shall conduct any ensuing litigation and all negotiations for settlement of the claim. The Company will bear the cost of any payment made in settlement of or as a result of an award in a judgement against the Purchaser.

8.2 The Purchaser shall give to the Company at the earliest possible opportunity notice in writing of any claim being made or action threatened or brought against it, shall make no admission of liability or take any other action in connection therewith, shall permit the Company to have conduct of the claim pursuant to clause 8.1 and shall (at the Company's expense) give all reasonable information, co-operation and assistance to the Company including without limitation lending its name to proceedings in relation to the conduct of the claim. If it is made a condition of any settlement made by the Company of any judgement awarded against the Purchaser pursuant to clause 8.1, the Purchaser shall return or destroy as applicable all infringing Goods still under its control subject to a refund by the Company of any payment for such Goods already made less a reasonable allowance of a depreciation of the Goods by reason of their use (if any) by the Purchaser prior to their return or destruction aforesaid.

8.3 The provisions of clause 8.1 shall not apply to any infringement caused by the Company having followed a Specification nor to any use of the Goods in a manner or for a purpose which shall have been specifically prohibited in writing by the Company nor to any infringement which is due to the use of the Goods in association or combination with any other product.

8.4 If the Goods are to be manufactured or any process is to be applied to the Goods by the Company in accordance with a Specification the Purchaser shall indemnify the Company against all loss, damages, costs and expenses awarded against or incurred by the Company in connection with, or paid or agreed to be paid by the Company in settlement of any claim for infringement of any intellectual property rights whatsoever which results from the Company's use of the Specification.

8.5 With respect to the Goods, the Purchaser agrees and acknowledges 8.5.1 that all copyright and other intellectual property rights (including but not limited to, patent, copyright, trademark, registered design or other industrial property right) in and relating to the Goods supplied by the Company is the property of the Company (or its supplier as applicable) and the Purchaser agrees that it will not carry out or authorise or procure the carrying out of any act that might infringe such copyright or other intellectual property (including reproducing or authorising or procuring the reproduction of however any item supplied by the Company under or by virtue of any order or contract) and 8.5.2 that it is authorised to use and install the Goods owned by it only for the purpose defined in the order or contract and for no other purpose whatsoever and 8.5.3 will take all reasonable precautions to ensure that no unauthorised person may take or copy from the Goods any intellectual property rights or technical specifications or copy thereof and that all persons who have access to the Goods are made aware of the provision of this paragraph.

9. Liability

9.1 Nothing in these General Conditions of Sale shall limit or exclude the Company's liability for (i) death or personal injury caused by its negligence, or the negligence of its employees, agents or subcontractors; (ii) fraud or fraudulent misrepresentation; or (iii) any other matter in respect of which it would be unlawful for the Company to exclude or restrict liability.

9.2 LIMITATION OF LIABILITY. SUBJECT TO CLAUSE 9.1

9.2.1 THE COMPANY SHALL UNDER NO CIRCUMSTANCES WHATSOEVER BE LIABLE TO THE PURCHASER, WHETHER IN CONTRACT, TORT (INCLUDING NEGLIGENCE), BREACH OF STATUTORY DUTY, OR OTHERWISE, FOR ANY LOSS OF PROFIT OR ANY INDIRECT OR CONSEQUENTIAL LOSS ARISING UNDER OR IN CONNECTION WITH THE CONTRACT; AND

9.2.2 THE COMPANY'S TOTAL LIABILITY TO THE PURCHASER IN RESPECT OF ALL OTHER LOSSES ARISING UNDER OR IN CONNECTION WITH THE CONTRACT, WHETHER IN CONTRACT, TORT (INCLUDING NEGLIGENCE), BREACH OF STATUTORY DUTY, OR OTHERWISE, SHALL IN NO CIRCUMSTANCES EXCEED THE PRICE OF THE GOODS.

10. Force Majeure

Neither party shall be deemed to be in breach of these Conditions or otherwise liable to the other for any delay in performance or any non-performance of any obligations hereunder (and the time for performance shall be extended accordingly) if and to the extent that the delay or non-performance is due to an event or circumstance beyond the reasonable control of that party.

11. Insolvency of Purchaser and Termination

11.1 This clause applies if:

11.1.1 the Purchaser becomes insolvent or makes any voluntary arrangement with its creditors or becomes subject to an administration order or (being an individual or firm) becomes bankrupt or (being a Company) goes into liquidation (otherwise than for the purposes of amalgamation or reconstruction); or

11.1.2 an enforcement receiver takes possession, or a receiver or administrative receiver is appointed, of any of the property or assets of the Purchaser; or

11.1.3 the Purchaser ceases, or threatens to cease, to carry on business; or

11.1.4 the Company reasonably apprehends that any of the events mentioned above is about to occur in relation to the Purchaser and notifies the Purchaser accordingly.

11.2 If this clause applies then, without prejudice to any other right or remedy available to the Company, the Company shall be entitled to terminate the Contract or suspend any further deliveries under the Contract without any liability to the Purchaser, and if the goods have been delivered but not paid for, the price shall become immediately due and payable notwithstanding any previous agreement or arrangement to the contrary.

11.3 If this clause applies then the Purchaser shall have a duty to immediately bring to the notice of any receiver, administrator or any such person or persons appointed, the existence of and content of Clause 6 of these General Conditions of Sale (Title and Risk) and the rights of the Purchaser to use or trade on the Company's goods is immediately terminated and any such receiver, administrator or other person or persons appointed will not be entitled to use or to trade in the Company's goods unless so authorised in writing by the Company.

11.4 On termination of the Contract for any reason the Purchaser shall immediately pay to the Company all of the Company's outstanding unpaid invoices and interest.

11.5 Termination of the Contract shall not affect any of the parties' rights and remedies that have accrued as at termination including the right to claim damages in respect of any breach of this Contract that existed at or before the date of termination.

11.6 Any provision of the Contract that expressly or by implication is intended to come into or continue in force on or after termination shall remain in full force and effect.

12. Assignment

The Agreement is personal to the Purchaser and may not be assigned or otherwise transferred without the written consent of the Company.

13. Waiver

No forbearance, delay or indulgence by the Company in enforcing the provisions herein shall prejudice or restrict its rights nor shall any waiver of its rights operate as a waiver of any subsequent breach and no right or remedy herein conferred upon or reserved for the Company is exclusive of any other right, power or remedy available to it and each such right, power or remedy shall be cumulative.

14. Safety

The Purchaser shall ensure that the Goods are installed, commissioned and maintained by suitably qualified personnel and where applicable in accordance with the latest edition of the ET Wiring Regulations (BS 7671), the Health and Safety at Work Act 1974, Electricity at Work Regulations 1989 and any other Code of Practice or statutory requirement which may be in force from time to time, and in accordance with accepted practice in the industry. Any information which is required about the potential use or installation of the Goods is available on request and the Purchaser must comply with any such information given. In accordance with the provisions of the Health and Safety at Work Act 1974 the Purchaser must make available any such information to any other concerned.

15. Compliance

The Purchaser acknowledges that he is acquainted with and adheres to Legrand's sustainable development and business ethics requirements, as set out in the Charter of Fundamental Principles, in the Guide to Good Business Practices and in the Charter for Fair Competition, which is available on the Legrand Group's Website - <http://www.legrandgroup.com/EN/>

The Purchaser undertakes to comply with the Legrand Group sustainable development policy especially regarding environmental protection, compliance with social and labour applicable rules and policies, occupational health and safety of its employees, ethical conduct in business relationship and more specifically prevention of corruption and compliance with competition rules.

In terms of prevention of corruption, Legrand expects the Purchaser to reject corruption in all its forms, whether public and private, active or passive. To this end, the Purchaser undertakes to comply with all applicable national and international laws and regulations relating to the prevention of corruption of each country he is established in and/or he operates in.

In terms of competition law, Legrand expects the Purchaser to reject every unfair or anti-competitive practice and to demonstrate a law-abiding behaviour towards its competitors, its customers and its suppliers. To this end, the Purchaser undertakes to comply with all applicable national and international laws and regulations relating to fair competition of each country he is established in and/or he operates in.

The Purchaser undertakes to observe and to implement within its group principles of good business practices equivalent to those described in the Fair Competition Charter of the Legrand Group especially concerning prohibited vertical agreements, abuse of market power or exchanging of privileged information with competitors. The Purchaser undertakes to comply with all laws and regulations on embargoes, economic, commercial or financial sanctions or restrictive measures applied by the United States, the European Union or any other applicable national legislation ('embargoes') and to obtain all licences, shipping documents and authorisations required for the resale, export or re-export of Legrand Group products.

Accordingly, the Purchaser agrees not to:

- export or re-export the Goods to a country which is prohibited or subject to restrictions, without having obtained all necessary authorisations from the French, European or American authorities or those of any other country that imposes restrictions;

- restrict the Goods to persons, organisations or entities subject to sanctions by France, the European Union or any other country; or to persons, organisations or entities about which there are reasons to believe that they fail to comply fully with the national or international regulations in force;

- export or re-export the Goods for the purpose of using them in sectors that are prohibited or subject to restrictions by the law and embargo regulations;

- issue or collect any financial flows without having previously notified and/or obtained the necessary authorisations from the competent authorities;

The Purchaser is responsible for obtaining all authorisations or licences as required by the export regulations and guarantees to hold the Company not liable in regard to any recourse pertaining thereto. The Company may suspend its obligations and the Purchaser's rights until such time as the authorisations and guarantees

have been granted or for the period of such restrictions or prohibitions. In all events, the Company shall be able to cancel the Order without thereby giving rise to any liability whatsoever with regard to the Purchaser or end-user.

16. Confidentiality

Both the Company and the Purchaser shall keep confidential and shall not disclose without the prior written consent of the other any technical and commercial information acquired as a result of any communications between them relating to the Contract or the Goods.

17. Communications

17.1 All communications between the parties in respect of the Contract must be in writing and delivered by hand or sent by pre-paid first class post or e-mail (with a hard copy by post).

17.2 In case of communications to the Company to its registered office in the case otherwise notified to the Purchaser by the Company, and in the case of communications to the Purchaser to its registered office (if a company) or to its address as set out in the Contract unless otherwise notified to the Company by the Purchaser.

17.3 Communications shall be deemed to have been received if sent by pre-paid first class post, two working days (i.e. excluding Saturdays, Sundays and bank and other UK public holidays) after posting or if delivered by hand, on the day of delivery.

18. Entire Agreement

18.1 These Conditions constitute the entire and only agreement between the parties and supersede any and all prior proposals, agreements negotiations and discussions between the parties.

18.2 The Purchaser acknowledges that in entering into the Contract it does not do so on the basis of and does not rely on any representation, warranty or other provision except as expressly herein provided and all conditions, warranties or other terms implied by statute or common law are hereby excluded to the fullest extent permitted by law.

19. Partial Invalidity

If any provision herein proves to be legally invalid this shall not affect the validity of the remaining provisions hereof which shall continue in full force and effect.

20. Variation

These Conditions may not be varied or amended unless such variations or amendments are agreed in writing by both parties.

21. General

21.1 Any reference to any statute or statutory provision includes a reference to that statute or that statutory provision as from time to time amended, extended or re-enacted.

21.2 Any reference to a party includes a reference to its successors in title and permitted assigns.

22. Law

All contracts to which these General Conditions of Sale apply, and any dispute or claim (including non-contractual disputes or claims) arising out of or in connection with it or its subject matter or formation shall be governed by the laws of England and the parties hereby irrevocably agree to submit to the exclusive jurisdiction of the English Courts.



CP Electronics
A brand of  **legrand**

Brent Crescent,
London NW10 7XR, UK

+44 (0)333 900 0671
info@cpelectronics.co.uk
www.cpelectronics.co.uk

connect with us
    