

## EX-KEM 20/25

Ex-enlargement adaptor, polyamide, M20-M25

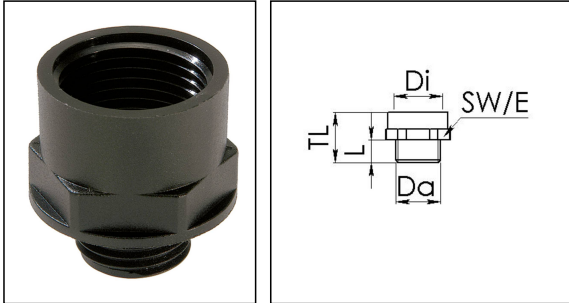

Products may differ in size, colour and appearance to those shown. If you require further information or customisation, please contact us directly.



Material	Polyamide, fibre reinforced
Material sealing gasket	EPDM
Temp. range min	-40 °C
Temp. range max	75 °C
Protection class	IP66 / IP68 (5 bar 30 min)
Type of protection	Ex eb, Ex tb
Ex-Certificate	IECEx, ATEX
Thread type outer	M
Ø outer thread	20
Lead outer	1,5
Length screw-in thread L	9 mm
Thread type inner	M
Ø inner thread	25
Lead inner	1,5
Length internal thread	15,5 mm
Key width SW	29 mm
Collar diameter (E)	32 mm
Total length TL	27 mm
Form	A
Product Color	RAL 9005
Equipment	Incl. connection thread gasket
Order no. RAL 9005	10064743
Type	EX-KEM 20/25
Packing unit	100
ETIM-Classification	EC000938

Your Contact:

WISKA Hoppmann GmbH

Kisdorfer Weg 28 · 24568 Kaltenkirchen · Germany

☎ +49-4191-508-0 · 📠 +49-4191-508-209

contact@wiska.de · www.wiska.com

**Recommended accessories**

**EMUG 20**

10061782

14.01.2021

Your Contact:

**WISKA Hoppmann GmbH**

Kisdorfer Weg 28 · 24568 Kaltenkirchen · Germany

☎ +49-4191-508-0 · 📠 +49-4191-508-209

contact@wiska.de · www.wiska.com

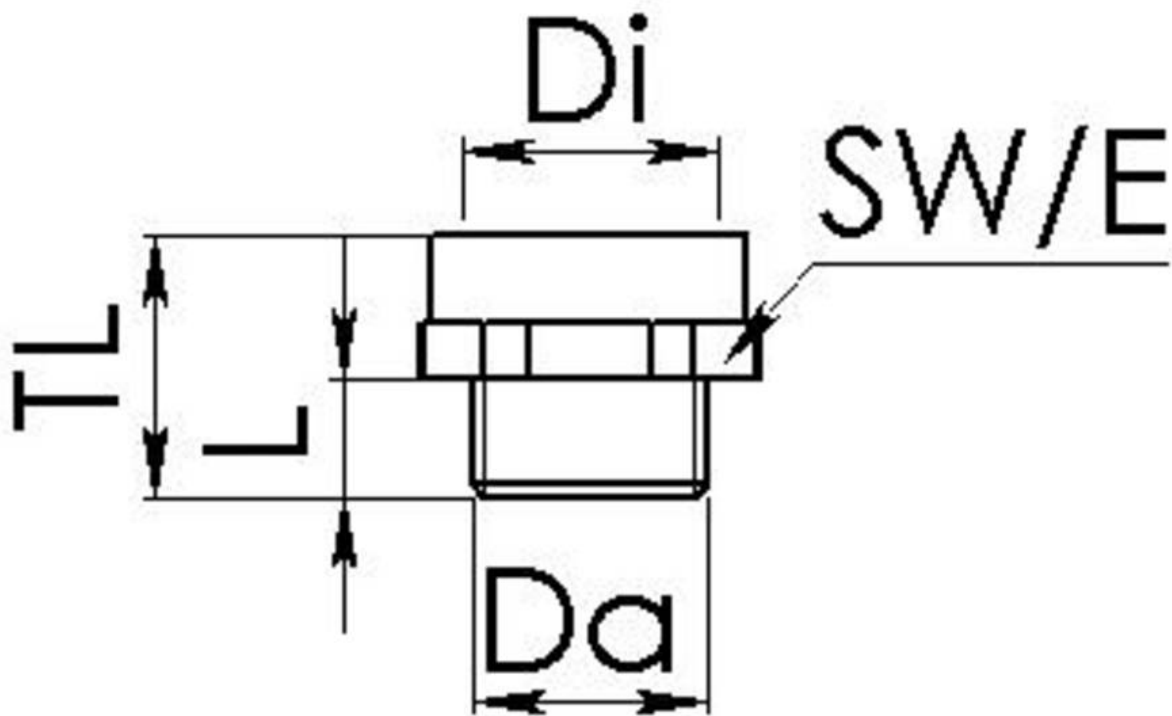

Your Contact:

**WISKA Hoppmann GmbH**

Kisdorfer Weg 28 · 24568 Kaltenkirchen · Germany

☎ +49-4191-508-0 · 📠 +49-4191-508-209

contact@wiska.de · www.wiska.com