

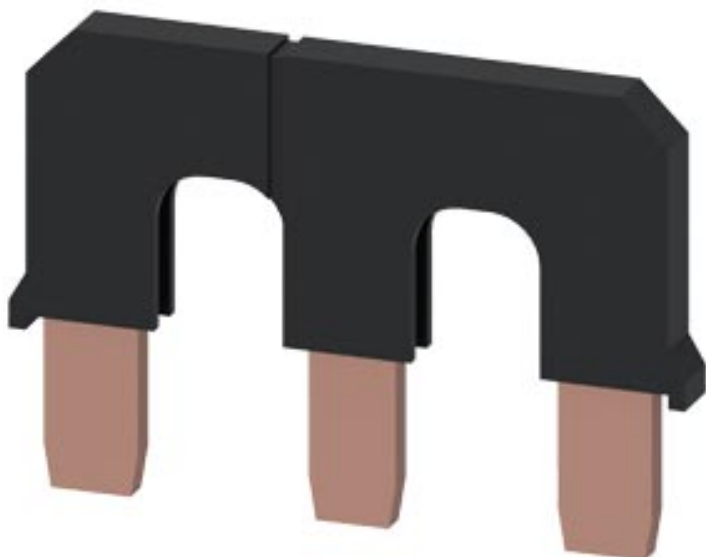



elemento di collegamento in parallelo senza morsetto di collegamento, a 3 poli per 3RT2.3





Dati tecnici generali

marca del prodotto	SIRIUS
denominazione del prodotto	Ponticello di collegamento
esecuzione del prodotto	Elemento di collegamento in parallelo per contattori S2

Certificati/ Approvazioni

General Product Approval			Declaration of Conformity	Test Certificates
 CSA	 UL		 EG-Konf.	Miscellaneous Special Test Certificate

Shipping Approval			other	
 ABS	 PRS	 RINA	Confirmation	Miscellaneous

Ulteriori informazioni

Information- and Downloadcenter (Cataloghi, Opuscoli,...)

<https://www.siemens.com/ic10>

Industry Mall (sistema di ordinazione Online)

<https://mall.industry.siemens.com/mall/it/it/Catalog/product?mlfb=3RT1936-4BA31>

Generatore CAx online

<http://support.automation.siemens.com/WW/CAXorder/default.aspx?lang=en&mlfb=3RT1936-4BA31>

Service&Support (Manuali, Certificati, Caratteristiche, FAQ, ...)

<https://support.industry.siemens.com/cs/ww/it/ps/3RT1936-4BA31>

Banca dati immagini (foto prodotto, disegni dimensionali 2D, modelli 3D, schemi delle connessioni, macro EPLAN...)

http://www.automation.siemens.com/bilddb/cax_de.aspx?mlfb=3RT1936-4BA31&lang=en

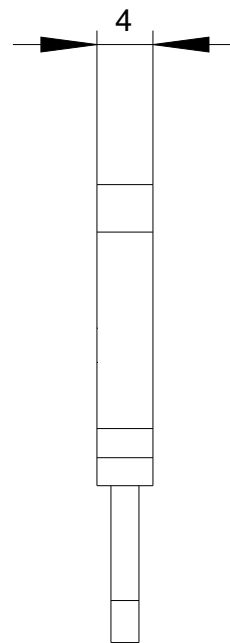
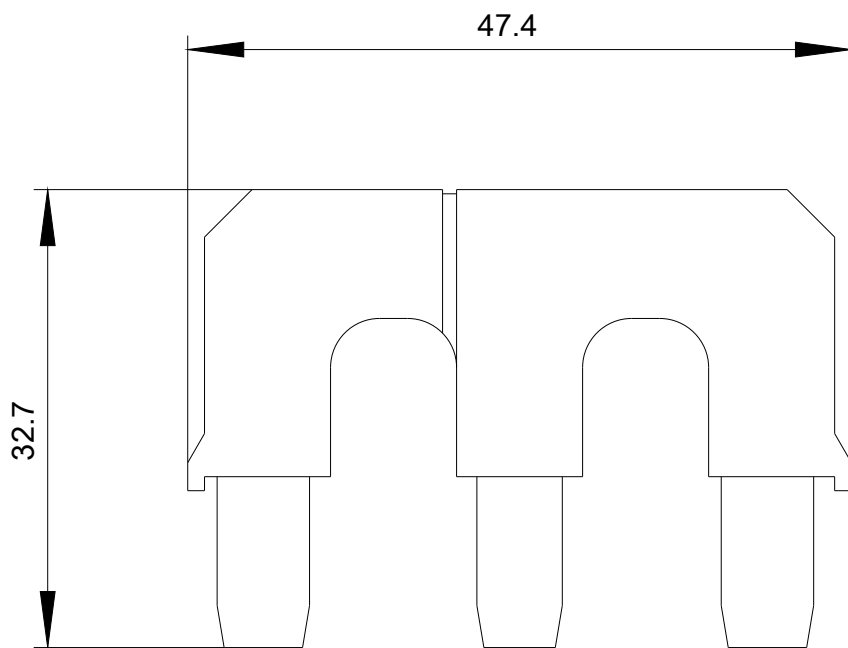

Ultima modifica:

18/08/2020