



Pont de couplage pour mise en parallèle sans borne de raccordement, 3 pôles pour 3RT2.3 sans protection contre les contacts

Certificats/ homologations

certificat d'aptitude		CE / UL / CSA			
General Product Approval	EMC	Declaration of Conformity	Test Certificates		
Confirmation		 RCM	 EG-Konf.	UK Declaration of Conformity	Special Test Certificate

Marine / Shipping

				other	
 ABS	 PRS	 RINA	 DNV-GL	Confirmation	Miscellaneous

Railway

Special Test Certificate
--

Autres informations

Information- and Downloadcenter (Catalogues, Brochures,...)
<https://www.siemens.com/ic10>

Industry Mall (système de commande en ligne)
<https://mall.industry.siemens.com/mall/fr/fr/Catalog/product?mlfb=3RT1936-4BA33>

Générateur CAx en ligne
<http://support.automation.siemens.com/WW/CAXorder/default.aspx?lang=en&mlfb=3RT1936-4BA33>

Service&Support (manuels, certificats, caractéristiques, questions fréquentes FAQ, etc.)
<https://support.industry.siemens.com/cs/ww/fr/ps/3RT1936-4BA33>

Banque de données images (photos des produits, schémas cotés 2D, modèles 3D, schémas des connexions, macros EPLAN, ...)
http://www.automation.siemens.com/bilddb/cax_de.aspx?mlfb=3RT1936-4BA33&lang=en

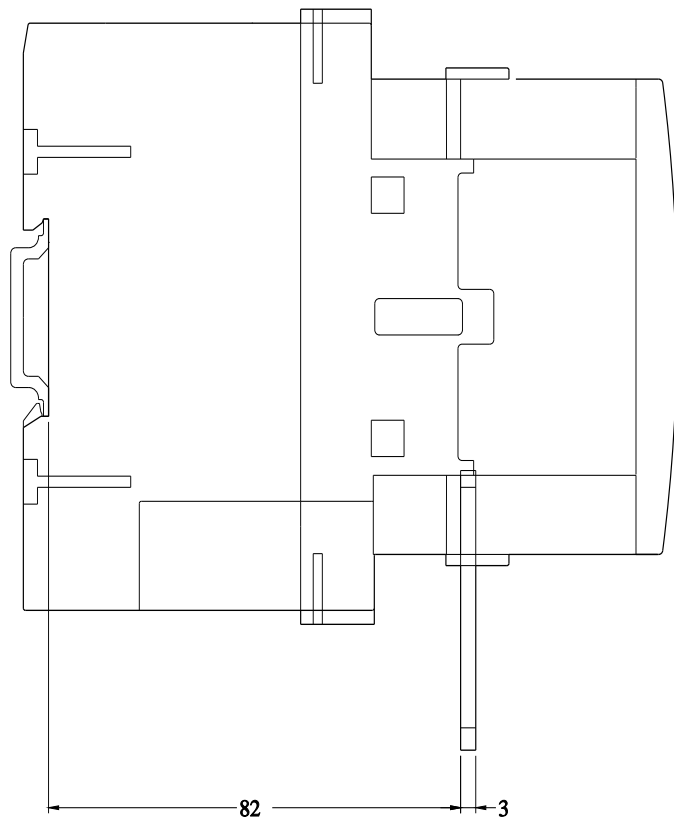
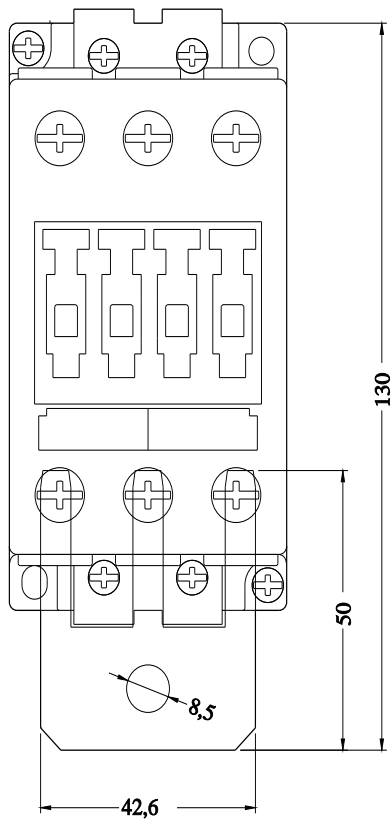

dernière modification :

21/04/2021 