

LED module, red for plug-in relay, PT and RT series, for DC 24 V with freewheeling diode



General technical data

display version LED	Yes
<ul style="list-style-type: none"> • protection class IP 	IP00
Design of the switching function positively driven	No
reference code acc. to DIN EN 81346-2	P

Control circuit/ Control

control supply voltage at DC	
<ul style="list-style-type: none"> • rated value 	24 V
Product component Plug-in socket	No

Auxiliary circuit

<ul style="list-style-type: none"> • number of NC contacts for auxiliary contacts 	0
<ul style="list-style-type: none"> • number of NO contacts for auxiliary contacts 	0
<ul style="list-style-type: none"> • number of CO contacts for auxiliary contacts 	0

Main circuit

type of voltage	DC
-----------------	----

Display

<ul style="list-style-type: none"> • display version as status display by LED 	LED red
--	---------

Connections/ Terminals

- | | |
|---------------------------------------|----|
| • Product function removable terminal | No |
|---------------------------------------|----|

Installation/ mounting/ dimensions

• mounting position	any
height	10.5 mm
width	11.4 mm
depth	32 mm

Ambient conditions

- | | |
|--|----------------|
| • ambient temperature during storage | -25 ... +70 °C |
| • ambient temperature during transport | -25 ... +70 °C |

Certificates/ approvals

General Product Approval



Declaration of Conformity

[Miscellaneous](#)

other

[Confirmation](#)

Further information

Information- and Downloadcenter (Catalogs, Brochures,...)

<https://www.siemens.com/ic10>

Industry Mall (Online ordering system)

<https://mall.industry.siemens.com/mall/en/en/Catalog/product?mlfb=LZS:PTML0024>

Cax online generator

<http://support.automation.siemens.com/WW/CAXorder/default.aspx?lang=en&mlfb=LZS:PTML0024>

Service&Support (Manuals, Certificates, Characteristics, FAQs,...)

<https://support.industry.siemens.com/cs/ww/en/ps/LZS:PTML0024>

Image database (product images, 2D dimension drawings, 3D models, device circuit diagrams, EPLAN macros, ...)

http://www.automation.siemens.com/bilddb/cax_de.aspx?mlfb=LZS:PTML0024&lang=en

Characteristic: Derating

<https://support.industry.siemens.com/cs/ww/en/ps/LZS:PTML0024/manual>

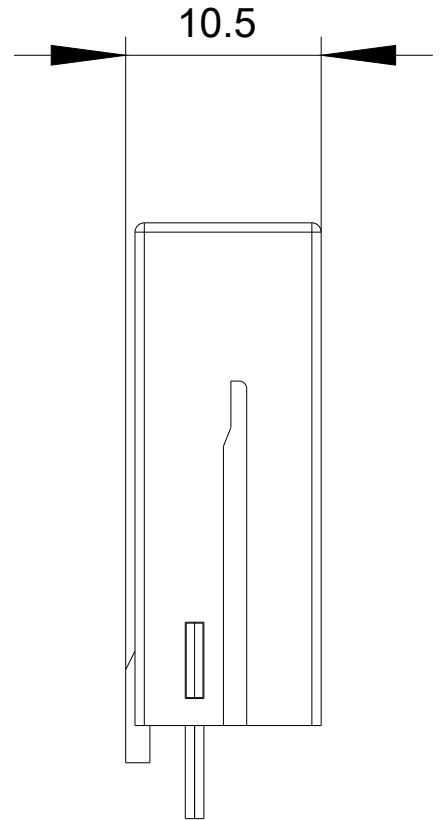
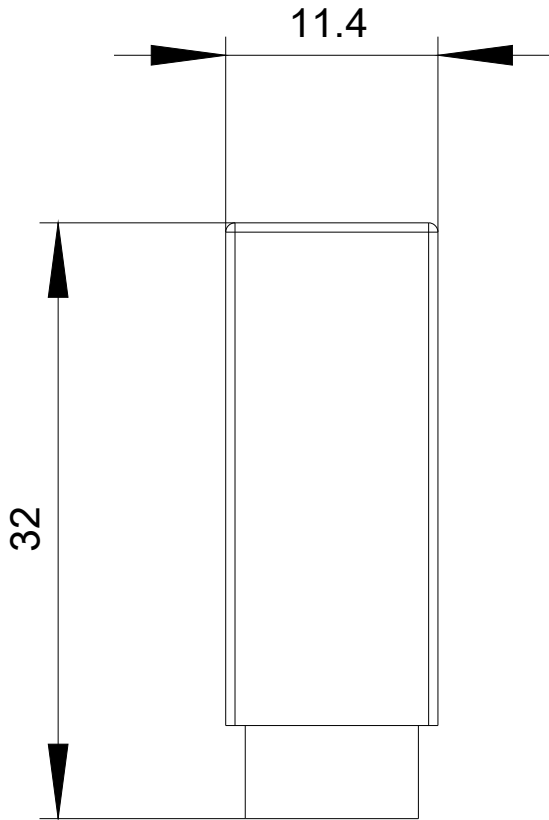

-P

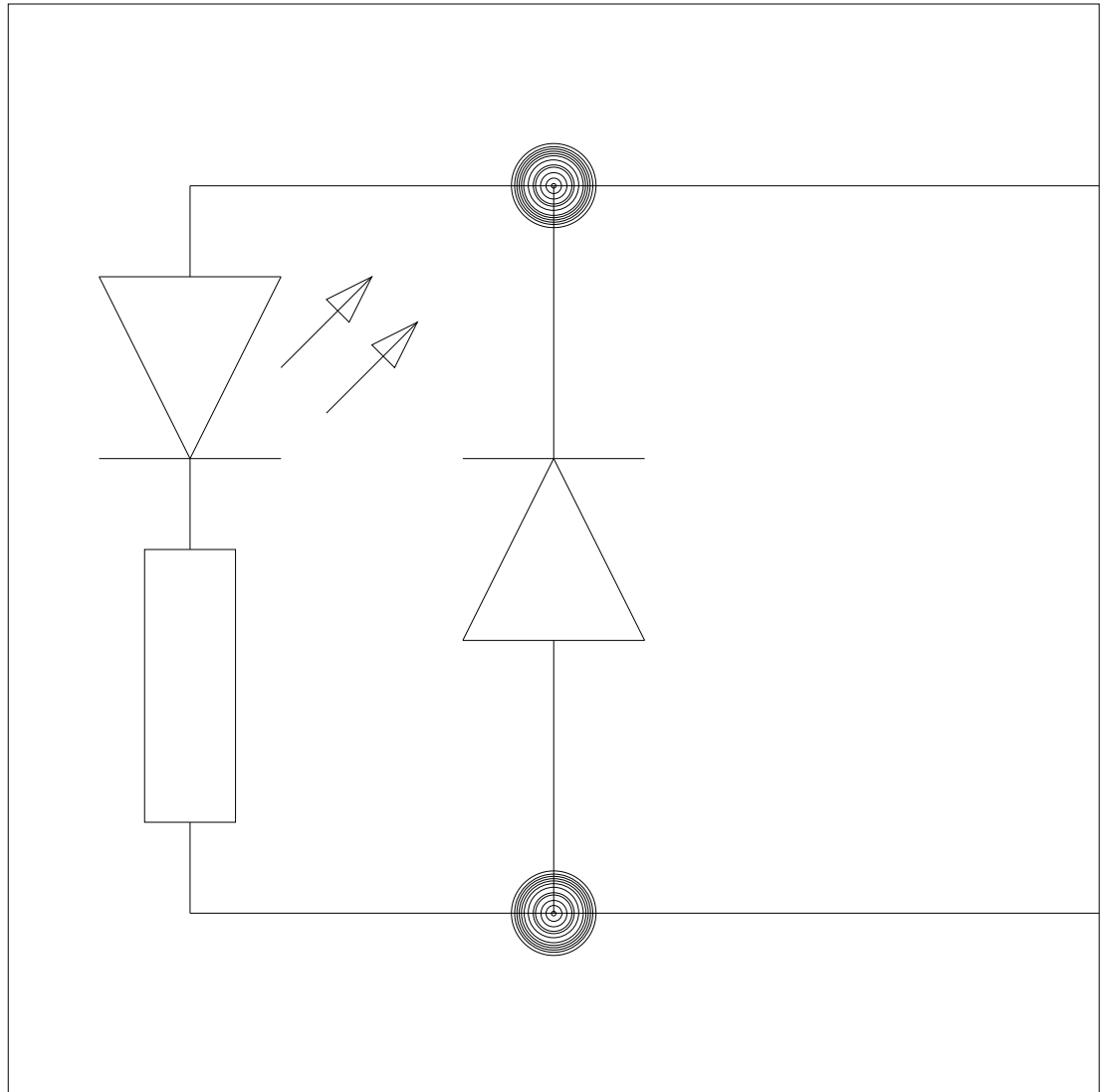

last modified:

08/18/2020