

Continuous light element, blue, 12-230 V AC/DC, 70 mm diameter, base BA 15d without light element



General technical data	
Product brand name	SIRIUS
Product designation	Continuous light element
Design of the optical signal	continuous light
Type of voltage of the operating voltage	AC/DC
Operating voltage	
• at DC rated value	12 ... 230 V
• at AC at 50 Hz rated value	12 ... 230 V
• at AC at 60 Hz rated value	12 ... 230 V
Material	PC
Color	blue
Mounting type	Bayonet
Reference code	
• acc. to DIN EN 61346-2	P
• acc. to DIN EN 81346-2	P

Mechanical data	
Outer diameter of the signal column element	70 mm





### Lamp

Product component Light source	No
Type of light source	filament lamp / LED
Light intensity	0.32 cd
Light intensity	0.25 ... 0.42 cd
Mounting type	BA 15d

#### Ambient conditions

Ambient temperature during operation	-20 ... +60 °C
Protection class IP	IP65
Height	65.5 mm
Width	70 mm

#### Certificates/ approvals

General Product Approval	EMC	Declaration of Conformity	other
 UL		 RCM	 EG-Konf.
		<a href="#">Miscellaneous</a>	<a href="#">Confirmation</a>

#### Further information

##### Information- and Downloadcenter (Catalogs, Brochures,...)

[www.siemens.com/sirius/catalogs](http://www.siemens.com/sirius/catalogs)

##### Industry Mall (Online ordering system)

<https://mall.industry.siemens.com/mall/en/en/Catalog/product?mlfb=8WD4400-1AF>

##### Cax online generator

<http://support.automation.siemens.com/WW/CAXorder/default.aspx?lang=en&mlfb=8WD4400-1AF>

##### Service&Support (Manuals, Certificates, Characteristics, FAQs,...)

<https://support.industry.siemens.com/cs/ww/en/ps/8WD4400-1AF>

##### Image database (product images, 2D dimension drawings, 3D models, device circuit diagrams, EPLAN macros, ...)

[http://www.automation.siemens.com/bilddb/cax\\_de.aspx?mlfb=8WD4400-1AF&lang=en](http://www.automation.siemens.com/bilddb/cax_de.aspx?mlfb=8WD4400-1AF&lang=en)

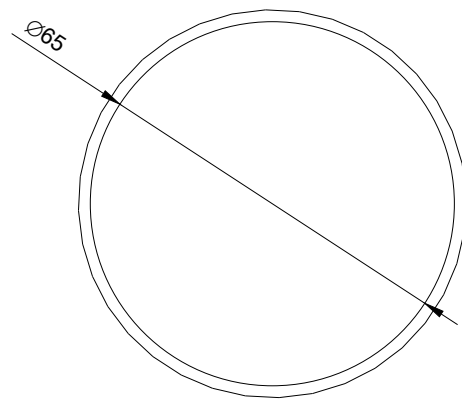
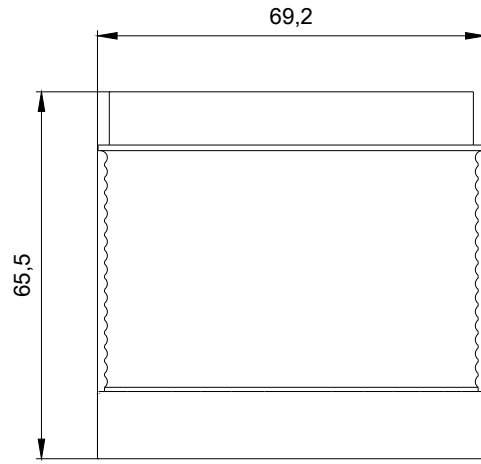

last modified:

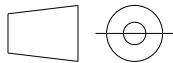

WS 4444;  
 W6.8333; 8WD44...\_ALL  
 04/03/2020