

circuit breaker VL400 UL; type JG (cat no. NJX3B400) non-interchangeable frame, with circuit breaker approval acc. to UL 489 standard breaking capacity 3-pole, NEMA rating 35kA/480V, (molded case circuit breaker) Electronic Trip Unit TM, LI TA=40°C In=< 400A, rated current II=2000..4000A short-circuit protection IR=400A Electronic Trip Unit for line protection without connection accessories without auxiliary release without auxiliary/alarm switch

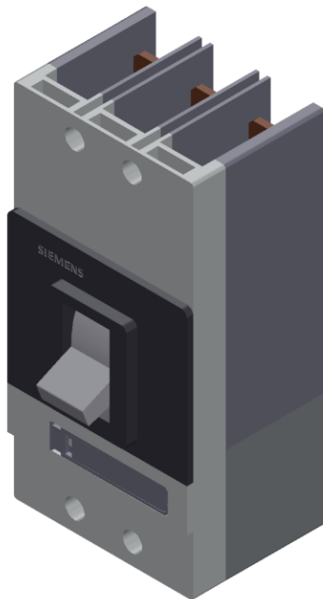

Model	
Type of the driving mechanism / motor drive	No
Design of the overcurrent release	TM
General technical data	
number of poles	3
Size of the circuit-breaker	3VL4 UL
Electrical endurance (switching cycles) / typical	10 000

Usage category	A
Performance class for circuit breaker	N
Mechanical service life (switching cycles) / typical	20 000
Reference code / acc. to DIN 40719 extended according to IEC 204-2 / acc. to IEC 750	Q
Operating frequency / maximum	120 1/s

Voltage

Rated operational voltage U _e / max.	690 V
Insulation voltage	
• rated value	800 V
• at AC / rated value	800 V
Surge voltage resistance / rated value	8 kV
Operating voltage	
• rated value / maximum	690 V
• for main current circuit / at AC / at 50 Hz / acc. to UL 489 / maximum	600 V
• for main current circuit / at AC / at 50 Hz / maximum	690 V
• for main current circuit / at AC / at 60 Hz / acc. to UL 489 / maximum	600 V
• for main current circuit / at AC / at 60 Hz / maximum	690 V
• for main current circuit / at DC / acc. to UL 489 / maximum	500 V

Protection class

Protection class IP	IP20
protection function of the overcurrent release	LI

Current

Continuous current / rated value	400 A
Derating temperature / for the rated value of the continuous current	
• acc. to UL 489	40 °C
adjustable pick-up value current	
• of the current-dependent overload release / Full-scale value	400 A
• of instantaneous short-circuit trip unit / initial value	2 000 A
• of instantaneous short-circuit trip unit / Full-scale value	4 000 A

Main circuit

Operating frequency	
• 1 / rated value	50 Hz

• 2 / rated value	60 Hz
Operating current	
• at 40 °C / rated value	400 A
• at 50 °C / rated value	372 A
• at 55 °C / rated value	344 A
• at 60 °C / rated value	344 A

Auxiliary circuit	
Number of CO contacts / for auxiliary contacts	0
Number of NC contacts / for auxiliary contacts	0
Number of NO contacts / for auxiliary contacts	0

Suitability	
suitability for use	system protection

Adjustable parameters	
adjustable pick-up value current / of the current-dependent overload release / initial value	400 A

Product details	
Product component	
• Trip indicator	No
• Auxiliary switch	No
• Voltage trigger	No
• undervoltage release	No
• undervoltage release with leading contact	No
Product extension / optional / motor drive	Yes

Product function	
Product function	
• of thermal overload trip unit	fixed
• Ground fault protection	No
• for neutral conductors / Short-circuit and overload proof	No
• Overload protection	Yes

Short circuit	
Operational short-circuit current breaking capacity (Ics)	
• at 240 V / rated value	65 kA
• at 415 V / rated value	45 kA
• at 690 V / rated value	6 kA
Maximum short-circuit current breaking capacity (Icu)	
• at 240 V / rated value	65 kA
• at 415 V / rated value	45 kA
• at 480 V / acc. to NEMA / rated value	35 kA

- at 600 V / acc. to NEMA / rated value 25 kA
- at 690 V / rated value 12 kA

Connections

Arrangement of electrical connectors / for main current circuit	front side
Type of connectable conductor cross-sections / for main contacts	<ul style="list-style-type: none"> • with flexible busbar 32 x 10 mm • solid 70 ... 300 mm² • stranded 70 ... 300 mm²
Type of connectable conductor cross-sections / for auxiliary contacts	<ul style="list-style-type: none"> • solid 0.75 ... 1.5 mm² • finely stranded / with core end processing 0,75 ... 1.0 mm²
Type of electrical connection / for main current circuit	without connection accessoires

Mechanical Design

Height	279.5 mm
Width	139.5 mm
Depth	163.5 mm
Mounting type	fixed mounting

Environmental conditions

Ambient temperature / during operation	<ul style="list-style-type: none"> • minimum 0 °C • maximum 70 °C
Ambient temperature / during storage	<ul style="list-style-type: none"> • minimum -40 °C • maximum 80 °C

Certificates

certificate of suitability	UL standard switching capacity (N), non-interchangeable
• reference code / acc. to DIN EN 61346-2	Q

General Product Approval	EMC	Declaration of Conformity
--------------------------	-----	---------------------------



CCC



CSA

[Miscellaneous](#)



UL



C-Tick



EG-Konf.

Test Certificates	Shipping Approval	other			
-------------------	-------------------	-------	--	--	--

[Special Test Certificate](#)



RMRS

[Miscellaneous](#)

[Confirmation](#)

[Environmental Confirmations](#)

[Manufacturer Declaration](#)

Further information

Information- and Downloadcenter (Catalogs, Brochures,...)

<http://www.siemens.com/lowvoltage/catalogs>

Industry Mall (Online ordering system)

<https://mall.industry.siemens.com/mall/en/en/Catalog/product?mfb=3VL4140-1KN30-0AA0>

Service&Support (Manuals, Certificates, Characteristics, FAQs,...)

<https://support.industry.siemens.com/cs/ww/en/ps/3VL4140-1KN30-0AA0>

Image database (product images, 2D dimension drawings, 3D models, device circuit diagrams, ...)

http://www.automation.siemens.com/bilddb/cax_en.aspx?mfb=3VL4140-1KN30-0AA0

CAX-Online-Generator

<http://www.siemens.com/cax>

Tender specifications

<http://www.siemens.com/specifications>