

Operator panel titanium gray, installation in control cabinet door or front plate, can be plugged onto basic unit or extension modules, 10 LEDs for status display and 5 freely assignable keys for manual control



Product brand name	SIRIUS
Product designation	operator panels

### General technical data

<b>Insulation voltage</b>	
• rated value	300 V
<b>Surge voltage resistance rated value</b>	4 000 V
<b>Protection class IP</b>	
• on the front	IP54
<b>Vibration resistance</b>	1-6 Hz / 15 mm; 6-500 Hz / 2 g
<b>Reference code acc. to DIN EN 81346-2</b>	A
<b>Reference code acc. to DIN EN 61346-2</b>	A

### Electromagnetic compatibility

<b>EMC emitted interference</b>	
• acc. to IEC 60947-1	class A
<b>EMI immunity acc. to IEC 60947-1</b>	corresponds to degree of severity 3
<b>Conducted interference</b>	
• due to burst acc. to IEC 61000-4-4	1 kV
• due to conductor-earth surge acc. to IEC 61000-4-5	2 kV

- due to conductor-conductor surge acc. to IEC 61000-4-5

1 kV

Field-bound parasitic coupling acc. to IEC 61000-4-3

10 V/m





### Installation/ mounting/ dimensions





Mounting position	any
Mounting type	front panel mounting
Height	36 mm
Width	96 mm
Depth	44 mm

### Ambient conditions

<b>Installation altitude at height above sea level</b> <ul style="list-style-type: none"> <li>• maximum</li> <li>• 1 maximum</li> <li>• 2 maximum</li> <li>• 3 maximum</li> </ul>	<p>4 000 m</p> <p>2 000 m</p> <p>3 000 m; max. +50 °C (no protective separation)</p> <p>4 000 m; max. +40 °C (no protective separation)</p>
<b>Ambient temperature</b> <ul style="list-style-type: none"> <li>• during operation</li> </ul>	-25 ... +60 °C
<b>Environmental category</b> <ul style="list-style-type: none"> <li>• during operation acc. to IEC 60721</li> <li>• during storage acc. to IEC 60721</li> <li>• during transport acc. to IEC 60721</li> </ul>	<p>3K6 (no formation of ice, no condensation, relative humidity 10 ... 95%), 3C3 (no salt mist), 3S2 (sand must not get into the devices), 3M6</p> <p>1K6 (no condensation, relative humidity 10 ... 95%), 1C2 (no salt mist), 1S2 (sand must not get into the devices), 1M4</p> <p>2K2, 2C1, 2S1, 2M2</p>

### Certificates/ approvals

General Product Approval	EMC	Declaration of Conformity	Test Certificates
 CSA  UL 	 RCM	 EG-Konf.	<a href="#">Type Test Certificates/Test Report</a>

Marine / Shipping	other
 ABS  RMRS  DNVGL.COM/AF	<a href="#">Confirmation</a>  Profibus <a href="#">PROFINET-Certification</a>

### Further information

Information- and Downloadcenter (Catalogs, Brochures,...)  
[www.siemens.com/ic10](http://www.siemens.com/ic10)

**Industry Mall (Online ordering system)**

<https://mall.industry.siemens.com/mall/en/en/Catalog/product?mlfb=3UF7200-1AA01-0>

**Cax online generator**

<http://support.automation.siemens.com/WW/CAXorder/default.aspx?lang=en&mlfb=3UF7200-1AA01-0>

**Service&Support (Manuals, Certificates, Characteristics, FAQs,...)**

<https://support.industry.siemens.com/cs/ww/en/ps/3UF7200-1AA01-0>

**Image database (product images, 2D dimension drawings, 3D models, device circuit diagrams, EPLAN macros, ...)**

[http://www.automation.siemens.com/bilddb/cax\\_de.aspx?mlfb=3UF7200-1AA01-0&lang=en](http://www.automation.siemens.com/bilddb/cax_de.aspx?mlfb=3UF7200-1AA01-0&lang=en)

**Test report No. A0258, protective separation**

<https://support.industry.siemens.com/cs/ww/en/view/109748152>

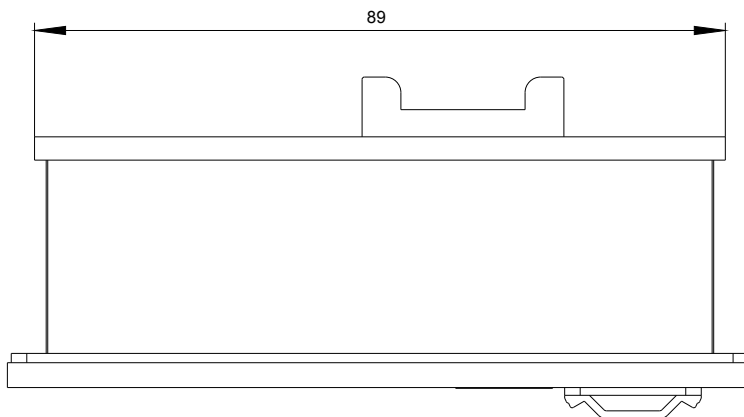
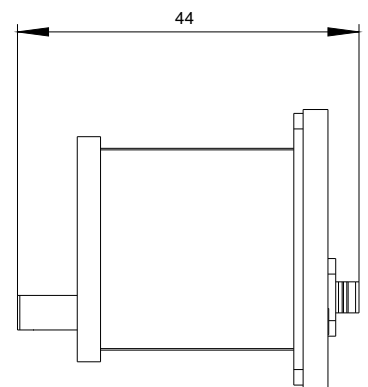
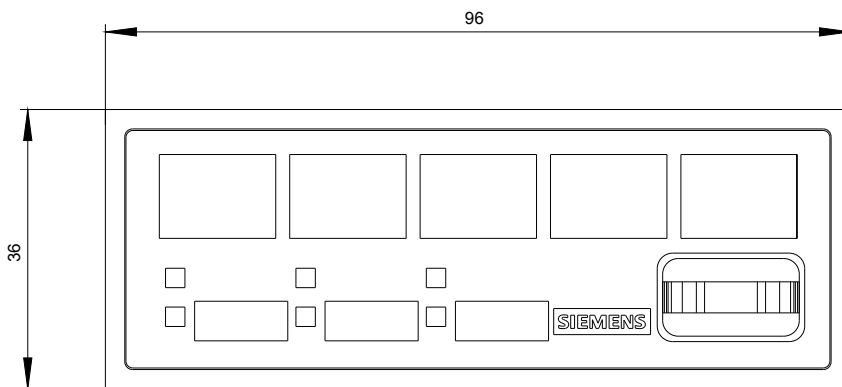

-K

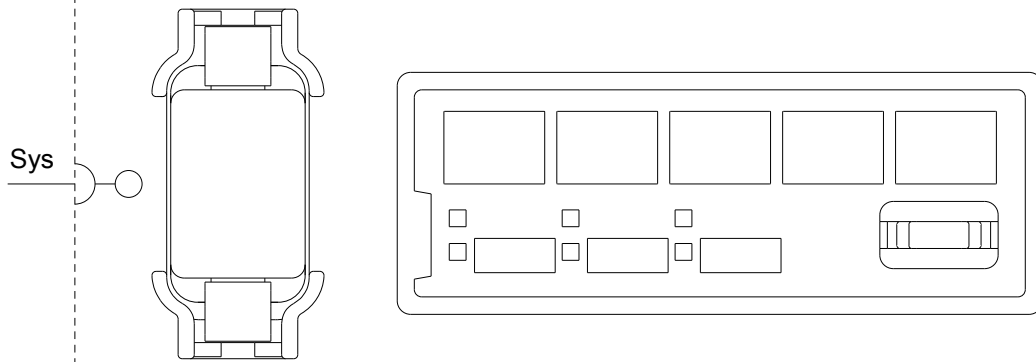

## SIMOCODE PRO

last modified:

07/20/2020