





twist lever for position switch 3SE51 metal lever 27 mm long, Step 9 mm with Rubber roller 50 mm



Product brand name	SIRIUS
Product designation	actuator for part-turn actuator
Product type designation	3SE5
Manufacturer's article number	
<ul style="list-style-type: none"> of the supplied operating lever 	3SE5000-0AA08

General technical data	
Product function	
<ul style="list-style-type: none"> positive opening 	Yes
Shock resistance	
<ul style="list-style-type: none"> acc. to IEC 60068-2-27 	30 g / 11 ms
Vibration resistance	
<ul style="list-style-type: none"> acc. to IEC 60068-2-6 	0.35 mm/5g
Mechanical service life (switching cycles)	
<ul style="list-style-type: none"> typical 	15 000 000
Reference code acc. to DIN EN 81346-2	T
Reference code acc. to DIN EN 61346-2	T
Active principle	mechanical
Design of the interface for safety-related communication	without

Enclosure	
Coating of the enclosure	Other types
Drive Head	
Design of the operating mechanism	Twist lever, metal lever, 27 mm long, step 9 mm, rubber roller 50 mm
Standard-compliant actuator head	EN 50041, design A
Shape of the switch head	roller
Outer diameter of the switch head	50 mm
Communication/ Protocol	
Design of the interface	without
Ambient conditions	
Ambient temperature	
• during operation	-25 ... +85 °C
• during storage	-40 ... +90 °C
Explosion protection category for dust	none
Installation/ mounting/ dimensions	
Mounting position	any
Mounting type	screw fixing
Certificates/ approvals	
General Product Approval	Declaration of Conformity
 	  
	Miscellaneous
Test Certificates	other
Type Test Certificates/Test Report	Confirmation
Further information	
Information- and Downloadcenter (Catalogs, Brochures,...) https://www.siemens.com/ic10	
Industry Mall (Online ordering system) https://mall.industry.siemens.com/mall/en/en/Catalog/product?mlfb=3SE5000-0AA08	
Cax online generator http://support.automation.siemens.com/WW/CAXorder/default.aspx?lang=en&mlfb=3SE5000-0AA08	
Service&Support (Manuals, Certificates, Characteristics, FAQs,...) https://support.industry.siemens.com/cs/ww/en/ps/3SE5000-0AA08	
Image database (product images, 2D dimension drawings, 3D models, device circuit diagrams, EPLAN macros, ...) http://www.automation.siemens.com/bilddb/cax_de.aspx?mlfb=3SE5000-0AA08&lang=en	

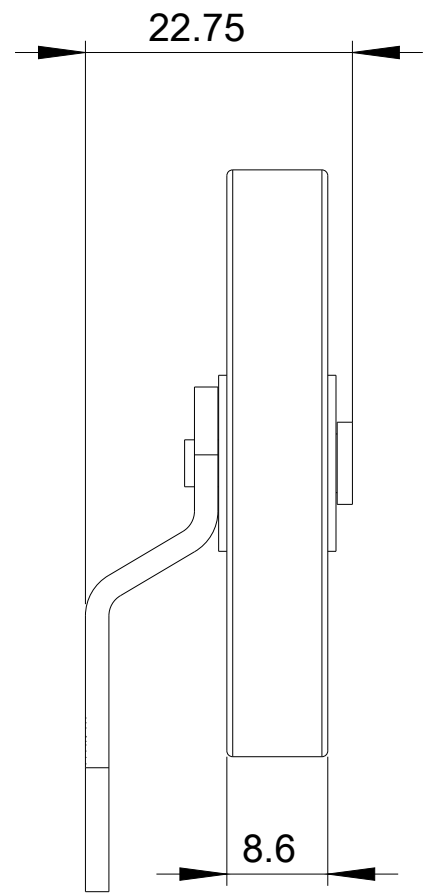
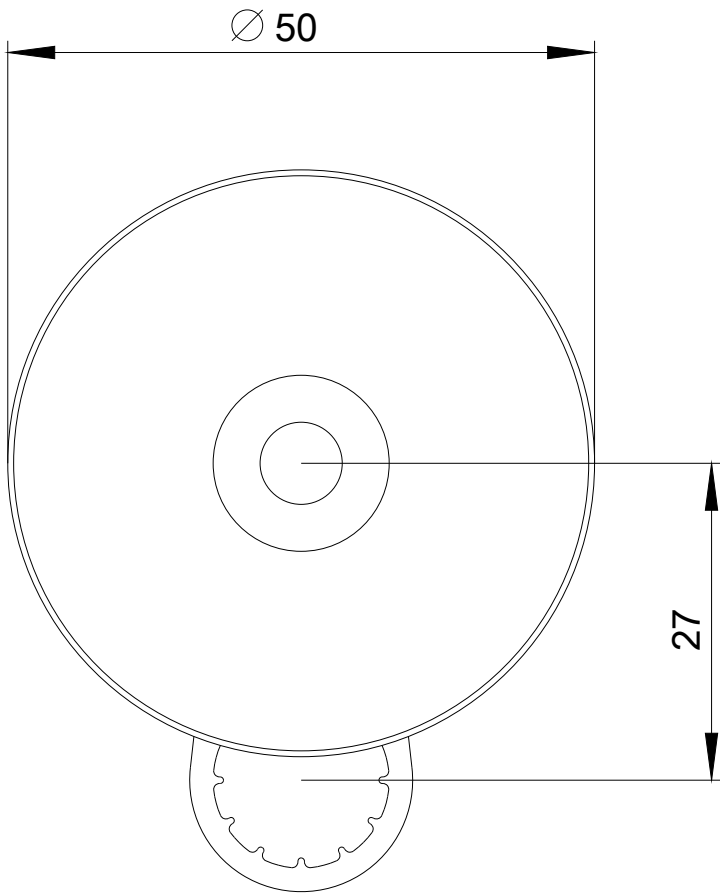

last modified:

08/05/2020