

EPIC® MC module: HC2

The mixed assembly guarantees high flexibility. For applications in mechanical and plant engineering, for printing machines and slide-in technology.

The high-power module with 2-pole screw termination ensures high flexibility thanks to the combination of various functions within a single product.

Info

High power module 2pole with screw connection

Lever for rapid removal of the module



M

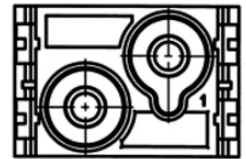

F

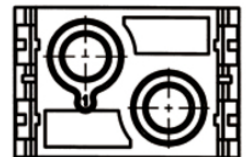

Supplementary automation components from Lapp



Mechanical and plant engineering



Wind Energy

Benefits

The mix of different functions in one plug guarantees high flexibility

Screw connection up to 25mm² for easy assembly without special tools

Application range

Plant engineering

Printing machines

Control engineering

Technical Data

Classification ETIM 5:

ETIM 5.0 Class-ID: EC002641

ETIM 5.0 Class-Description: Modular connector (industrial connector)

Classification ETIM 6:

ETIM 6.0 Class-ID: EC002641

Last Update (06.08.2021)

©2021 Lapp Group - Technical changes reserved

Product Management www.lappkabel.de

You can find the current technical data in the corresponding data sheet.

PN 0456 / 02_03.16

EPIC® MC module: HC2

	ETIM 6.0 Class-Description: Modular connector (industrial connector)
Rated voltage (V):	IEC: 1000 V UL: 600 V CSA: 600 V
Rated current (A):	82 A
Pollution degree:	3
Contact resistance:	< 2 mOhm
Contacts:	Copper alloy, hard silver-plated
Number of contacts:	2
Termination methods:	Screw termination: 10 - 25 mm ²
Stripping length (mm):	15
Cycle of mechanical operation:	100
VDE-tested:	Certified production control: VDE-REG. no. A870 UL-tested: UL File Number: E75770
Temperature range:	-40°C to +100°C, short-term up to +125°C

Note

Photographs and graphics are not to scale and do not represent detailed images of the respective products. Prices are net prices without VAT and surcharges. Sale to business customers only.

EPIC® MC module: HC2

Article number	Article description	Contact type	Number of operating contacts	Slots	Pieces / PU
Module: high current 2-pin					
10344100	MCS-HC 2	male	2	2	5
10345100	MCB-HC 2	female	2	2	5

Last Update (06.08.2021)

©2021 Lapp Group - Technical changes reserved

Product Management www.lappkabel.de

You can find the current technical data in the corresponding data sheet.
PN 0456 / 02_03_16