



Wiring set, For DOL Starter, DILM7-...-PI - DILM15-...-PI, Push in terminals

Part no. PKZM0-XDM12-PI
Catalog No. 199463
Alternate Catalog No. XTPAXTPCDPIB
EL-Nummer (Norway) 4312246

Delivery program

Product range			Accessories
Accessories			Wiring set
			For DOL Starter
For use with			PKZM0...-PI (-SPI32), PKE...-PI + DILM7...-PI PKZM0...-PI (-SPI32), PKE...-PI + DILM9...-PI PKZM0...-PI (-SPI32), PKE...-PI + DILM12...-PI PKZM0...-PI (-SPI32), PKE...-PI + DILM15...-PI
Connection technique			Push in terminals
Rated operational voltage	U _e	V AC	690
Rated operational current	I _e	A	15

Technical data ETIM 8.0

Low-voltage industrial components (EG000017) / Wiring set for power circuit breaker (EC002050)			
Electric engineering, automation, process control engineering / Low-voltage switch technology / Circuit breaker (LV < 1 kV) / Wiring set for circuit breaker (ecl@ss10.0.1-27-37-04-24 [ACN957011])			
Suitable for number of poles			3
Model			Direct circuit

Dimensions

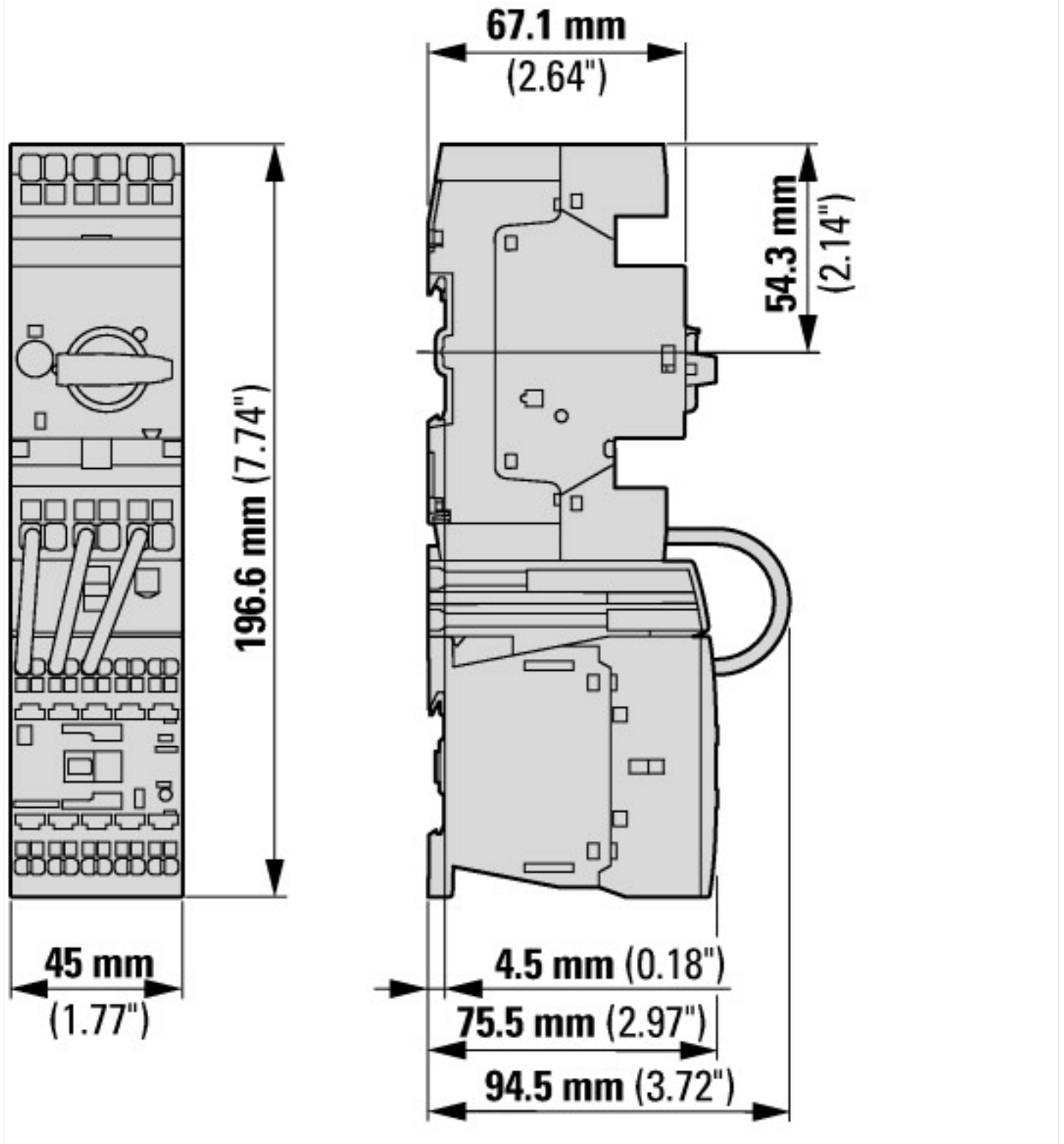

Additional product information (links)

Motor starters and "Special Purpose Ratings" for the North American market

http://www.eaton.eu/ecm/groups/public/@pub/@europe/@electrical/documents/content/pct_3258146.pdf

Busbar Component Adapters for modern Industrial control panels

http://www.moeller.net/binary/ver_techpapers/ver960en.pdf