



Circuit-breaker, 4p, 800A, 500A in 4th pole

Part no. **NZMN4-4-AE800/500**
 Catalog No. **265910**

Similar to illustration

Delivery program

| | | | | |
|---------------------|--|--|--|--|
| Product range | | | | Circuit-breaker |
| Protective function | | | | System and cable protection |
| Standard/Approval | | | | IEC |
| Installation type | | | | Fixed |
| Release system | | | | Electronic release |
| Construction size | | | | NZM4 |
| Description | | | | Set value in neutral conductor is synchronous with set value I_r of main pole. R.m.s. value measurement and "thermal memory" |
| Number of poles | | | | 4 pole |
| Standard equipment | | | | Screw connection |





Switching capacity

| | | | |
|-----------------|----------|----|----|
| 400/415 V 50 Hz | I_{cu} | kA | 50 |
|-----------------|----------|----|----|

Rated current = rated uninterrupted current

| | | | |
|---|----------------------|-----|--------------------------------------|
| Rated current = rated uninterrupted current | $I_n = I_u$ | A | 800 |
| Neutral conductor | % of phase conductor | CSA | 60 |
| Reduced neutral conductor protection | | A | 500 |
| Neutral conductor protection | | | Reduced neutral conductor protection |

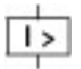
Setting range

| | | | | |
|---|--------------------------|---|-----------|--|
| Overload trip | | | | |
|  | I_r | A | 400 - 800 | |
| Main pole  | I_r | A | 250 - 500 | |
| Short-circuit releases  | | | | |
| Non-delayed  | $I_i = I_n \times \dots$ | | 2 - 15 | |

Technical data

General

| | | | | |
|---|--|------|----------------------------------|--|
| Standards | | | | IEC/EN 60947 |
| Protection against direct contact | | | | Finger and back of hand proof to VDE 0106 Part 100 |
| Climatic proofing | | | | Damp heat, constant, to IEC 60068-2-78 Damp heat, cyclic, to IEC 60068-2-30 |
| Ambient temperature | | | | |
| Ambient temperature, storage | | °C | - 40 - + 70 | |
| Operation | | °C | -25 - +70 | |
| Mechanical shock resistance (10 ms half-sinusoidal shock) according to IEC 60068-2-27 | | g | 15 (half-sinusoidal shock 11 ms) | |
| Safe isolation to EN 61140 | | | | |
| Between auxiliary contacts and main contacts | | V AC | 500 | |

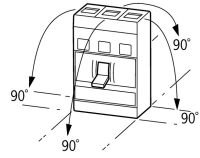
| | | |
|--|------|---|
| between the auxiliary contacts | V AC | 300 |
| Weight | kg | 27 |
| Mounting position | | Vertical and 90° in all directions  With XFI earth-fault release: - NZM1, N1, NZM2, N2: vertical and 90° in all directions with plug-in unit - NZM1, N1, NZM2, N2: vertical, 90° right/left with withdrawable unit: - NZM3, N3: vertical, 90° right/left - NZM4, N4: vertical with remote operator: - NZM2, N(S)2, NZM3, N(S)3, NZM4, N(S)4: vertical and 90° in all directions |
| Direction of incoming supply | | as required |
| Degree of protection | | |
| Device | | In the operating controls area: IP20 (basic degree of protection) |
| Enclosures | | With insulating surround: IP40 With door coupling rotary handle: IP66 |
| Terminations | | Tunnel terminal: IP10 Phase isolator and strip terminal: IP00 |
| Other technical data (sheet catalogue) | | Temperature dependency, Derating |

Circuit-breakers

| | | | |
|---|-------------|------|-------|
| Rated current = rated uninterrupted current | $I_n = I_u$ | A | 800 |
| Rated surge voltage invariability | U_{imp} | | |
| Main contacts | | V | 8000 |
| Auxiliary contacts | | V | 6000 |
| Rated operational voltage | U_e | V AC | 690 |
| Overvoltage category/pollution degree | | | III/3 |
| Rated insulation voltage | U_i | V | 1000 |
| Use in unearthed supply systems | | V | ≤ 525 |

Switching capacity

| | | | |
|---|------------|----|---|
| Rated short-circuit making capacity | I_{cm} | | |
| 240 V | I_{cm} | kA | 105 |
| 400/415 V | I_{cm} | kA | 105 |
| 440 V 50/60 Hz | I_{cm} | kA | 74 |
| 525 V 50/60 Hz | I_{cm} | kA | 53 |
| 690 V 50/60 H | I_c | kA | 40 |
| Rated short-circuit breaking capacity I_{cn} | I_{cn} | | |
| I_{cu} to IEC/EN 60947 test cycle O-t-CO | I_{cu} | kA | |
| 240 V 50/60 Hz | I_{cu} | kA | 50 |
| 400/415 V 50/60 Hz | I_{cu} | kA | 50 |
| 440 V 50/60 Hz | I_{cu} | kA | 35 |
| 525 V 50/60 Hz | I_{cu} | kA | 25 |
| 690 V 50/60 Hz | I_{cu} | kA | 20 |
| I_{cs} to IEC/EN 60947 test cycle O-t-CO-t-CO | I_{cs} | kA | |
| 240 V 50/60 Hz | I_{cs} | kA | 37 |
| 400/415 V 50/60 Hz | I_{cs} | kA | 37 |
| 440 V 50/60 Hz | I_{cs} | kA | 26 |
| 525 V 50/60 Hz | I_{cs} | kA | 19 |
| 690 V 50/60 Hz | I_{cs} | kA | 15 |
| | | | Maximum back-up fuse, if the expected short-circuit currents at the installation location exceed the switching capacity of the circuit-breaker. |
| Rated short-time withstand current | | | |
| t = 0.3 s | I_{cw} | kA | 12 |
| t = 1 s | I_{cw} | kA | 12 |
| Utilization category to IEC/EN 60947-2 | | | A |
| Lifespan, mechanical(of which max. 50 % trip by shunt/undervoltage release) | Operations | | 10000 |

| | | | |
|-----------------------------------|------------|-------|----------------------------|
| Lifespan, electrical | | | |
| AC-1 | | | |
| 400 V 50/60 Hz | Operations | | 3000 |
| 415 V 50/60 Hz | Operations | | 3000 |
| 690 V 50/60 Hz | Operations | | 2000 |
| AC--3 | | | |
| 400 V 50/60 Hz | Operations | | 2000 |
| 415 V 50/60 Hz | Operations | | 2000 |
| 690 V 50/60 Hz | Operations | | 1000 |
| Max. operating frequency | | Ops/h | 60 |
| Total break time at short-circuit | | ms | < 25 ≤ 415 V; < 35 > 415 V |

Terminal capacity

| | | | |
|---|------|-----------------|--|
| Standard equipment | | | Screw connection |
| Optional accessories | | | Tunnel terminal connection on rear Strip terminal |
| Round copper conductor | | | |
| Tunnel terminal | | | |
| Stranded | | | |
| 4-hole | | mm ² | 4 x (50 - 240) |
| Bolt terminal and rear-side connection | | | |
| Direct on the switch | | | |
| Stranded | | mm ² | 1 x (120 - 185) 4 x (50 - 185) |
| Module plate | | | |
| Single hole | min. | mm ² | 1 x (120 - 300) |
| Single hole | max. | mm ² | 2 x (95 - 300) |
| Module plate | | | |
| Double hole | min. | mm ² | 2 x (95 - 185) |
| Double hole | max. | mm ² | 4 x (35 - 185) |
| Connection width extension | | | |
| Connection width extension | | mm ² | 4 x 300 6 x (95 - 240) |
| Al circular conductor | | | |
| Tunnel terminal | | | |
| Stranded | | | |
| 4-hole | | mm ² | 4 x (50 - 240) |
| Bolt terminal and rear-side connection | | | |
| Module plate | | | |
| Single hole | min. | mm ² | 1 x (185 - 240) |
| Single hole | max. | mm ² | 2 x (70 - 185) |
| Module plate | | | |
| Double hole | | mm ² | 4 x 50 |
| Connection width extension | | | |
| Connection width extension | | mm ² | 2 x 240 6 x (70 - 240) |
| Cu strip (number of segments x width x segment thickness) | | | |
| Flat conductor terminal | | | |
| | min. | mm | 6 x 16 x 0.8 |
| | max. | mm | (2 x) 10 x 32 x 1.0 |
| Module plate | | | |
| Single hole | | mm | (2 x) 10 x 50 x 1.0 |
| Bolt terminal and rear-side connection | | | |
| Flat copper strip, with holes | min. | mm | 5 x 25 x 1.0 |
| Flat copper strip, with holes | max. | mm | (2 x) 10 x 50 x 1.0 |

| | | | |
|--|------|-----------------|--------------------------------------|
| Connection width extension | | mm | (2 x) 10 x 80 x 1.0 |
| Copper busbar (width x thickness) | mm | | |
| Bolt terminal and rear-side connection | | | |
| Screw connection | | | M10 |
| Direct on the switch | | | |
| | min. | mm | 25 x 5 |
| | max. | mm | 2 x (50 x 10) |
| Module plate | | | |
| Single hole | min. | mm | 25 x 5 |
| Single hole | max. | mm | 2 x (50 x 10) |
| Module plate | | | |
| Double hole | | mm | 2 x (50 x 10) |
| Connection width extension | | mm | |
| Connection width extension | min. | mm | 60 x 10 |
| Connection width extension | max. | mm | 2 x (80 x 10) |
| Control cables | | | |
| | | mm ² | 1 x (0.75 - 2.5) 2 x (0.75 - 1.5) |

Design verification as per IEC/EN 61439

| | | | |
|--|------------------|----|-----|
| Technical data for design verification | | | |
| Rated operational current for specified heat dissipation | I _n | A | 800 |
| Equipment heat dissipation, current-dependent | P _{vid} | W | 106 |
| Operating ambient temperature min. | | °C | -25 |
| Operating ambient temperature max. | | °C | 70 |
| IEC/EN 61439 design verification | | | |
| 10.2 Strength of materials and parts | | | |
| 10.2.2 Corrosion resistance | | | |
| 10.2.2.1 Verification of thermal stability of enclosures | | | |
| 10.2.2.2 Verification of resistance of insulating materials to normal heat | | | |
| 10.2.2.3 Verification of resistance of insulating materials to abnormal heat and fire due to internal electric effects | | | |
| 10.2.4 Resistance to ultra-violet (UV) radiation | | | |
| 10.2.5 Lifting | | | |
| 10.2.6 Mechanical impact | | | |
| 10.2.7 Inscriptions | | | |
| 10.3 Degree of protection of ASSEMBLIES | | | |
| 10.4 Clearances and creepage distances | | | |
| 10.5 Protection against electric shock | | | |
| 10.6 Incorporation of switching devices and components | | | |
| 10.7 Internal electrical circuits and connections | | | |
| 10.8 Connections for external conductors | | | |
| 10.9 Insulation properties | | | |
| 10.9.2 Power-frequency electric strength | | | |
| 10.9.3 Impulse withstand voltage | | | |
| 10.9.4 Testing of enclosures made of insulating material | | | |
| 10.10 Temperature rise | | | |
| 10.11 Short-circuit rating | | | |
| 10.12 Electromagnetic compatibility | | | |
| 10.13 Mechanical function | | | |

Technical data ETIM 7.0

Low-voltage industrial components (EG000017) / Power circuit-breaker for trafo/generator/installation protection (EC000228)

| | | |
|---|----|--|
| Rated permanent current I _u | A | 800 |
| Rated voltage | V | 690 - 690 |
| Rated short-circuit breaking capacity I _{cu} at 400 V, 50 Hz | kA | 50 |
| Overload release current setting | A | 400 - 800 |
| Adjustment range short-term delayed short-circuit release | A | 0 - 0 |
| Adjustment range undelayed short-circuit release | A | 1600 - 9600 |
| Integrated earth fault protection | | No |
| Type of electrical connection of main circuit | | Screw connection |
| Device construction | | Built-in device fixed built-in technique |
| Suitable for DIN rail (top hat rail) mounting | | No |
| DIN rail (top hat rail) mounting optional | | No |
| Number of auxiliary contacts as normally closed contact | | 0 |
| Number of auxiliary contacts as normally open contact | | 0 |
| Number of auxiliary contacts as change-over contact | | 0 |
| With switched-off indicator | | No |
| With under voltage release | | No |
| Number of poles | | 4 |
| Position of connection for main current circuit | | Front side |
| Type of control element | | Rocker lever |
| Complete device with protection unit | | Yes |
| Motor drive integrated | | No |
| Motor drive optional | | Yes |
| Degree of protection (IP) | | IP20 |

Characteristics

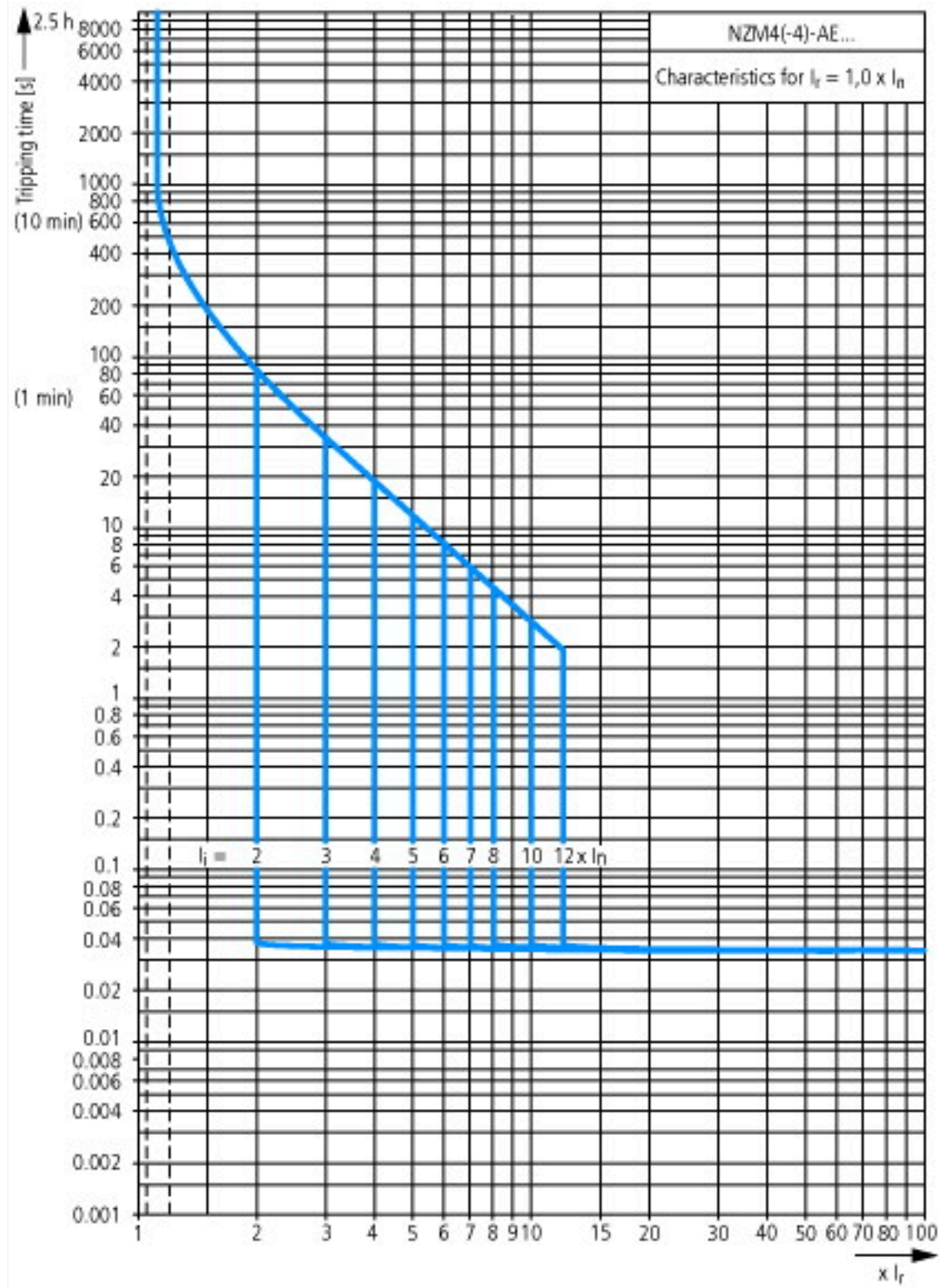

Dimensions

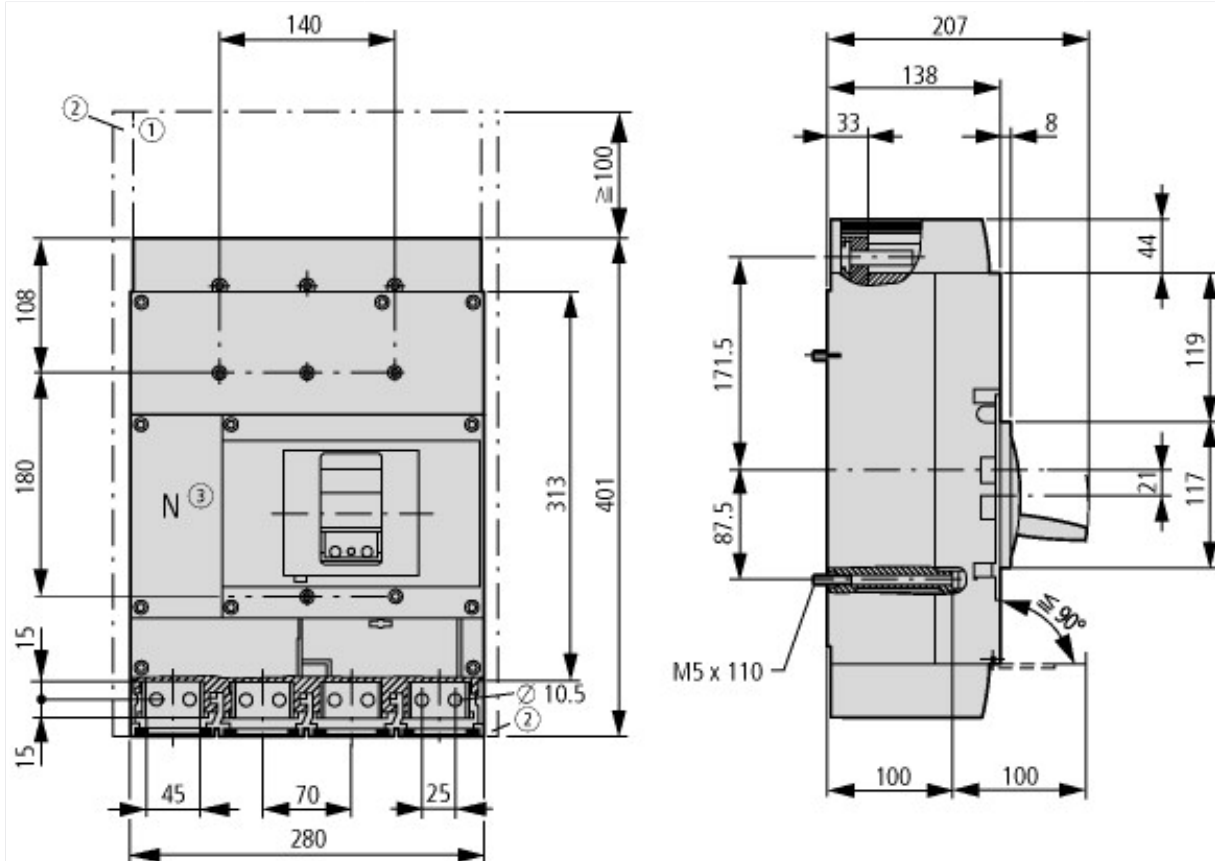

① Blow out area, minimum clearance to adjacent parts

Ui ≤ 690 V: 100 mm

Ui ≤ 1500 V: 200 mm

② Minimum clearance to adjacent parts

Ui ≤ 1000 V: 15 mm

Ui ≤ 1500 V: 70 mm

Additional product information (links)

IL01210010Z (AWA1230-2022) Circuit-Breaker, basic unit

IL01210010Z (AWA1230-2022) Circuit-Breaker, basic unit

ftp://ftp.moeller.net/DOCUMENTATION/AWA_INSTRUCTIONS/IL01210010Z2018_11.pdf

Temperature dependency, Derating

<http://ecat.moeller.net/flip-cat/?edition=HPLEN&startpage=17.172>

CurveSelect characteristics program

<http://www.eaton.eu/DE/Europe/Electrical/CustomersSupport/ConfigurationTools/CharacteristicsProgram/index.htm>

additional technical information for NZM power switch

ftp://ftp.moeller.net/DOCUMENTATION/PDF/nzm_techinc_de_en.pdf