

Type: **M22-I4-ATEX**  
 Article No.: **104374**  
 Sales text **Aufbaugehäuse ATEX**



With high-grade steel screws

Enclosure base: anthracite (RAL 9005)

ATEX part numbers for use in dust-laden areas, Zone 22, Category 3 ( Engineering)

**M22-I6** with degree of protection IP66

**Ordering information**

Number of locations		Qty.	4
Cable entry knockouts			
Base		Quantity × M...	2 × 20
Sides		Quantity × M...	2 × 20 2 × 25/20
Colour			RAL 7035

**Colour**



**Dimensions**

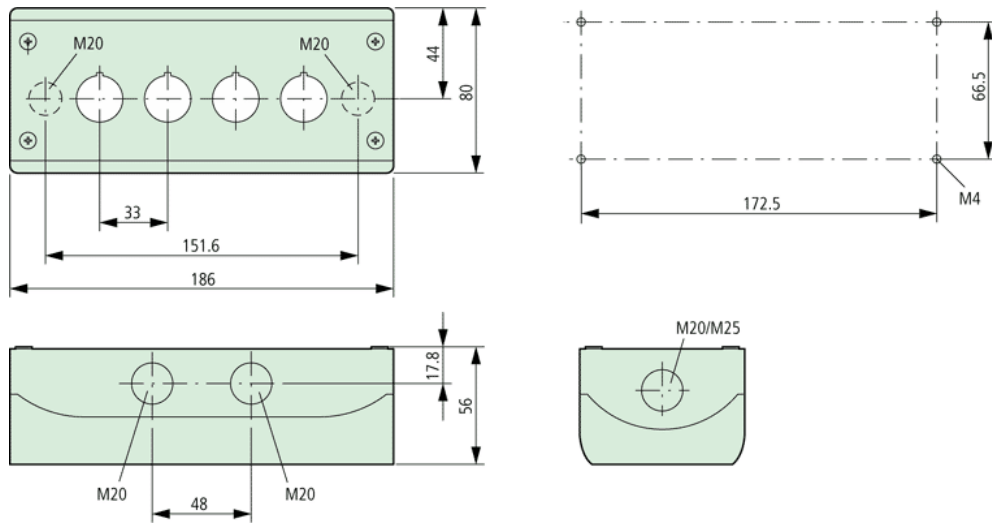

---

Cable entries: 2 × M20, 4 × M20, 2 × M25

---

Moeller GmbH, Hein-Moeller-Str. 7-11, D-53115 Bonn  
 E-Mail: [catalog@moeller.net](mailto:catalog@moeller.net), Internet: [www.moeller.net](http://www.moeller.net), <http://catalog.moeller.net>  
 HPL-C2007G V2.1 © 2007 by Moeller GmbH