

Type: **TM-2-8183/E**
 Article No.: **096235**

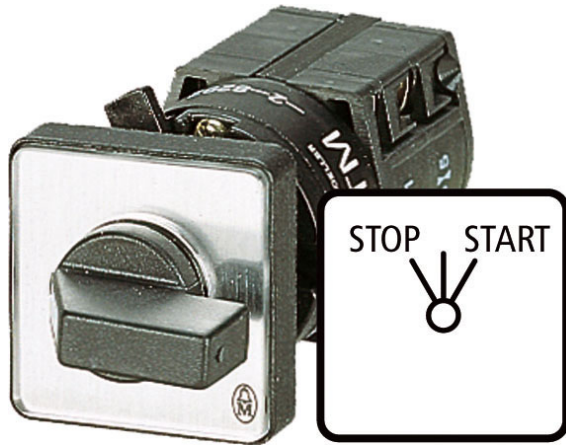

Ordering information

Design			Flush mounting
Pole			2
Description			On switches, spring-return
Protection type			Front IP65

Contact sequence

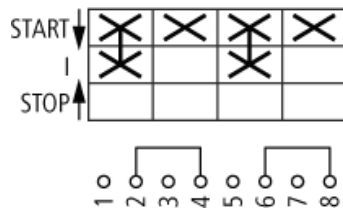

Front plate no.

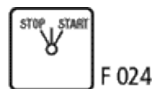

General

Standards			IEC/EN 60947, VDE 0660 UL, CSA Control switches to IEC/EN 60947-5-1 Control circuit isolators to IEC/EN 60947-5-1
Control circuit isolators (IEC/EN 60947-5-1)			Maximum 6 contacts; switching angle 90°
Lifespan, mechanical	Operations	$\times 10^6$	> 1

Maximum operating frequency	Operations/h		3000
Climatic proofing			Damp heat, constant, to IEC 60068-2-78; Damp heat, cyclical, to IEC 60068-2-30
Ambient temperature			
Open		°C	-25/50
Enclosed		°C	-25/40
Mounting position			As required
Terminal capacities			
Solid		mm ²	1 × 1,5 2 × 1,5
Flexible without ferrule		mm ²	1 × 1,5 2 × 1,5
Solid or stranded		AWG	1 × 14 2 × 14
Flexible		AWG	1 × 16 2 × 16
Terminal screw			M2.5
Tightening torque		Nm	0.35

Contacts

Mechanical variables			
Contacts		Number	Max. 16
Contact units			8
Switching angles		°	90 60 45 30
Min. switching angle for On-Off-On		°	60
Max. number of switch positions			12
Thickness of gold coating		µm	35
Electrical characteristics			
Rated operational voltage	U_e	V AC	500
Rated impulse withstand voltage	U_{imp}	V AC	4000
Overvoltage category/pollution degree			III/3
Rated insulation voltage	U_i	V AC	500
Rated insulation voltage for UL/CSA		V AC	300
Rated uninterrupted current	I_u	A	10
Switching capacity			
AC-23 Motor load switches			

230 V AC, 3-pole		kW	1,8
440 V AC, 3-pole		kW	3
230 V AC, 1-pole		kW	0,75
440 V AC, 1-pole		kW	1,1
AC-15 Control switches			
230 V AC, 1-pole		A	2,5
400 V AC, 1-pole		A	1,5
440 V AC, 1-pole		A	1
DC-1 Load-break switches			
1 – 24 V DC		A	10
110 – 240 V DC		A	0,7 – 0,3
DC-13, Control switches L/R = 50 ms			
Rated operational current	I_e	A	3
Voltage per contact pair in series		V	32
Switching capacity (UL489, CSA 22.2 No. 5.1)			
240 V AC, 3-pole		HP	1
277 V AC, 1-pole		HP	ÿ
300 V AC Heavy duty		A	10
Max. short-circuit protective device			
Fuse		A gG/gL	10
Control circuit reliability at 24 V DC, 10 mA	Fault probability	H_F	$< 10^{-5}$, < 1 fault in 100000 operations
Dimensions			
			Depth of one contact unit: 12 mm
			Diameter of drilled hole Door

Dimensions

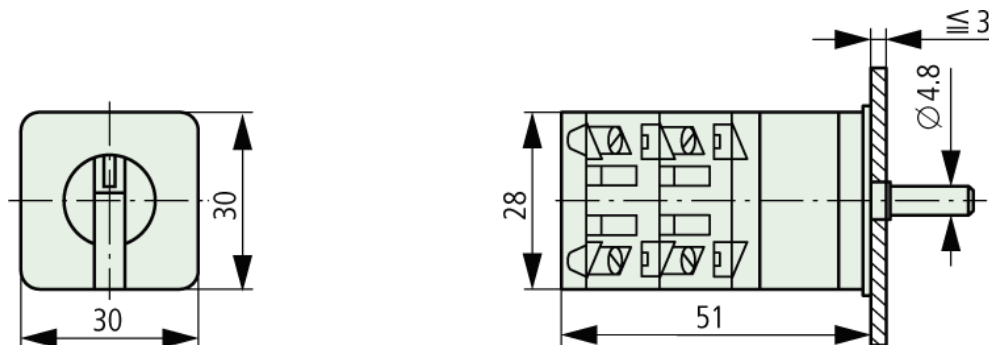

Dimensions

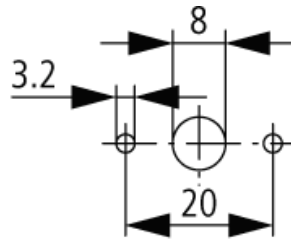
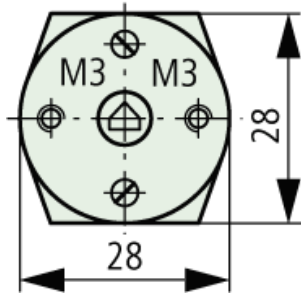

Dimensions

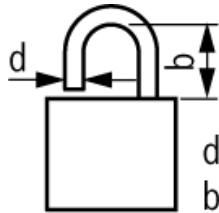

$$d = 4 - 8 \text{ mm}$$
$$b + d \leq 47 \text{ mm}$$

Moeller GmbH, Hein-Moeller-Str. 7-11, D-53115 Bonn
E-Mail: catalog@moeller.net, Internet: www.moeller.net, <http://catalog.moeller.net>
Copyright 2006 by Moeller GmbH. Subject to modifications. HPL-C2006GB-INT V2.3