

MCS-OG

Oil and gas, mild steel combinable version, single door enclosure

nVent

HOFFMAN

CONNECT AND PROTECT



IP 55 | TYPE 12 | IK 10



The mild steel single door combinable floor standing enclosure range, MCS-OG, with a IP 55 protection degree, is available off the shelf in many different sizes and configurations. This enclosure range is well suited for many different applications within Oil and Gas market. The risk for component failure, and with that unnecessary downtime, is eliminated as water and dust are prevented from entering the enclosure.

Material: Frame: 1.5 mm painted steel. Door: 2 mm painted steel. Rear, roof and side panels: 1.5 mm painted steel. Mounting plate: 3 mm galvanized steel. Bottom plates: 1 mm galvanized steel.

Frame: Seam welded reversed open profiles with 25 mm hole pattern according to DIN 43660. Including integrated external hole pattern.

Door: Mounted with four hinges allowing left or right hand opening. Including door frame with 25 mm hole pattern.

Rear: Enclosure with Rear panel fitted by M6 torx screws. Enclosure with Rear door instead of rear panel.

Side panels: Supplied as an accessory.

Roof panel: Removable.

Lock: Espagnolette 4-point locking system. Does not interfere with the enclosure inner space. Standard double-bit lock with 3 mm insert. Standard inserts, cylinders, lift handles and T-handles are available as accessories.

Bottom plates: Consists of three or four pieces for enclosures with one mounting plate and four or six for enclosures with two mounting plates mounted back to back.

Mounting plate: Double folded and slides into position. Adjustable in depth by steps of 25 mm with the MPD02 accessory. Supplied outside of the enclosure packaging. Enclosures with rear door include two mounting plates assembled back to back and four bottom plates.

Earthing: All panels are earthed through their fittings and are equipped with a separate earthing stud.

Finish: RAL 7035 structured powder coating.

Protection: Complies with IP 55 | TYPE 12 | IK 10.

Approvals: CE, CSA, DNV-GL, EAC, GOST, Kema Keur, Lloyds shipping, RS, cULus_listed.

Mounting requirements: Standard delivery ready for combined installation. For stand-alone installation add side panels.

Delivery: Frame with fitted door, rear panel or rear door, roof panel, bottom plates, mounting plate and door frame. Delivery also includes earthing bolts. Delivered on a pallet which is identical to the width of the enclosure to allow suiting without removal. All packing material is recyclable.

MCS-OG

Oil and gas, mild steel combinable version, single door enclosure



HOFFMAN

CONNECT AND PROTECT

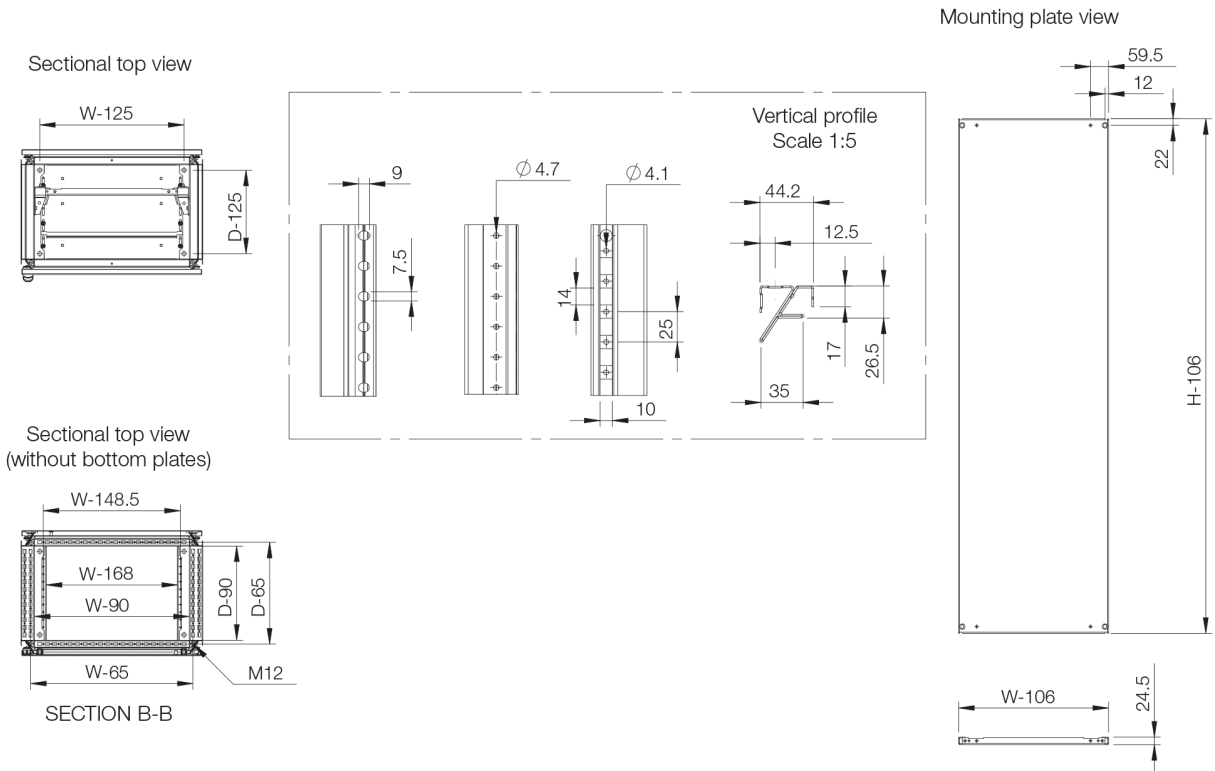
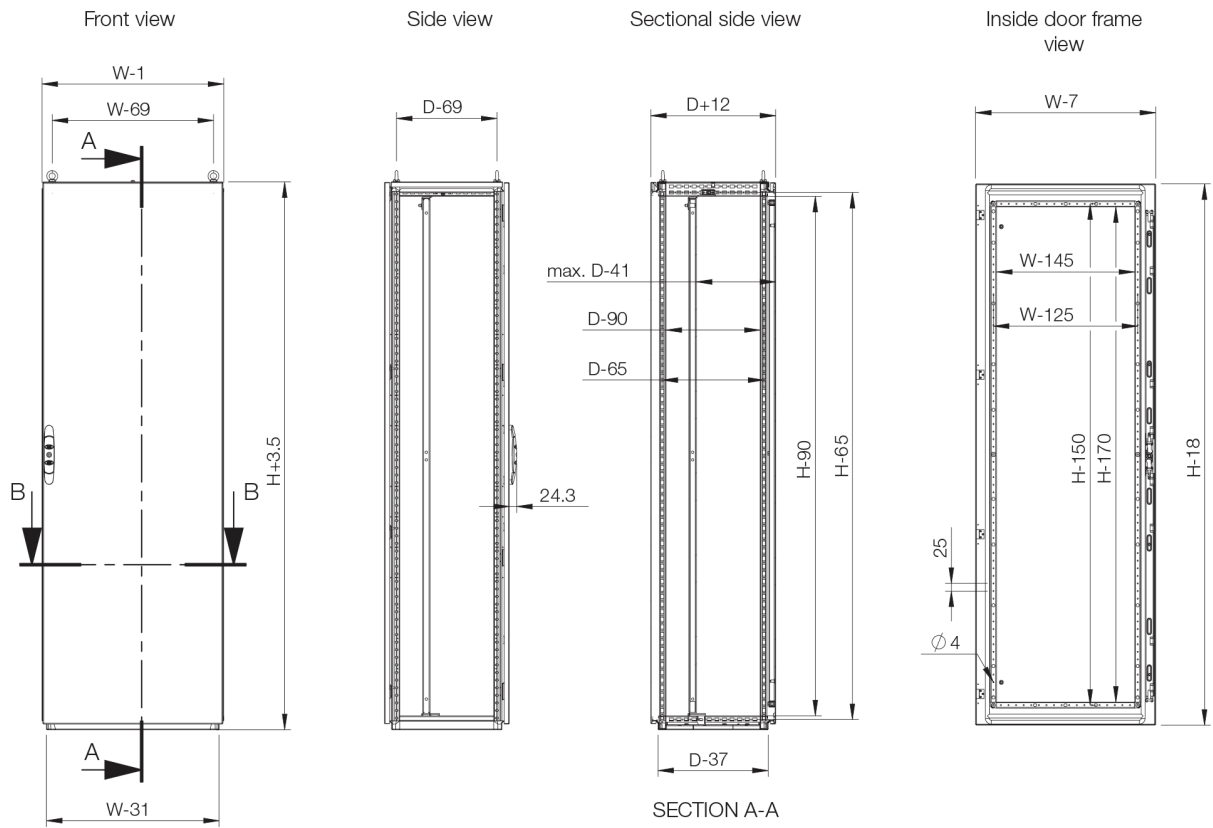

MCS-OG

Oil and gas, mild steel combinable version, single door enclosure

Enclosure dimensions								
	H	W	D	Weight (kg)	h	w	d	Item no.
With mounting plate	2000	600	800	107.000	1894	494	759	MCS20068R5
With mounting plate	2000	800	400	120.000	1894	694	359	MCS20084R5
With mounting plate	2000	800	600	126.000	1894	694	559	MCS20086R5
With mounting plate	2000	800	800	130.000	1894	694	759	MCS20088R5
Without mounting plate	2000	600	800	82.000				MCS20068PER5
Without mounting plate	2000	800	400	88.000				MCS20084PER5
Without mounting plate	2000	800	600	93.000				MCS20086PER5
Without mounting plate	2000	800	800	100.000				MCS20088PER5
With mounting plate and rear door	2000	600	800	107.000	1894	494		MCS20068RDR5
With mounting plate and rear door	2000	800	600	126.000	1894	694		MCS20086RDR5
With mounting plate and rear door	2000	800	800	130.000	1894	694		MCS20088RDR5
With mounting plate and rear door	2000	800	1000	199.820	1894	694		MCS200810RDR5
With mounting plate and rear door	2000	1000	800	156.000	1894	694		MCS20108RDR5
Without mounting plate and with rear door	2000	600	800	107.000				MCS20068PERDR5
Without mounting plate and with rear door	2000	800	600	126.000				MCS20086PERDR5
Without mounting plate and with rear door	2000	800	800	130.000				MCS20088PERDR5
Without mounting plate and with rear door	2000	800	1000	115.730				MCS200810PERDR5
Without mounting plate and with rear door	2000	1000	800	156.000				MCS20108PERDR5

MCS-OG

Oil and gas, mild steel combinable version, single door enclosure



CONNECT AND PROTECT