

Solenoid valves 2/2-ways, servo-operated type EV225B



-			+
-			+

EV225B is a servo-operated 2/2-way solenoid valve for use in steam application.

The design is based on a PTFE diaphragm concept, ensuring high reliable function even in connection with contaminated steam.

Valve body in dezincification resistant brass and valve seats made in stainless steel for ensuring a long life even in connection with aggressive steam media.

- 2/2-way
- Specifically designed for steam applications, 160°C or 185°C
- Servo-operated
- DN 6 - DN 25
- Ambient temperature: +40°C
- G 1/4" to G 1"
- DZR brass valve body
- NC (normally closed)
- ISO 228/1 or UL listed version with NPT for North America (EVSIS/UL)

Dimensions and weight:

EV225B 6-10, coil type BQ and BB

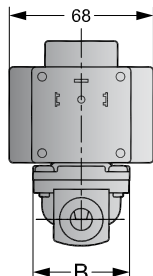
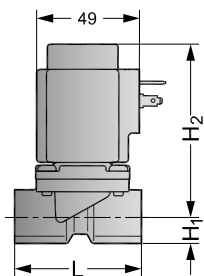
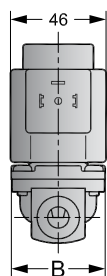

EV225B 6-10, coil type BN

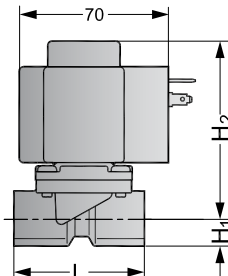

EV225B 15-25, coil type BQ and BB

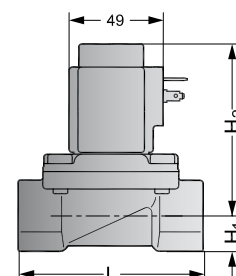
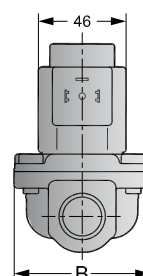

Type / orifice size	L mm	B mm	H mm	H ₁ mm	H ₂ mm	Weight with coil kg, BQ/BB	Weight with coil kg, BN
EV225B 6	62	46	98	13	85	0.75	1.03
EV225B 10	62	46	98	13	85	0.72	1.00
EV225B 15	81	56	102	15	87	0.86	1.14
EV225B 20	98	72	110	18	92	1.40	1.68
EV225B 25	106	72	117	21	96	1.70	1.98

EV225B servo operated steam valve with BQ coil and plug, DZR brass, NC



Type	Connection	Kv m ³ /h	BQ coil, 10 W, ac		24 V 50 Hz	110 V 60 Hz	230 V 50 Hz	220 V 60Hz	Code number
			Temp. max °C	Pressure bar					
EV225B 10	G 1/2	2.2	185	0.2 → 10	✓				032U380416
EV225B 15	G 1/2	3.0	185	0.2 → 10	✓				032U380516
EV225B 20	G 3/4	5.0	185	0.2 → 10	✓				032U380616
EV225B 25	G 1	6.0	185	0.2 → 10	✓				032U380716
EV225B 10	G 1/2	2.2	185	0.2 → 10		✓			032U380420
EV225B 15	G 1/2	3.0	185	0.2 → 10		✓			032U380520
EV225B 20	G 3/4	5.0	185	0.2 → 10		✓			032U380620
EV225B 25	G 1	6.0	185	0.2 → 10		✓			032U380720
EV225B 10	G 1/2	2.2	185	0.2 → 10			✓		032U380431
EV225B 15	G 1/2	3.0	185	0.2 → 10			✓		032U380531
EV225B 20	G 3/4	5.0	185	0.2 → 10			✓		032U380631
EV225B 25	G 1	6.0	185	0.2 → 10			✓		032U380731
EV225B 10	G 1/2	2.2	185	0.2 → 10				✓	032U380429
EV225B 15	G 1/2	3.0	185	0.2 → 10				✓	032U380529
EV225B 20	G 3/4	5.0	185	0.2 → 10				✓	032U380629
EV225B 25	G 1	6.0	185	0.2 → 10				✓	032U380729



EV225B servo operated steam valve with BN coil and plug, DZR brass, NC

Type	Connection	Kv m ³ /h	BN coil, 20 W		24 V, dc	Code number
			Temp. max °C	Pressure bar		
EV225B 10	G 1/2	2.2	160	0.2 → 5	✓	032U380402
EV225B 15	G 1/2	3.0	160	0.2 → 5	✓	032U380502
EV225B 20	G 3/4	5.0	160	0.2 → 5	✓	032U380602
EV225B 25	G 1	6.0	160	0.2 → 5	✓	032U380702



EV225B servo-operated steam valve, DZR brass, NC, PTFE seal material

Type	Connection	Kv m ³ /h	BQ coil, 10 W, ac		BN coil, 20 W, dc		BB coil, 10 W, ac		BB coil, 18 W, dc		Code number
			Temp. max °C	Pressure bar	Temp. max °C	Pressure bar	Temp. max °C	Pressure bar	Temp. max °C	Pressure bar	
EV225B 6	G 1/4	0.9	185	0.2 → 10	160	0.2 → 5	160	0.2 → 5	140	0.2 → 3.6	032U3802
EV225B 10	G 3/8	2.2	185	0.2 → 10	160	0.2 → 5	160	0.2 → 5	140	0.2 → 3.6	032U3803
EV225B 10	G 1/2	2.2	185	0.2 → 10	160	0.2 → 5	160	0.2 → 5	140	0.2 → 3.6	032U3804
EV225B 15	G 1/2	3.0	185	0.2 → 10	160	0.2 → 5	160	0.2 → 5	140	0.2 → 3.6	032U3805
EV225B 20	G 3/4	5.0	185	0.2 → 10	160	0.2 → 5	160	0.2 → 5	140	0.2 → 3.6	032U3806
EV225B 25	G 1	6.0	185	0.2 → 10	160	0.2 → 5	160	0.2 → 5	140	0.2 → 3.6	032U3807

Coils for EV225B



Voltage		Frequency	Effect, watt			BQ coil , ac 10 bar, 185°C IP65 clip-on	BN coil , dc 5 bar, 160°C IP 65 clip-on	BB coil, ac 5 bar, 160°C IP 65 clip-on	BB coil, dc 3.6 bar, 140°C IP 65 clip-on
V ac	V dc	Hz	BQ	BN	BB				
24		50	10		10	018F4517		018F7358	
24		60			10			018F7365	
115		50			10			018F7361	
110		60	10		10	018F4519		018F7360	
220		60	10			018F4520			
230		50	10		10	018F4511		018F7351	
230		60			10			018F7363	
240		50			10			018F7352	
380		50			10			018F7353	
	12				18				018F7396
	24			20	18		018F6968		018F7397

Cable plug, IP 65 enclosure



To use with all BB coils

042N0156

042N0156

042N0156

042N0156

Spare part kits



Application	Seal material	Code number
EV225 6-10	PTFE	032U3171
EV225 15	PTFE	032U3172
EV225 20 -25	PTFE	032U3173

Capacity diagram for EV225B

Example, steam:
 Capacity for EV225 10 BD; inlet pressure (p_1) of 6 bar absolute; differential pressure at 1 bar:
 Approx. 100 kg/h / 80 kW

