

AAD-M ALUMINIUM TERMINALS

for non-tension connections on aluminum conductors according to DIN EN 50182

Tube dimensions according to DIN 46329

Description:

- Terminals type AAD.-M.. are made from aluminium tube of a purity equal or greater than 99,5%. They are suitable for aluminum conductors according to DIN EN 50182, up to 10 kV.
- All terminals are filled with a special grease that avoids aluminum oxidation after crimp and thus guarantees an optimal compression.
- Barrel is closed with a cap for storage and transport.
- On the terminal following information is shown:
 - Cembre logo
 - Terminal description
 - Section
 - Connecting bolt
 - Number and position of crimps
 - Compression code according to DIN 48083



Surface: bright

Sections and dimensions:

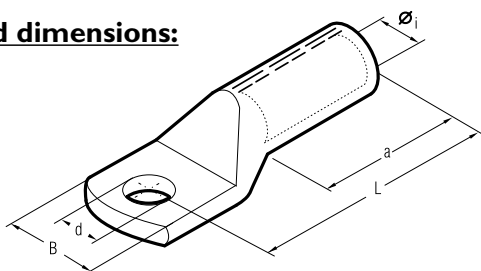

Features of the material:

- DESIGNATION : Al 99.50
- STANDARD OF REFERENCE : DIN 1712/1976 Teil 3
- ELECTRICAL RESISTANCE AT 20°C ($\mu\Omega \cdot \text{cm}$): ≤ 2.874
- MECHANICAL FEATURES (depending on diameters dimension):
 - TENSILE STRENGTH (N/mm^2) : $\geq 85 \div \leq 129$
 - ELONGATION (A5) % : $10 \div 23$

Conductor Size		Ø Stud	Ref.	Code	Dimensions mm				
mm	sqmm				Øi	B	L	d	a
16	25	8	AAD16-M8	12	5,8	18	52	8,5	32
		10	AAD16-M10	12	5,8	18	52	10,5	32
25	35	8	AAD25-M8	12	6,8	19	60	8,5	37
		10	AAD25-M10	12	6,8	19	60	10,5	37
35	50	10	AAD35-M10	14	8,0	21	67	10,5	42
		12	AAD35-M12	14	8,0	21	67	13,0	42
50	70	10	AAD50-M10	16	9,8	25	72	10,5	42
		12	AAD50-M12	16	9,8	25	72	13,0	42
70	95	10	AAD70-M10	18	11,2	28	83	10,5	52
		12	AAD70-M12	18	11,2	28	83	13,0	52
95	120	10	AAD95-M10	22	13,2	32	90	10,5	55
		12	AAD95-M12	22	13,2	32	90	13,0	55
120	150	16	AAD95-M16	22	13,2	34	90	17,0	55
		10	AAD120-M10	22	14,7	32	91	10,5	55
120	150	12	AAD120-M12	22	14,7	32	91	13,0	55
		16	AAD120-M16	22	14,7	34	91	17,0	55
150	185	10	AAD150-M10	25	16,5	35	104	10,5	60
		12	AAD150-M12	25	16,5	35	104	13,0	60
150	185	16	AAD150-M16	25	16,5	35	104	17,0	60
		20	AAD150-M20	25	16,5	41	104	21,0	60
185	240	12	AAD185-M12	28	18,3	40	105	13,0	60
		16	AAD185-M16	28	18,3	40	105	17,0	60
185	240	20	AAD185-M20	28	18,3	40	105	21,0	60
		12	AAD240-M12	32	21,0	45	119	13,0	70
240	300	16	AAD240-M16	32	21,0	45	119	17,0	70
		20	AAD240-M20	32	21,0	45	119	21,0	70
300	300	12	AAD300-M12	34	23,3	49	125	13,0	70
		16	AAD300-M16	34	23,3	49	125	17,0	70
300	300	20	AAD300-M20	34	23,3	49	125	21,0	70
		12	AAD400-M12	38	26,0	58	140	13,0	100
400	400	16	AAD400-M16	38	26,0	58	140	17,0	100
		20	AAD400-M20	38	26,0	58	140	21,0	100
500	500	16	AAD500-M16	44	29,0	63	160	17,0	100
		20	AAD500-M20	44	29,0	63	160	21,0	100

Cembre SpA

Via Serenissima, 9 - 25135 Brescia (Italy)

Tel.: +39 030 36921 - Fax: +39 030 3365766

Web: www.cembre.com - Email: info@cembre.com