

PRESSACAVI MAXIbrass®

in Ottone nichelato

2900



Materiale: OTTONE nichelato
 Guarnizione: NEOPRENE®
 Griffe di serraggio:
 POLIAMMIDE PA6.6
 O-Ring: NITRILE 70 sh A
 (compreso e già montato)
 Grado di protezione: IP 68
 Temperatura d'impiego:
 da -25°C a +100°C (continua)

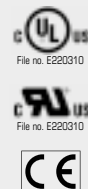

MAXIbrass®

Passo Pg DIN 40 430

Tipo Ottone Nichelato	P	Foro Fissaggio (mm)	Ø A min-max (mm)	B Chiave (mm)	E (mm)	C (mm)	L min-max (mm)	Imballo
2900.07N	Pg 7	12,7	3 - 7	16	18	5,0	16-20	100
2900.09N	Pg 9	15,5	4 - 8	17	19	6,0	17-23	100
2900.11N	Pg11	18,8	4,5-10	20	23	6,0	20-25	100
2900.13N	Pg13,5	20,5	5 -12	22	25	6,5	20-26	50
2900.16N	Pg16	22,6	7 -13	24	27	6,5	20-27	50
2900.21N	Pg21	28,5	10 -17	30	33	7,0	24-30	50
2900.29N	Pg29	37,2	17 -25	40	45	8,0	30-37	25
2900.36N	Pg36	47,2	20 -32	50	55	8,0	38-48	10
2900.42N	Pg42	54,2	28 -38	57	63	10,0	39-48	5
2900.48N	Pg48	60,0	34 -45	67	74	15,0	40-52	5

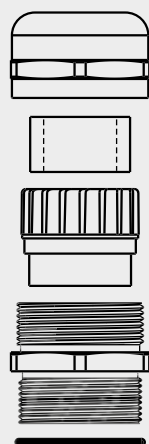
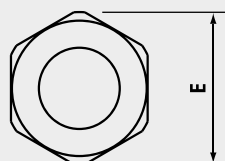
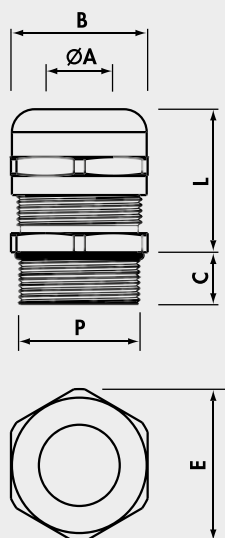

MAXIbrass® con riduzione del campo di serraggio

Passo Pg DIN 40 430

Tipo Ottone Nichelato	P	Foro Fissaggio (mm)	Ø A min-max (mm)	B Chiave (mm)	E (mm)	C (mm)	L min-max (mm)	Imballo
2910.07N	Pg 7	12,7	1 - 5	16	18	5,0	16-20	100
2910.09N	Pg 9	15,5	2 - 6	17	19	6,0	17-23	100
2910.11N	Pg11	18,8	2,5- 7	20	23	6,0	20-25	100
2910.13N	Pg13,5	20,5	4 -10	22	25	6,5	20-26	50
2910.16N	Pg16	22,6	5 -10	24	27	6,5	20-27	50
2910.21N	Pg21	28,5	6 -13	30	33	7,0	24-30	50
2910.29N	Pg29	37,2	11 -20	40	45	8,0	30-37	25
2910.36N	Pg36	47,2	18 -26	50	55	8,0	38-48	10
2910.42N	Pg42	54,2	24 -31	57	63	10,0	39-48	5
2910.48N	Pg48	60,0	27 -39	67	74	15,0	40-52	5