



Automatización Eléctrica
Especialistas en Automatización

At the end of this document you will find links to products related to this catalog. You can go directly to our shop by clicking HERE. [HERE](#)

Sleeve housing - VC-K-T1-R - 1855092

Please be informed that the data shown in this PDF Document is generated from our Online Catalog. Please find the complete data in the user's documentation. Our General Terms of Use for Downloads are valid (<http://phoenixcontact.com/download>)



Plastic sleeve housing, locking screws with knurled head, type 1, cable screw connection Pg16

Why buy this product

- Seals with two cable entries are available
- Angled cable outlet so the cable can be routed as desired, from the side and straight

Key Commercial Data

| | |
|--------------|---|
| Packing unit | 5 STK |
| GTIN |  4 017918 159290 |

Technical data

Dimensions

| | |
|--------|-------|
| Height | 65 mm |
|--------|-------|

Ambient conditions

| | |
|---------------------------------|------------------|
| Degree of protection | IP67 |
| Ambient temperature (operation) | -40 °C ... 80 °C |

General

| | |
|--|---|
| Note | When using fiber optics, the bending radii of the cable manufacturers must be observed. |
| Type | VC1 |
| Degree of protection | IP67 |
| Flammability rating according to UL 94 | V0 |
| Locking type | Screw locking, knurled head |
| Fixing screws | M4 |
| Tightening torque, mounting screw | 1.5 Nm ±0.3 Nm |
| Type of the screw connection | Pg16 |
| Pg screw connection | none |
| Cable exit | Angled |
| Housing material | Polyamide |
| Seal material | EPDM |

Sleeve housing - VC-K-T1-R - 1855092

Technical data

General

| | |
|---------------------------------|------------------|
| Ambient temperature (operation) | -40 °C ... 80 °C |
|---------------------------------|------------------|

Standards and Regulations

| | |
|--|----|
| Flammability rating according to UL 94 | V0 |
|--|----|

Classifications

eCl@ss

| | |
|------------|----------|
| eCl@ss 4.0 | 27140816 |
| eCl@ss 4.1 | 27140816 |
| eCl@ss 5.0 | 27371205 |
| eCl@ss 5.1 | 27371205 |
| eCl@ss 6.0 | 27371205 |
| eCl@ss 7.0 | 27371205 |
| eCl@ss 8.0 | 27440202 |
| eCl@ss 9.0 | 27440202 |

ETIM

| | |
|----------|----------|
| ETIM 2.0 | EC000437 |
| ETIM 3.0 | EC000437 |
| ETIM 4.0 | EC000437 |
| ETIM 5.0 | EC000437 |

UNSPSC

| | |
|---------------|----------|
| UNSPSC 6.01 | 31261501 |
| UNSPSC 7.0901 | 31261501 |
| UNSPSC 11 | 31261501 |
| UNSPSC 12.01 | 31261501 |
| UNSPSC 13.2 | 31261501 |

Approvals

Approvals

Approvals

EAC

Ex Approvals

Approvals submitted

Sleeve housing - VC-K-T1-R - 1855092

Approvals

Approval details

EAC

Drawings

Product drawing

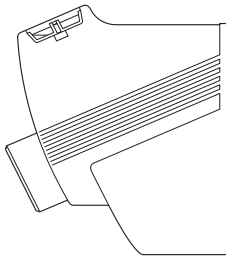

Dimensional drawing

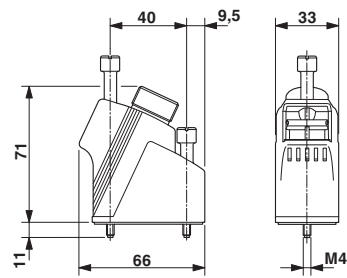

Phoenix Contact 2016 © - all rights reserved
<http://www.phoenixcontact.com>

PHOENIX CONTACT GmbH & Co. KG
Flachsmarktstr. 8
32825 Blomberg
Germany
Tel. +49 5235 300
Fax +49 5235 3 41200
<http://www.phoenixcontact.com>

Below is a list of articles with direct links to our shop Electric Automation Network where you can see:

- Quote per purchase volume in real time.
- Online documentation and datasheets of all products.
- Estimated delivery time enquiry in real time.
- Logistics systems for the shipment of materials almost anywhere in the world.
- Purchasing management, order record and tracking of shipments.

To access the product, [click on the green button.](#)

| Product | Code | Reference | Product link |
|---|---------|-----------|----------------------------|
| Plastic sleeve housing, locking screws with knurled head, type 1, cable screw connection Pg16 | 1855092 | VC-K-T1-R | Buy on EAN |