



**Automatización Eléctrica**  
Especialistas en Automatización

At the end of this document you will find links to products related to this catalog. You can go directly to our shop by clicking HERE. [HERE](#)

# Printed-circuit board connector - MC 0,5/15-G-2,54 SMD R56 - 1821821

Please be informed that the data shown in this PDF Document is generated from our Online Catalog. Please find the complete data in the user's documentation. Our General Terms of Use for Downloads are valid (<http://phoenixcontact.com/download>)

Header, Nominal current: 6 A, Rated voltage (III/2): 160 V, Number of positions: 15, Pitch: 2.54 mm, Color: black, Contact surface: Gold, Mounting: SMD soldering, Sample values available under SAMPLE MC...



The illustration shows the 10-position version

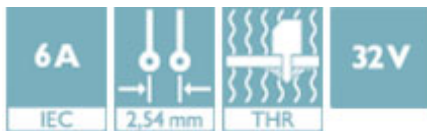

## Key Commercial Data

Packing unit	465 STK
Minimum order quantity	465 STK
GTIN	 4 046356 789981

## Technical data

### Dimensions

Length	7.1 mm
Pitch	2.54 mm
Dimension a	35.56 mm
Width	42.64 mm
Height	4.8 mm
Pin dimensions	0,64 x 0,64 mm

### General

Range of articles	MC 0,5/...-G-SMD
Insulating material group	IIIa
Rated surge voltage (III/3)	2.5 kV
Rated surge voltage (III/2)	2.5 kV
Rated surge voltage (II/2)	2.5 kV
Rated voltage (III/3)	32 V
Rated voltage (III/2)	160 V
Rated voltage (II/2)	160 V
Connection in acc. with standard	EN-VDE

# Printed-circuit board connector - MC 0,5/15-G-2,54 SMD R56 - 1821821

## Technical data

### General

Nominal current I <sub>N</sub>	6 A
Insulating material	LCP
Flammability rating according to UL 94	V0
Color	black
Number of positions	15

### Standards and Regulations

Connection in acc. with standard	EN-VDE
Flammability rating according to UL 94	V0

## Classifications

### eCl@ss

eCl@ss 4.0	272607xx
eCl@ss 4.1	27260701
eCl@ss 5.0	27260701
eCl@ss 5.1	27260701
eCl@ss 6.0	27260704
eCl@ss 7.0	27440402
eCl@ss 8.0	27440402
eCl@ss 9.0	27440402

### ETIM

ETIM 3.0	EC001121
ETIM 4.0	EC002637
ETIM 5.0	EC002637

### UNSPSC

UNSPSC 6.01	30211810
UNSPSC 7.0901	39121409
UNSPSC 11	39121409
UNSPSC 12.01	39121409
UNSPSC 13.2	39121409

## Approvals

### Approvals

---

### Approvals

cULus Recognized / VDE Gutachten mit Fertigungsüberwachung / IEC60947-5-1 CB Scheme

---

# Printed-circuit board connector - MC 0,5/15-G-2,54 SMD R56 - 1821821

## Approvals

Ex Approvals

Approvals submitted

## Approval details

cULus Recognized		
	B	C
Nominal current $I_N$	6 A	6 A
Nominal voltage $U_N$	150 V	50 V

VDE Gutachten mit Fertigungsüberwachung	
Nominal current $I_N$	6 A
Nominal voltage $U_N$	160 V

IECEE CB Scheme	
Nominal current $I_N$	6 A
Nominal voltage $U_N$	160 V

## Drawings

Drilling diagram

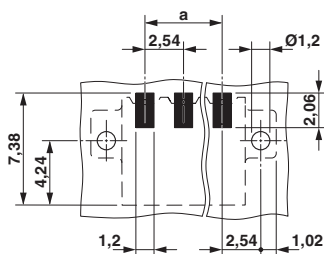

Dimensional drawing

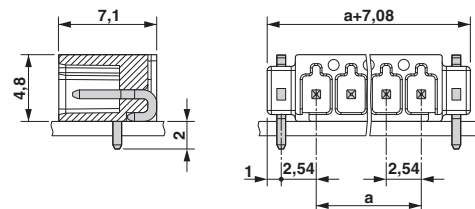

# Printed-circuit board connector - MC 0,5/15-G-2,54 SMD R56 - 1821821

Diagram

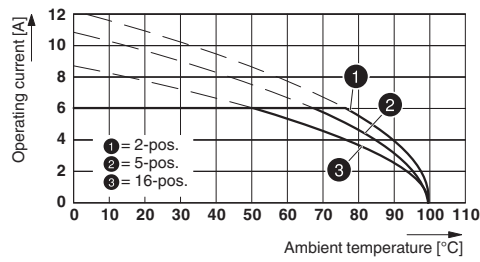

Type: FMC 0,5/...-ST-2,54 with MC 0,5/...-G-2,54 SMD R..

Phoenix Contact 2016 © - all rights reserved  
<http://www.phoenixcontact.com>

PHOENIX CONTACT GmbH & Co. KG  
Flachsmarktstr. 8  
32825 Blomberg  
Germany  
Tel. +49 5235 300  
Fax +49 5235 3 41200  
<http://www.phoenixcontact.com>



Below is a list of articles with direct links to our shop Electric Automation Network where you can see:

- Quote per purchase volume in real time.
- Online documentation and datasheets of all products.
- Estimated delivery time enquiry in real time.
- Logistics systems for the shipment of materials almost anywhere in the world.
- Purchasing management, order record and tracking of shipments.

To access the product, [click on the green button.](#)

Product	Code	Reference	Product link
Header, Nominal current: 6 A, Rated voltage (III/2): 160 V, Number of positions: 15, Pitch: 2.54 mm, Color: black, Contact surface: Gold, Mounting: Taped SMD/THT/THR components, Sample values available under SAMPLE MC...	1821821	MC 0,5/15-G-2,54 SMD R56	<a href="#">Buy on EAN</a>