



**Automatización Eléctrica**  
Especialistas en Automatización

At the end of this document you will find links to products related to this catalog. You can go directly to our shop by clicking HERE. [HERE](#)

## Printed-circuit board connector - ISPC 5/ 8-STF-7,62 - 1749036

Please be informed that the data shown in this PDF Document is generated from our Online Catalog. Please find the complete data in the user's documentation. Our General Terms of Use for Downloads are valid (<http://phoenixcontact.com/download>)

Plug component, Nominal current: 41 A, Rated voltage (III/2): 1000 V, Number of positions: 8, Pitch: 7.62 mm, Connection method: Push-in spring connection, Color: green, Contact surface: Tin



### Why buy this product

- Unlimited 600 V UL approval
- Increased vibration protection thanks to screw-on STF plugs with screw flange
- Inverted Push-in spring-cage plugs, ISPC 5 plugs with pin contacts for touch-proof device outputs (with IPC 5 G) or free-hanging cable/cable connections (with SPC 5 ST)
- STGF plugs with threaded flange



### Key Commercial Data

|              |   |
|--------------|---|
| Packing unit | 50 STK  |
| GTIN         | <br>4 046356 312691 |

### Technical data

#### Dimensions

|             |          |
|-------------|----------|
| Pitch       | 7.62 mm  |
| Dimension a | 53.34 mm |

#### General

|                                  |                |
|----------------------------------|----------------|
| Range of articles                | ISPC 5/...-STF |
| Insulating material group        | I              |
| Rated surge voltage (III/3)      | 8 kV           |
| Rated surge voltage (III/2)      | 8 kV           |
| Rated surge voltage (II/2)       | 6 kV           |
| Rated voltage (III/3)            | 1000 V         |
| Rated voltage (III/2)            | 1000 V         |
| Rated voltage (II/2)             | 1000 V         |
| Connection in acc. with standard | EN-VDE         |

# Printed-circuit board connector - ISPC 5/ 8-STF-7,62 - 1749036

## Technical data

### General

|  |                   |
|--|-------------------|
| Nominal current $I_N$                  | 41 A              |
| Nominal cross section                  | 6 mm <sup>2</sup> |
| Maximum load current                   | 41 A              |
| Insulating material                    | PA                |
| Flammability rating according to UL 94 | V0                |
| Stripping length                       | 15 mm             |
| Number of positions                    | 8                 |

### Connection data

|   |                      |
|---|----------------------|
| Conductor cross section solid min.  | 0.2 mm <sup>2</sup>  |
| Conductor cross section solid max.  | 10 mm <sup>2</sup>   |
| Conductor cross section flexible min.   | 0.2 mm <sup>2</sup>  |
| Conductor cross section flexible max.   | 6 mm <sup>2</sup>    |
| Conductor cross section flexible, with ferrule without plastic sleeve min.              | 0.25 mm <sup>2</sup> |
| Conductor cross section flexible, with ferrule without plastic sleeve max.              | 6 mm <sup>2</sup>    |
| Conductor cross section flexible, with ferrule with plastic sleeve min.                 | 0.25 mm <sup>2</sup> |
| Conductor cross section flexible, with ferrule with plastic sleeve max.                 | 4 mm <sup>2</sup>    |
| Conductor cross section AWG min.  | 24                   |
| Conductor cross section AWG max.  | 8                    |
| 2 conductors with same cross section, stranded, TWIN ferrules with plastic sleeve, min. | 0.25 mm <sup>2</sup> |
| 2 conductors with same cross section, stranded, TWIN ferrules with plastic sleeve, max. | 1.5 mm <sup>2</sup>  |
| Minimum AWG according to UL/CUL   | 24                   |
| Maximum AWG according to UL/CUL   | 8                    |

### Standards and Regulations

|  |        |
|--|--------|
| Connection in acc. with standard       | EN-VDE |
|  | CUL    |
| Flammability rating according to UL 94 | V0     |

## Classifications

### eCl@ss

|            |          |
|------------|----------|
| eCl@ss 4.0 | 272607xx |
| eCl@ss 4.1 | 27260701 |
| eCl@ss 5.0 | 27260701 |
| eCl@ss 5.1 | 27260701 |
| eCl@ss 6.0 | 27260704 |
| eCl@ss 7.0 | 27440402 |
| eCl@ss 8.0 | 27440309 |

# Printed-circuit board connector - ISPC 5/ 8-STF-7,62 - 1749036

## Classifications

### ETIM

|          |          |
|----------|----------|
| ETIM 3.0 | EC001121 |
| ETIM 4.0 | EC002638 |
| ETIM 5.0 | EC002638 |

### UNSPSC

|               |          |
|---------------|----------|
| UNSPSC 6.01   | 30211810 |
| UNSPSC 7.0901 | 39121409 |
| UNSPSC 11     | 39121409 |
| UNSPSC 12.01  | 39121409 |
| UNSPSC 13.2   | 39121409 |

## Approvals

### Approvals

#### Approvals

UL Recognized / cUL Recognized / EAC / cULus Recognized

#### Ex Approvals

#### Approvals submitted

### Approval details

| UL Recognized  |       |       |
|---|-------|-------|
|   | B     | C     |
| mm²/AWG/kcmil   | 24-8  | 24-8  |
| Nominal current I <sub>N</sub>  | 35 A  | 35 A  |
| Nominal voltage U <sub>N</sub>  | 600 V | 600 V |

| cUL Recognized  |       |       |
|--|-------|-------|
|  | B     | C     |
| mm²/AWG/kcmil  | 24-8  | 24-8  |
| Nominal current I <sub>N</sub>   | 35 A  | 35 A  |
| Nominal voltage U <sub>N</sub>   | 600 V | 600 V |

## Printed-circuit board connector - ISPC 5/ 8-STF-7,62 - 1749036

### Approvals

EAC

cULus Recognized  US

### Drawings

Dimensional drawing

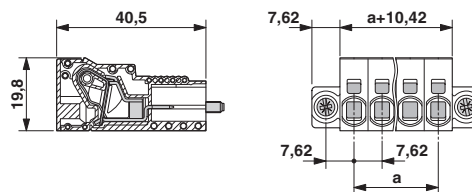

Phoenix Contact 2016 © - all rights reserved  
<http://www.phoenixcontact.com>

PHOENIX CONTACT GmbH & Co. KG  
Flachsmarktstr. 8  
32825 Blomberg  
Germany  
Tel. +49 5235 300  
Fax +49 5235 3 41200  
<http://www.phoenixcontact.com>

Below is a list of articles with direct links to our shop Electric Automation Network where you can see:

- Quote per purchase volume in real time.
- Online documentation and datasheets of all products.
- Estimated delivery time enquiry in real time.
- Logistics systems for the shipment of materials almost anywhere in the world.
- Purchasing management, order record and tracking of shipments.

To access the product, [click on the green button.](#)

| Product  | Code    | Reference          | Product link               |
|--|---------|--------------------|----------------------------|
| Plug component, Nominal current: 41 A, Rated voltage (III/2): 1000 V, Number of positions: 8, Pitch: 7.62 mm, Connection method: Push-in spring connection, Color: green, Contact surface: Tin | 1749036 | ISPC 5/ 8-STF-7,62 | <a href="#">Buy on EAN</a> |