



**Automatización Eléctrica**  
Especialistas en Automatización

At the end of this document you will find links to products related to this catalog. You can go directly to our shop by clicking [HERE](#). [HERE](#)

## Flush-type connector - SACC-CI-M12MS- 4CON-TOR 32 - 1457490

Please be informed that the data shown in this PDF Document is generated from our Online Catalog. Please find the complete data in the user's documentation. Our General Terms of Use for Downloads are valid (<http://phoenixcontact.com/download>)



Sensor/actuator flush-type plug, 4-pos., A-coded, with straight THR solder connection, only contact insert

### Why buy this product

- Reduzierte Montagekosten dank zweiteiliger Gerätesteckverbinder
- Verpackungen für automatisierte Pick- and Place-Bestückung verfügbar
- Alle gängigen Polbilder und Kodierungen verfügbar
- Einfache Geräteintegration durch mechanische Port-Verschraubungen mit Gewindefestigung, Einpresskontur oder zur direkten Integration in die Frontplatte
- Zusätzliche Abdichtung zum Gerät im ungesteckten Zustand

### Key Commercial Data

|                        |   |
|------------------------|---|
| Packing unit           | 100 STK   |
| Minimum order quantity | 100 STK   |
| GTIN                   | <br>4 046356 616256 |

### Technical data

#### Ambient conditions

|                                 |   |
|---------------------------------|---|
| Ambient temperature (operation) | -25 °C ... 85 °C (Plug / socket)                |
|                                 | -40 °C ... 85 °C (without mechanical actuation) |
| Degree of protection            | IP67  |

#### General

|                       |  |
|-----------------------|--|
| Note                  | The electrical and mechanical data specified assume that the connector pair is correctly locked and mounted. If the connector is unlocked and if there is a danger of contamination, the connector must be sealed using a protective cap > IP54. Influences arising from litz wires, cables or PCB assembly must also be taken into consideration. |
| Rated current at 40°C | 4 A  |
| Rated voltage         | 250 V  |
| Rated surge voltage   | 2.5 kV   |
| Number of positions   | 4  |
| Insulation resistance | ≥ 100 MΩ   |
| Coding                | A - standard   |

# Flush-type connector - SACC-CI-M12MS- 4CON-TOR 32 - 1457490

## Technical data

### General

|                             |                               |
|-----------------------------|-------------------------------|
| Standards/regulations       | M12 connector IEC 61076-2-101 |
| Overvoltage category        | II                            |
| Degree of pollution         | 3                             |
| Connection method           | THR solder connection         |
| Insertion/withdrawal cycles | > 100                         |
| Mounting type               | PCB mounting                  |
| Type of packaging           | Belt                          |
| Delivery state              | with assembly pad             |

### Material

|  |      |
|--|------|
| Flammability rating according to UL 94 | V0   |
| Contact material                       | CuZn |
| Contact surface material               | Au   |
| Contact carrier material               | PA6T |
| Sealing material                       | FKM  |

### Standards and Regulations

|  |                 |
|--|-----------------|
| Standard designation                   | M12 connector   |
| Standards/regulations                  | IEC 61076-2-101 |
| Flammability rating according to UL 94 | V0              |

## Classifications

### eCl@ss

|            |          |
|------------|----------|
| eCl@ss 4.0 | 27060306 |
| eCl@ss 4.1 | 27060306 |
| eCl@ss 5.0 | 27061801 |
| eCl@ss 5.1 | 27260701 |
| eCl@ss 6.0 | 27279220 |
| eCl@ss 7.0 | 27440103 |
| eCl@ss 8.0 | 27440103 |

### ETIM

|          |          |
|----------|----------|
| ETIM 3.0 | EC002061 |
| ETIM 4.0 | EC002061 |
| ETIM 5.0 | EC002061 |

### UNSPSC

|               |          |
|---------------|----------|
| UNSPSC 6.01   | 31251501 |
| UNSPSC 7.0901 | 31251501 |
| UNSPSC 11     | 31251501 |
| UNSPSC 12.01  | 31251501 |

# Flush-type connector - SACC-CI-M12MS- 4CON-TOR 32 - 1457490

## Classifications

### UNSPSC

|             |          |
|-------------|----------|
| UNSPSC 13.2 | 31251501 |
|-------------|----------|

## Approvals

### Approvals

### Approvals

UL Recognized / cUL Recognized / EAC / cULus Recognized

### Ex Approvals

### Approvals submitted

## Approval details

|                                |       |
|--------------------------------|-------|
| UL Recognized                  |       |
| mm <sup>2</sup> /AWG/kcmil     | 26-20 |
| Nominal current I <sub>N</sub> | 4 A   |
| Nominal voltage U <sub>N</sub> | 250 V |

|                                |       |
|--------------------------------|-------|
| cUL Recognized                 |       |
| mm <sup>2</sup> /AWG/kcmil     | 26-20 |
| Nominal current I <sub>N</sub> | 4 A   |
| Nominal voltage U <sub>N</sub> | 250 V |

|     |
|-----|
| EAC |
|-----|

|                  |
|------------------|
| cULus Recognized |
|------------------|

## Drawings

# Flush-type connector - SACC-CI-M12MS- 4CON-TOR 32 - 1457490

Schematic diagram

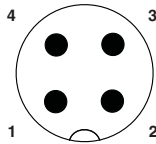

Pin assignment M12 plug, 4-pos., A-coded, view plug side

Drilling diagram

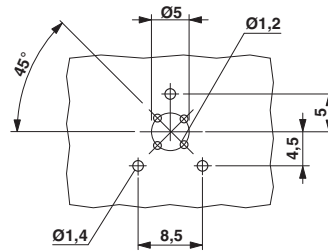

Drilling diagram

Dimensional drawing

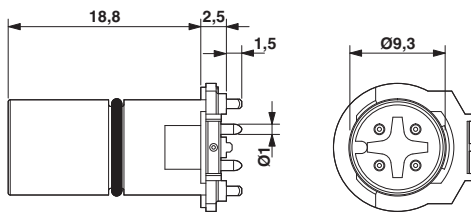

M12 male connector contact carrier

Dimensional drawing

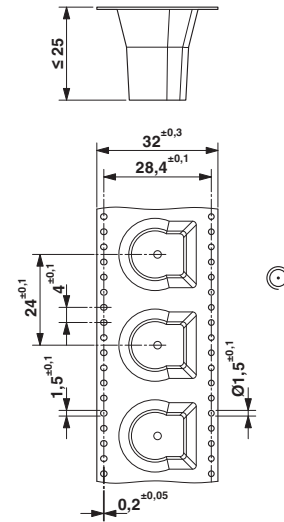

THR tape-on-reel packing



Below is a list of articles with direct links to our shop Electric Automation Network where you can see:

- Quote per purchase volume in real time.
- Online documentation and datasheets of all products.
- Estimated delivery time enquiry in real time.
- Logistics systems for the shipment of materials almost anywhere in the world.
- Purchasing management, order record and tracking of shipments.

To access the product, [click on the green button.](#)

| Product  | Code    | Reference                 | Product link               |
|--|---------|---------------------------|----------------------------|
| Sensor/actuator flush-type plug, 4-pos., A-coded, with straight THR solder connection, only contact insert | 1457490 | SACC-CI-M12MS-4CON-TOR 32 | <a href="#">Buy on EAN</a> |