



**Automatización Eléctrica**  
Especialistas en Automatización

At the end of this document you will find links to products related to this catalog. You can go directly to our shop by clicking HERE. [HERE](#)

## Flush-type connector - SACCBP-FS-8CON-M16/1,0-PUR SCO - 1419357

Please be informed that the data shown in this PDF Document is generated from our Online Catalog. Please find the complete data in the user's documentation. Our General Terms of Use for Downloads are valid  
(<http://phoenixcontact.com/download>)



Flush-type socket, shielded, 8-pos., M12, A-coded, rear/screw mounting with M16 thread, with 1 m cable, 8 x 0.25 mm<sup>2</sup>



### Key Commercial Data

|              |   |
|--------------|---|
| Packing unit | 1 STK   |
| GTIN         | <br>4 046356 533331 |

### Technical data

#### Dimensions

|  |       |
|--|-------|
| Length of cable                            | 1 m   |
| Stripping length of the free conductor end | 50 mm |

#### Ambient conditions

|                                 |                                  |
|---------------------------------|----------------------------------|
| Ambient temperature (operation) | -25 °C ... 85 °C (Plug / socket) |
| Degree of protection            | IP67                             |

#### General

|                       |  |
|-----------------------|--|
| Note                  | The electrical and mechanical data specified assume that the connector pair is correctly locked and mounted. If the connector is unlocked and if there is a danger of contamination, the connector must be sealed using a protective cap > IP54. Influences arising from litz wires, cables or PCB assembly must also be taken into consideration. |
| Rated current at 40°C | 2 A  |
| Rated voltage         | 30 V   |
| Rated surge voltage   | 0.8 kV   |
| Number of positions   | 8  |
| Insulation resistance | ≥ 100 MΩ   |
| Coding                | A - standard   |
| Standards/regulations | M12 connector IEC 61076-2-101  |
| Status display        | No   |

# Flush-type connector - SACCBP-FS-8CON-M16/1,0-PUR SCO - 1419357

## Technical data

### General

|                             |                                       |
|-----------------------------|---------------------------------------|
| Overvoltage category        | II                                    |
| Degree of pollution         | 3                                     |
| Connection method           | Individual wires                      |
| Insertion/withdrawal cycles | > 100                                 |
| Torque                      | 3 Nm ... 4 Nm (Installation-side)     |
| Mounting type               | Rear mounting M16 x 1.5 With flat nut |

### Material

|  |                              |
|--|------------------------------|
| Flammability rating according to UL 94 | V0                           |
| Contact material                       | CuZn                         |
| Contact surface material               | Au                           |
| Contact carrier material               | PA 66                        |
| Material, knurls                       | Zinc die-cast, nickel-plated |
| Sealing material                       | FKM                          |

### Cable

|   |  |
|---|--|
| Cable type                                    | PUR halogen-free black                             |
| Cable abbreviation                            | Li9Y-V1-C-V1-11Y                                   |
| Conductor cross section                       | 0.25 mm²   |
| AWG signal line                               | 24   |
| Conductor structure signal line               | 14x 0.15 mm  |
| Core diameter including insulation            | 1.15 mm ±0.07 mm                                   |
| Thickness, insulation                         | ≥ 0.21 mm  |
|   | 0.6 mm (Outer cable sheath)                        |
| Wire colors                                   | Brown, white, green, yellow, gray, pink, blue, red |
| Overall twist                                 | 8 wires around filler to the core                  |
| Shielding                                     | Braided copper wires                               |
| Optical shield covering                       | 85 %   |
| External sheath, color                        | black-gray RAL 7021                                |
| External cable diameter                       | 5.90 mm  |
| Smallest bending radius, fixed installation   | 59 mm  |
| Smallest bending radius, movable installation | 59 mm  |
| Number of bending cycles                      | 4000000  |
| Bending radius                                | 59 mm  |
| Traversing path                               | 10 m   |
| Traversing rate                               | 3 m/s  |
| Acceleration                                  | 10 m/s²  |
| Cable weight                                  | 54 kg/km   |
| Outer sheath, material                        | PUR  |
| Material, filler                              | PE   |
| Material conductor insulation                 | PP   |
| Conductor material                            | Bare Cu litz wires                                 |

# Flush-type connector - SACCBP-FS-8CON-M16/1,0-PUR SCO - 1419357

## Technical data

### Cable

|                                 |   |
|---------------------------------|---|
| Insulation resistance           | $\geq 100 \text{ G}\Omega\cdot\text{km}$  |
| Conductor resistance            | max. $78 \text{ }\Omega/\text{km}$  |
| Nominal voltage, cable          | $\leq 300 \text{ V}$  |
| Test voltage, cable             | $\geq 3000 \text{ V}$   |
| Ambient temperature (operation) | $-40 \text{ }^{\circ}\text{C} \dots 85 \text{ }^{\circ}\text{C}$ (cable, fixed installation)    |
|                                 | $-25 \text{ }^{\circ}\text{C} \dots 85 \text{ }^{\circ}\text{C}$ (cable, flexible installation) |

### Standards and Regulations

|  |                 |
|--|-----------------|
| Standard designation                   | M12 connector   |
| Standards/regulations                  | IEC 61076-2-101 |
| Flammability rating according to UL 94 | V0              |

## Classifications

### eCl@ss

|            |          |
|------------|----------|
| eCl@ss 4.0 | 27140815 |
| eCl@ss 4.1 | 27140815 |
| eCl@ss 5.0 | 27143423 |
| eCl@ss 5.1 | 27143423 |
| eCl@ss 6.0 | 27279220 |
| eCl@ss 7.0 | 27440103 |
| eCl@ss 8.0 | 27440103 |

### ETIM

|          |          |
|----------|----------|
| ETIM 2.0 | EC001297 |
| ETIM 3.0 | EC002061 |
| ETIM 4.0 | EC002061 |
| ETIM 5.0 | EC002061 |

### UNSPSC

|               |          |
|---------------|----------|
| UNSPSC 6.01   | 31251501 |
| UNSPSC 7.0901 | 31251501 |
| UNSPSC 11     | 31251501 |
| UNSPSC 12.01  | 31251501 |
| UNSPSC 13.2   | 39121413 |

## Approvals

### Approvals

Approvals

EAC

# Flush-type connector - SACCBP-FS-8CON-M16/1,0-PUR SCO - 1419357

## Approvals

Ex Approvals

Approvals submitted

## Approval details

EAC

## Drawings

Dimensional drawing

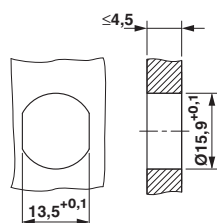

Housing cutout for M16 fastening thread, mounting panel with feed-through hole (alternatively with surface as protection against rotation)

Schematic diagram

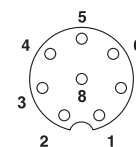

Pin assignment M12 socket, 8-pos., A-coded, view female side

Cable cross section



PUR halogen-free black [PUR]

Dimensional drawing

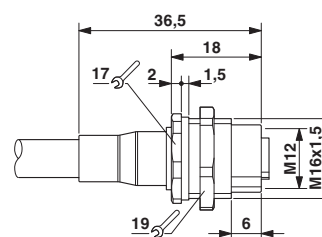

M12 flush-type connector

## Flush-type connector - SACCBP-FS-8CON-M16/1,0-PUR SCO - 1419357

Circuit diagram

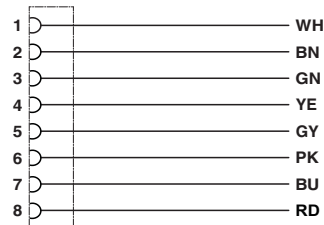

Contact assignment of the M12 socket

---

Phoenix Contact 2016 © - all rights reserved  
<http://www.phoenixcontact.com>

PHOENIX CONTACT GmbH & Co. KG  
Flachsmarktstr. 8  
32825 Blomberg  
Germany  
Tel. +49 5235 300  
Fax +49 5235 3 41200  
<http://www.phoenixcontact.com>

Below is a list of articles with direct links to our shop Electric Automation Network where you can see:

- Quote per purchase volume in real time.
- Online documentation and datasheets of all products.
- Estimated delivery time enquiry in real time.
- Logistics systems for the shipment of materials almost anywhere in the world.
- Purchasing management, order record and tracking of shipments.

To access the product, [click on the green button.](#)

| Product  | Code    | Reference                      | Product link               |
|--|---------|--------------------------------|----------------------------|
| Flush-type socket, shielded, 8-pos., M12, A-coded, rear/screw mounting with M16 thread, with 1 m cable, 8 x 0.25 mm <sup>2</sup> | 1419357 | SACCBP-FS-8CON-M16/1,0-PUR SCO | <a href="#">Buy on EAN</a> |