



Automatización Eléctrica
Especialistas en Automatización

At the end of this document you will find links to products related to this catalog. You can go directly to our shop by clicking HERE. [HERE](#)

AC charging cable - EV-T1M3C-1AC32A-4,0M6,0ESBK00 - 1409952

Please be informed that the data shown in this PDF Document is generated from our Online Catalog. Please find the complete data in the user's documentation. Our General Terms of Use for Downloads are valid (<http://phoenixcontact.com/download>)

AC charging cable with Vehicle Connector (including protective cap) and open cable end, Type 1, IEC 62196-2, SAE J1772, 32 A / 250 V (AC), Cable data: 4 m, black, straight



Product Description

AC charging cable, with Vehicle Connector and open cable end for fast charging electric vehicles with alternating current (AC) via a type 1 Vehicle Inlet, for installation at charging stations (EVSE)

Key Commercial Data

| | |
|--------------|---|
| Packing unit | 1 STK |
| GTIN |  4 046356 885447 |

Technical data

Product definition

| | |
|--------------------------|--|
| Product type | AC charging cable with Vehicle Connector (including protective cap) and open cable end |
| Standards/regulations | IEC 62196-2 |
| | SAE J1772 |
| Charging standard | Type 1 |
| Charging mode | Mode 3 |
| Type of charging current | AC single-phase |

Dimensions

| | |
|------------------|-----|
| Conductor length | 4 m |
|------------------|-----|

Features

| | |
|-----------------------------------|------------------------|
| Charging power | 8 kW |
| Number of phases | 1 |
| Rated current for power contacts | 32 A |
| Rated voltage for power contacts | 250 V AC |
| Rated current for signal contacts | 2 A |
| Rated voltage for signal contacts | 30 V AC |
| Type of signal transmission | Pulse width modulation |
| Number of power contacts | 3 (L1, N, PE) |
| Number of signal contacts | 2 (CP, CS) |

AC charging cable - EV-T1M3C-1AC32A-4,0M6,0ESBK00 - 1409952

Technical data

Features

| | |
|---|---------------------------------------|
| Connection method | Crimp connection, cannot be separated |
| Resistor coding | 480 Ω (Lever actuated) |
| | 150 Ω (Lever not actuated) |
| Insertion force | < 75 N |
| Withdrawal force | < 75 N |
| Insertion/withdrawal cycles | > 10000 |
| Ambient temperature (operation) | -30 °C ... 50 °C (Operation) |
| Ambient temperature (storage/transport) | -40 °C ... 80 °C (Storage) |
| Altitude difference for area of application | 5000 m (above sea level) |
| Degree of protection | IP44 (plugged in) |
| | IP54 (Protective cap) |

Cable

| | |
|-------------------------|--|
| Cable structure | 3 x 6.0 mm ² + 1 x 0.5 mm ² (DIN EN 13602, VDE 0295 class 5) |
| External cable diameter | 13.9 mm ±0.5 mm |
| Type of conductor | straight |
| Outer sheath, material | PUR |
| External sheath, color | black |
| Minimum bending radius | 69.2 mm (5 x diameter) |

Classifications

eCl@ss

| | |
|------------|----------|
| eCl@ss 5.1 | 27260701 |
| eCl@ss 6.0 | 27279220 |
| eCl@ss 8.0 | 27440590 |
| eCl@ss 9.0 | 27144705 |

ETIM

| | |
|----------|----------|
| ETIM 4.0 | EC002839 |
| ETIM 5.0 | EC002839 |

Drawings

AC charging cable - EV-T1M3C-1AC32A-4,0M6,0ESBK00 - 1409952

Connection diagram

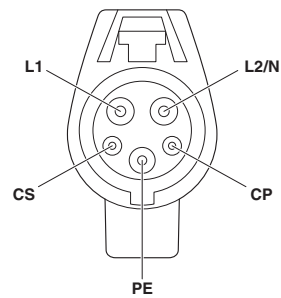

Pin assignment of the Vehicle Connector

Dimensional drawing

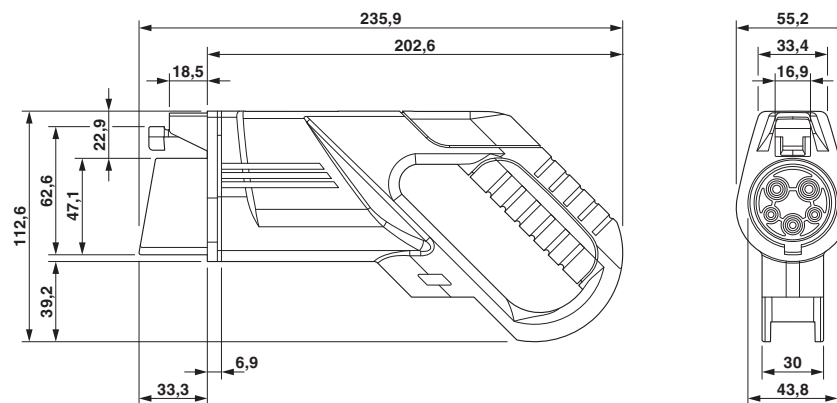

Dimensional drawing of Vehicle Connector

AC charging cable - EV-T1M3C-1AC32A-4,0M6,0ESBK00 - 1409952

Schematic diagram

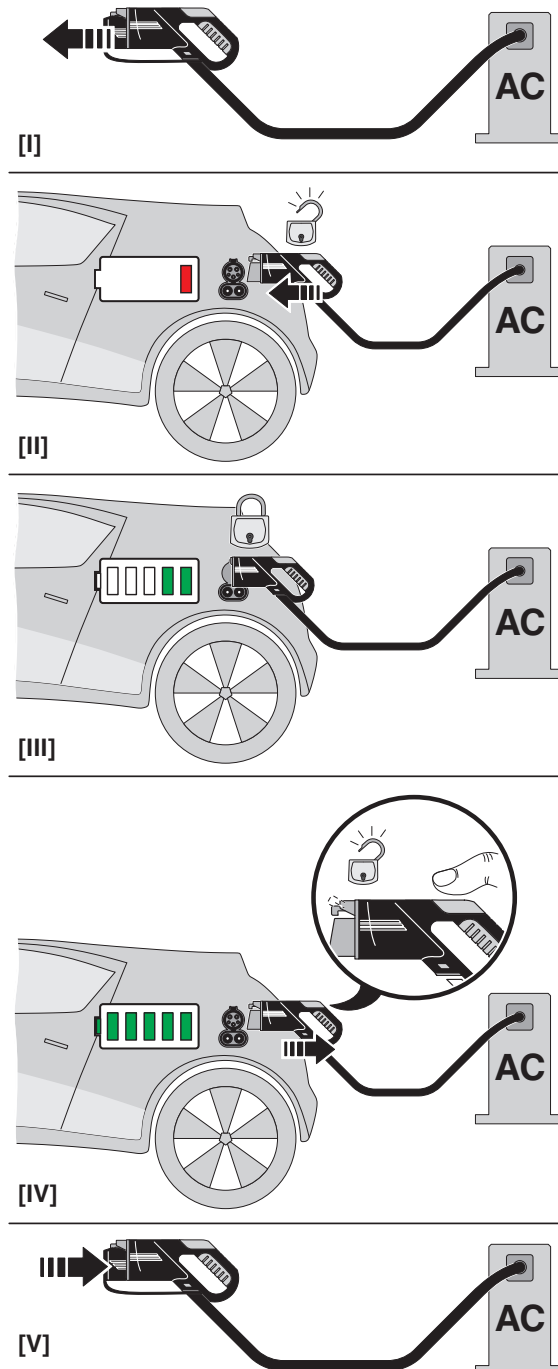

Phoenix Contact 2016 © - all rights reserved
<http://www.phoenixcontact.com>

PHOENIX CONTACT GmbH & Co. KG
Flachsmarktstr. 8
32825 Blomberg
Germany
Tel. +49 5235 300
Fax +49 5235 3 41200
<http://www.phoenixcontact.com>

Below is a list of articles with direct links to our shop Electric Automation Network where you can see:

- Quote per purchase volume in real time.
- Online documentation and datasheets of all products.
- Estimated delivery time enquiry in real time.
- Logistics systems for the shipment of materials almost anywhere in the world.
- Purchasing management, order record and tracking of shipments.

To access the product, [click on the green button.](#)

| Product | Code | Reference | Product link |
|---|---------|-------------------------------|----------------------------|
| AC charging cable with Vehicle Connector (including protective cap) and open cable end, Type 1, IEC 62196-2, SAE J1772, 32 A / 250 V (AC), Cable data: 4 m, black, straight | 1409952 | EV-T1M3C-1AC32A-4,0M6,0ESBK00 | Buy on EAN |