

## Wiring- and labor-saving design allows side-by-side configuration for up to sixteen units

Up to sixteen amplifiers can be connected in a side-by-side configuration. As the sub cable contains only one output line, a great amount of wiring and space can be saved. Also, special 'sliding' connectors have been provided for all main and sub cables, which can be detached merely by releasing the lock and pulling directly back, without having to slide the main amplifier body to the side. Using this connector system, only a minimal amount of space is required for regular maintenance.

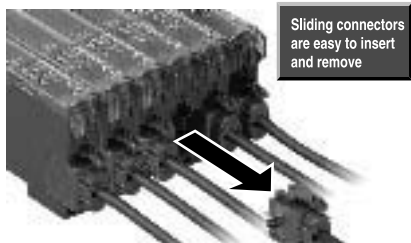

## Easy operation with MODE NAVI

MODE NAVI uses six indicators to display the amplifier's basic operations.

The current operating mode can be confirmed at a glance, so even a first time user can easily operate the amplifier without becoming confused.



MODE NAVI (MODE indicators)

## Simple operation with easy access to advanced functions

Each mode can be selected using the large MODE key. Detailed functions and settings can be chosen using the large jog switch. Each setting mode can be easily confirmed by viewing the MODE indicator display.

The advanced features available in each mode can be easily viewed and smoothly selected from the digital display.

## Two switches with distinct functions

Only two switches, the large jog switch and the large MODE key, are required for operation. Depressing the large MODE key sets the 'mode selection' and 'mode cancel' functions. The large jog switch is used to select from the detailed functions available within each mode, as well as to change numerical values after the mode has been chosen. The use of only two switches makes for very simple operations and easy maintenance.

### Large MODE key



Pressing the switch selects or cancels the operating mode

### Large jog switch

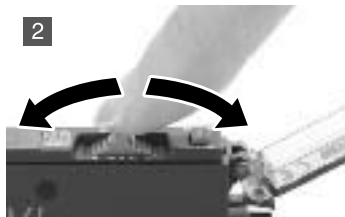

Moving the switch from side to side allows items to be selected

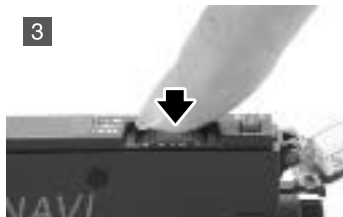

Pressing the switch then confirms the selected setting

## ORDER GUIDE

**Amplifiers** Quick-connection cable is not supplied with the amplifier. Please order it separately.

Type	Appearance	Model No.	Emitting element	Output
NPN output		<b>FX-301-F</b>	Red LED	NPN open-collector transistor
PNP output		<b>FX-301P-F</b>		PNP open-collector transistor

**Quick-connection cables** Quick-connection cable is not supplied with the amplifier. Please order it separately.

Type	Model No.	Description	
Main cable	<b>CN-73-C1</b>	Length: 1 m 3.281 ft	0.15 mm <sup>2</sup> 3-core cabtyre cable, with connector on one end Cable outer diameter: $\phi$ 3.0 mm $\phi$ 0.118 in
	<b>CN-73-C2</b>	Length: 2 m 6.562 ft	
	<b>CN-73-C5</b>	Length: 5 m 16.404 ft	
Sub cable	<b>CN-71-C1</b>	Length: 1 m 3.281 ft	0.15 mm <sup>2</sup> 1-core cabtyre cable, with connector on one end Cable outer diameter: $\phi$ 3.0 mm $\phi$ 0.118 in
	<b>CN-71-C2</b>	Length: 2 m 6.562 ft	
	<b>CN-71-C5</b>	Length: 5 m 16.404 ft	

### Main cable

• CN-73-C□

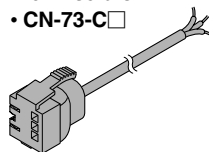

### Sub cable

• CN-71-C□

