



Automatización Eléctrica

Especialistas en Automatización

At the end of this document you will find links to products related to this catalog. You can go directly to our shop by clicking HERE. [HERE](#)

Complete GE2 service outlet without floor covering recess, with protective contact socket

Mounting support for the installation of data sockets in GE2, 1 x Type K



Type	Pack.	Weight	Item No.
	pcs	kg/100 pcs.	
MTGE2 1K	1	4.400	7407 85 0

V2A Stainless steel, grade 304 /pc.
 Mounting support to incorporate an audio or video technology connection socket, type XLR SPEAK-ON type D.
 Suitable for service outlet GE2 without recess.

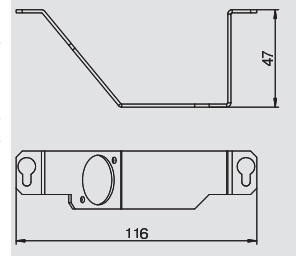

Mounting support for the installation of data sockets in GE2, 2 x Type LE



Type	Pack.	Weight	Item No.
	pcs	kg/100 pcs.	
MTGE2 2LE	1	4.800	7407 67 9

V2A Stainless steel, grade 304 /pc.
 Mounting support to accept two data connection modules of the following types: LexCom 125 and 250.
 Dimensions of a mounting opening in mm: 18.30 x 17.20.
 Suitable for service outlet GE2 without recess.

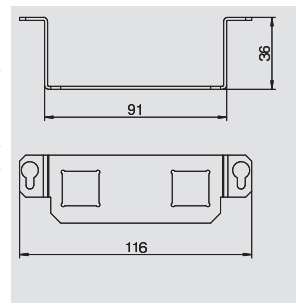

Mounting support for installation of Modul 45® in GE2, 1/2 module width



Type	Pack.	Weight	Item No.
	pcs	kg/100 pcs.	
MTGE2 0.5M	1	5.100	7407 60 1

V2A Stainless steel, grade 304 /pc.
 Mounting support to accept a Modul 45® accessory with 1/2 width. Suitable for GE2 installation unit without floor covering recess.

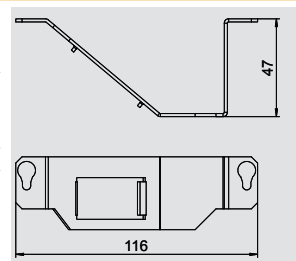

Snap-in data connection module, Cat. 5e, unshielded



Type	Pack.	Weight	Item No.
	pcs	kg/100 pcs.	
ASM-C5 S	1	1.120	6117 34 7

Connection module Cat. 5e unshielded, with a RJ45 slot. Including a dust cover, a cable tie, a snap-in fastening frame and mounting instructions. Suitable for installation in support plates, type MTM 2C and MTM 3C, mounting plate type MPR2 2C, mounting support type MTGE2 2C, MTGE2 15 2C and MTGE2 F 2C.

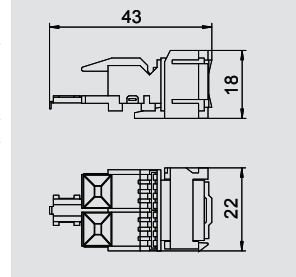

Snap-in data connection module, Cat. 5e, shielded



Type	Pack.	Weight	Item No.
	pcs	kg/100 pcs.	
ASM-C5 GS	1	1.920	6117 34 3

Connection module Cat. 5e shielded, with a RJ45 slot. Including an EMC screen hood, a dust cover, a cable tie, a snap-in fastening frame and mounting instructions. Suitable for installation in support plates, type MTM 2C and MTM 3C, mounting plate type MPR2 2C, mounting support type MTGE2 2C, MTGE2 15 2C and MTGE2 F 2C.

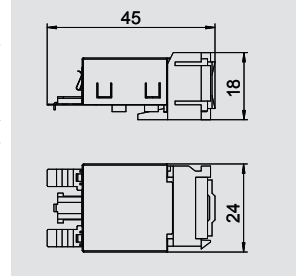

Snap-in data connection module, Cat. 6, unshielded



Type	Pack.	Weight	Item No.
	pcs	kg/100 pcs.	
ASM-C6 S	1	1.060	6117 34 9

Connection module Cat. 6 unshielded, with a RJ45 slot. Including a dust cover, a cable tie, a snap-in fastening frame and mounting instructions. Suitable for installation in support plates, type MTM 2C and MTM 3C, mounting plate type MPR2 2C, mounting support type MTGE2 2C, MTGE2 15 2C and MTGE2 F 2C.

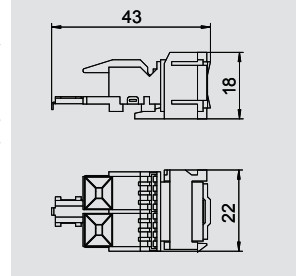



Below is a list of articles with direct links to our shop Electric Automation Network where you can see:

- Quote per purchase volume in real time.
- Online documentation and datasheets of all products.
- Estimated delivery time enquiry in real time.
- Logistics systems for the shipment of materials almost anywhere in the world.
- Purchasing management, order record and tracking of shipments.

To access the product, [click on the green button](#).

Product	Code	Reference	Product link
Connection module CAT6 snap-in unscreened,	6117349	ASM-C6 S	Buy on EAN