

- Blinds ensure that the detectors' detection area is adapted to the local circumstances. Sources of interference or unwanted areas can be eliminated from the area subject to motion detection. Cover blinds are already supplied as standard. Additional blinds can be ordered separately if required.

Blinds for B.E.G. motion detectors

- LUXOMAT® RC-plus next (limitation of detection angle) – Part. no. 32697**

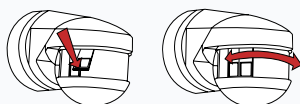

RC-plus next with blinds

Blinds for B.E.G. occupancy detectors

- LUXOMAT® PD2, PD4 – SM-version – Part. no. 92260**



The blinds have nominal breaks at regular distances. The detection area can therefore be accurately adapted to your needs.



Example PD4-SM



PD4-SM with blinds

- LUXOMAT® PD4 – FC- and FM-version – Part. no. 32701**



The blinds have nominal breaks at regular distances. The detection area can therefore be accurately adapted to your needs.

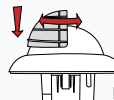

Example PD4-FM



PD4-FM with blinds

- LUXOMAT® Mini occupancy detector PD9 – Part. no. 32702**

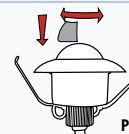

PD9-FC



PD9-FC with blinds

- LUXOMAT® Mini occupancy detector PD9-GH for great heights – Part. no. 33207**

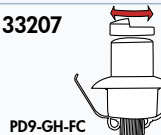

PD9-GH-FC



PD9-GH-FC with blind

- LUXOMAT® Indoor 180 – Part. no. 33233**

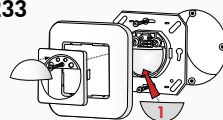

1 to mask recording below the mounting height (to prevent small animals being detected)



Indoor 180 with blind