

LUXOMAT® Ecolight 18-/26-WB Automatic



18-WB white



18-WB black



26-WB black



26-WB white

TECHNICAL DATA

- 230V~ ±10%
- IP44 / Class II / CE
- 18-WB**
L 100 x W 220 x H 960 mm
- 26-WB**
L 100 x W 220 x H 1050 mm
- 25°C to +50°C
- made of high-quality and UV-resistant polycarbonate

Lamps

- 18-WB** PL18W/G24q-2
Luminous flux 1.200 lm
- 26-WB** PL26W/G24q-3
Luminous flux 1.800 lm

Channel 1 (light control)

- 2 - 2000Lux

PRODUCT INFORMATION

- **LUXOMAT®** Ecolight 18-WB and Ecolight 26-WB for wall bracket installation
- Twilight switch may be continuously varied
- Approx. 80% lower energy consumption when an 18 W energy-saving lamp is used compared with a 100 W conventional lamp
- Energy-saving lamps last longer: around 12,000 hours compared with conventional lamps (approx. 1,000 hours); therefore very low maintenance costs
- Very low intrinsic heating due to the electronic ballast's minimal dissipation loss
- Very high light yield thanks to special reflectors
- **Application examples:**
façade lighting, company signs, general lighting

▶ Wiring diagrams on page 79!

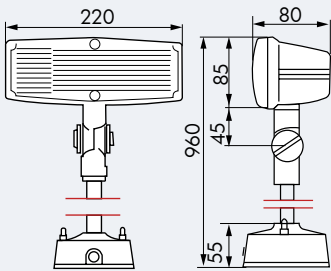

Ecolight 18-WB

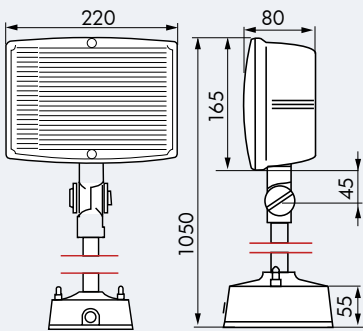

Ecolight 26-WB

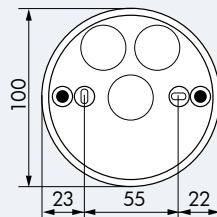

Mounting socket

Light distribution Ecolight 18 W

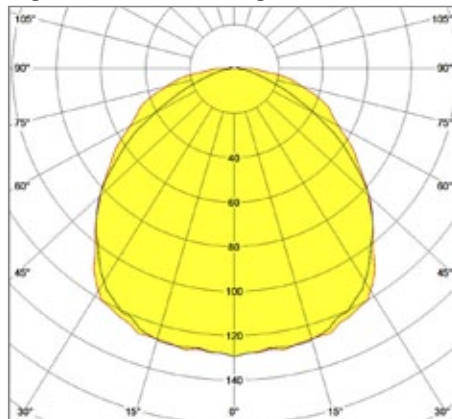

Light distribution Ecolight 26 W

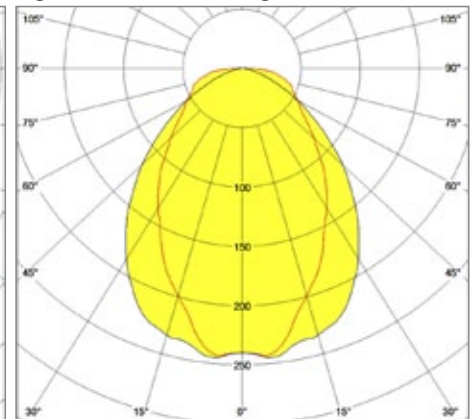

Energy and environment balance sheet see page 42

Description	Colour	Part number
Ecolight 18-WB Automatic	black	21050
Ecolight 18-WB Automatic	white	21055
Ecolight 26-WB Automatic	black	22050
Ecolight 26-WB Automatic	white	22055



OUTDOOR FLOODLIGHTS