



Proximity switch, capacitive, Sn=5mm, 4L, 10-30VDC, 1W, quad.20, metal, line 2m



Powering Business Worldwide™

Part no. LSC-Q20M-F5-LD
 Catalog No. 282003
 Alternate Catalog No. -
 EL-Nummer (Norway) 4356223

Delivery program

Contacts	N/O = normally open contact, C/O = changeover contact, P = programmable as N/C or N/O		N/O
Rated switching distance	S _n	mm	5
Rated operating voltage	U _e	V DC	10 - 30
Maximum load current	I _e	mA	200
Style		mm	32 x 20 x 8
Housing			Metal
Terminal connection			2 m connection cable
Fitting in metal			Flush

Technical data

General

Standards			IEC/EN 60947-5-2
Ambient temperature			25 - +70
Degree of Protection			IP67
Shock resistance Shock duration 11 ms		g	30

Characteristics

Rated switching distance			
Flush	S _n	mm	5
Non-flush	S _n	mm	5
Repetition accuracy of S _n		%	2
Temperature drift of S _n		%	< 20
Switching hysteresis of S _n		%	20
Rated operating voltage	U _e	V DC	10 - 30
Residual ripple of U _e		%	≤ 10
Operating current in the switched state at 24 V DC	I _b	mA	15
Maximum load current	I _e	mA	< 200
Voltage drop at I _e	U _d	V	1.8
Max. operating frequency (resistive load)	f	Hz	≤ 100
Residual current through the load in the blocked state at 230 V AC and 24 V DC	I _r	mA	0.1
Switching state display		LED	Yellow
Operating voltage display		LED	red
Short-circuit protective device, protection against polarity reversal			●
Output function			
Three-wire			●
Make contact			●
Style			
Threaded barrel		mm	32 x 20 x 8
Rectangular housing			●
Connection options			
Cable, open			●

Enclosure material			
Metal			GdZn

Design verification as per IEC/EN 61439

Technical data for design verification			
Operating ambient temperature min.		°C	25
Operating ambient temperature max.		°C	70

Dimensions

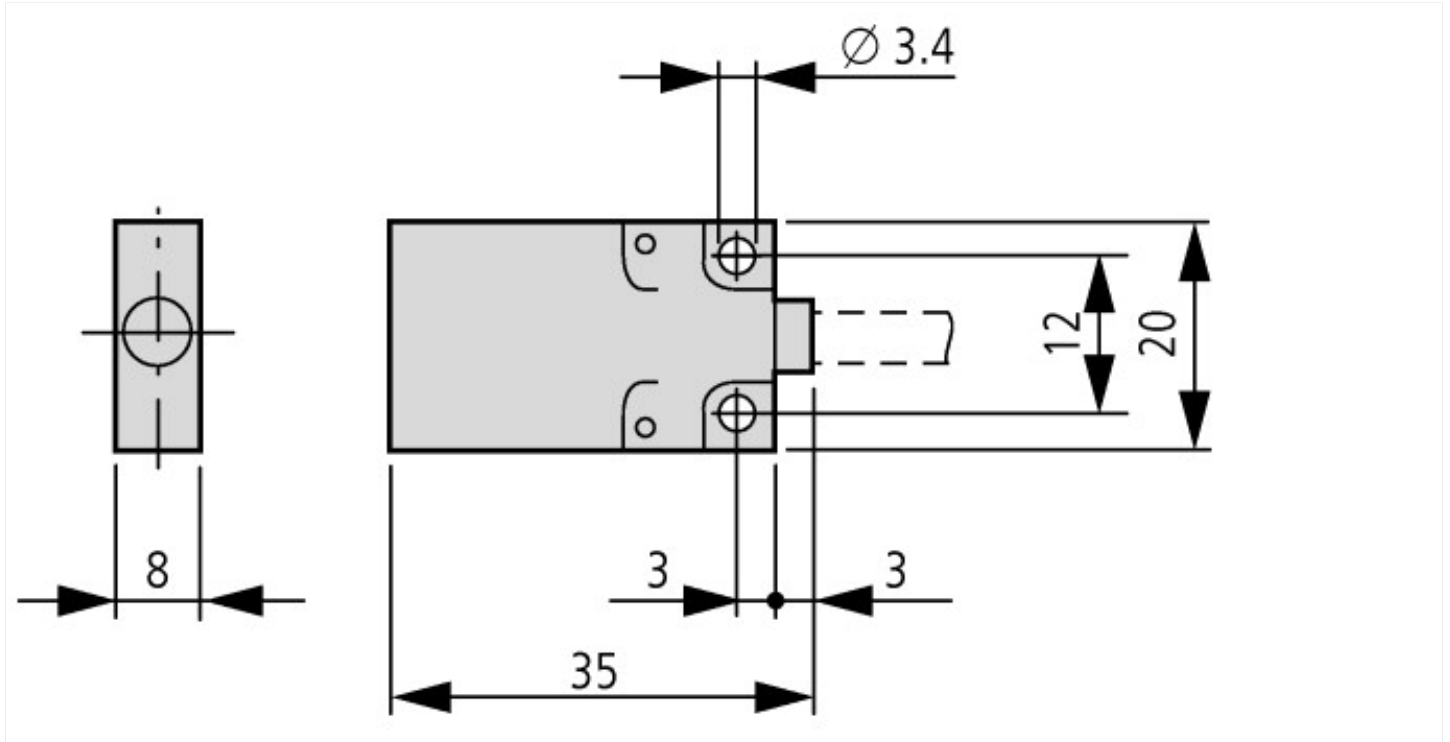

Assets (links)

Instruction Leaflets

21570404

Additional product information (links)

AWA1360-2157 Capacitive Proximity Switches

AWA1360-2157 Capacitive Proximity Switches ftp://ftp.moeller.net/DOCUMENTATION/AWA_INSTRUCTIONS/21570404.pdf