

Type: **DILET11-M-A**
 Article No.: **048886**
 Sales text **TIMING RELAY DILET**

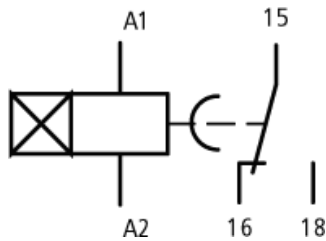

| Ordering information | | | |
|---------------------------------|----------|---|-----------------------------------------------------------------------------------------------------------------------------|
| Description | | | Timing relays, On-delayed |
| Rated operational current AC-11 | | | |
| 220 V 230 V 240 V | I_e | A | 3 |
| 380 V 400 V 440 V | I_e | A | 3 |
| Conventional thermal current | I_{th} | A | 6 |
| Time range | | | 0.15 – 3 s 0.5 – 10 s 3 – 60 s u0.15 – 3 min 0.5 – 10 min 3 – 60 min 0.15 – 3 h 0.5 – 10 h 3 – 60 h |
| Function | | | fixed 11, On-delayed |

Terminal marking according to EN 50042



Notes concerning the product group

| Part no. suffix | Actuating voltage | |
|-----------------|-------------------|--------------------|
| | V DC | V AC |
| -A | 24 – 240 | 24 – 240, 50/60 Hz |
| -W | – | 400, 50/60 Hz |

Permissible cable length Connection to
Cable unscreened, with
cable cross-section 0.5 Y1/Y2, Z1/Z2
– 1.5 mm

Two-core cable 250 m

Two-core cable in the
same cable duct with
mains cable, 50/60 Hz 50 m

| Accessories | Page |
|-----------------|--------------------------|
| Time functions | → Engineering |
| Sealable shroud | → 010482 |
| Potentiometer | → 229491 |
| Screw adapter | → 095853 |
| Blade terminals | → 059904 |

| General | | | |
|----------------------|------------|---------------|---------------------------------------------------------------------------------------|
| Standards | | | IEC/EN 60947, VDE 0660, UL, CSA IEC/EN 60255, VDE 0435 |
| Lifespan, mechanical | | | |
| AC operated | Operations | $\times 10^6$ | 30 |
| DC operated | Operations | $\times 10^6$ | 30 |
| Climatic proofing | | | Damp heat, constant, to IEC 60068-2-78; Damp heat, cyclic, to IEC 60068-2-30 |
| Ambient temperature | | | |
| Open | | °C | -20...60 |
| Enclosed | | °C | -20...45 |
| Mounting position | | | As required |

| | | | |
|-----------------------------------------------------|-----------|-----------------|--------------------------------------|
| Mechanical shock resistance (IEC/EN 60068-2-27) | | | |
| Half-sinusoidal shock, 20 ms | | | |
| Make contact | | g | 4 |
| Degree of protection | | | |
| Terminals | | | IP 20 |
| Weight | | kg | 0,09 |
| Terminal capacities | | | |
| Solid | | mm ² | 1 × (0.75 – 2.5) 2 × (0.75 – 2.5) |
| Flexible with ferrule | | mm ² | 1 × (0.75 – 1.5) 2 × (0.75 – 1.5) |
| Solid or stranded | | AWG | 1 × (18 – 14) |
| Contacts | | | |
| Rated impulse withstand voltage | U_{imp} | V AC | 6000 |
| Overtoltage category/pollution degree | | | III/2 |
| Rated insulation voltage | U_i | V AC | 600 |
| Rated operational voltage | U_e | V AC | 440 |
| Safe isolation to VDE 0106 Part 101 and Part 101/A1 | | | |
| between coil and auxiliary contacts | | V AC | 250 |
| between the auxiliary contacts | | V AC | 250 |
| Making capacity | | | |
| AC-14 $\cos = 0.3$ 440 V | | A | 48 |
| AC-15 $\cos = 0.3$ 220 V | | A | 50 |
| DC-11 L/R – 40 ms | | × I_e | 1,1 |
| Breaking capacity | | | |
| AC-14 $\cos = 0.3$ 440 V | | A | 3 |
| AC-15 $\cos = 0.3$ 220 V | | A | 3 |
| DC-11 L/R – 40 ms | | × I_e | 1,1 |
| Rated operational current | | | |
| AC-14 | | | |
| 440 V | I_e | A | 3 |
| AC-15 | | | |
| 220 V | I_e | A | 3 |
| DC-11 | | | |
| L/R max. 15 ms | | | |
| 24 V | I_e | A | 1,5 |
| L/R max. 50 ms | | A | 1,2 |

| | | | |
|--------------------------------------|----------|------------|---|
| Conv. thermal current | I_{th} | A | 6 |
| Short-circuit rating without welding | | | |
| Max. fuse, make contacts | | A gG/gL | 6 |
| Max. fuse, break contacts | | A gG/gL | 6 |

Magnet systems

| | | | |
|---------------------------------------|--|-------|------|
| Power consumption | | | |
| Pick-up AC | | VA | 2 |
| Sealing AC | | VA | 2 |
| Pick-up DC | | W | 1,8 |
| Sealing DC | | W | 1,8 |
| Duty factor | | % DF | 100 |
| Maximum operating frequency | | Ops/h | 4000 |
| Minimum command time | | | |
| AC | | ms | 50 |
| DC | | ms | 30 |
| Repetition accuracy (deviation) | | % | 0,5 |
| Recovery time (after 100% time delay) | | ms | 70 |

Notes

| | | |
|--------------|--|------------------------------------------------------------------------------------------------------------------------------------------------------------------------------------------|
| Notes | | <p>Making and breaking conditions to DC-13, time constant as stated</p> <p>When supplied directly from mains or transformer > 1000 VA</p> <p>Not DILET...-W</p> <p>ETR4-51: 50 ms</p> |
|--------------|--|------------------------------------------------------------------------------------------------------------------------------------------------------------------------------------------|

Dimensions



DILET...

Dimensions

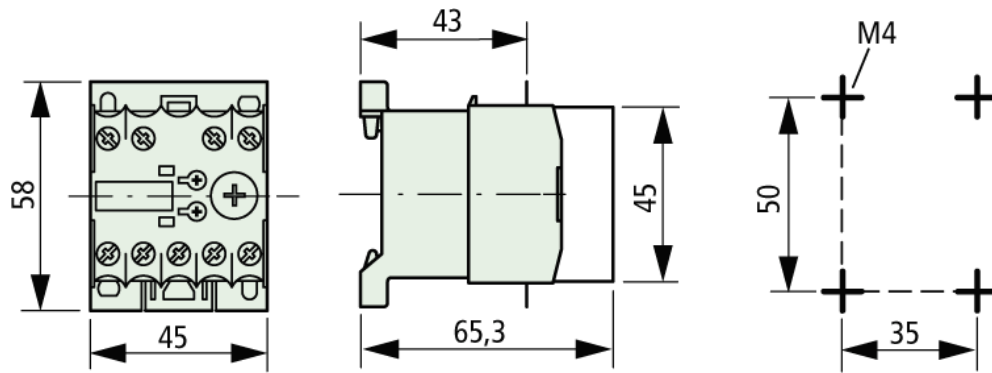

DILET... + HDILE
Electronic timing relay with sealable shroud

Characteristic curve

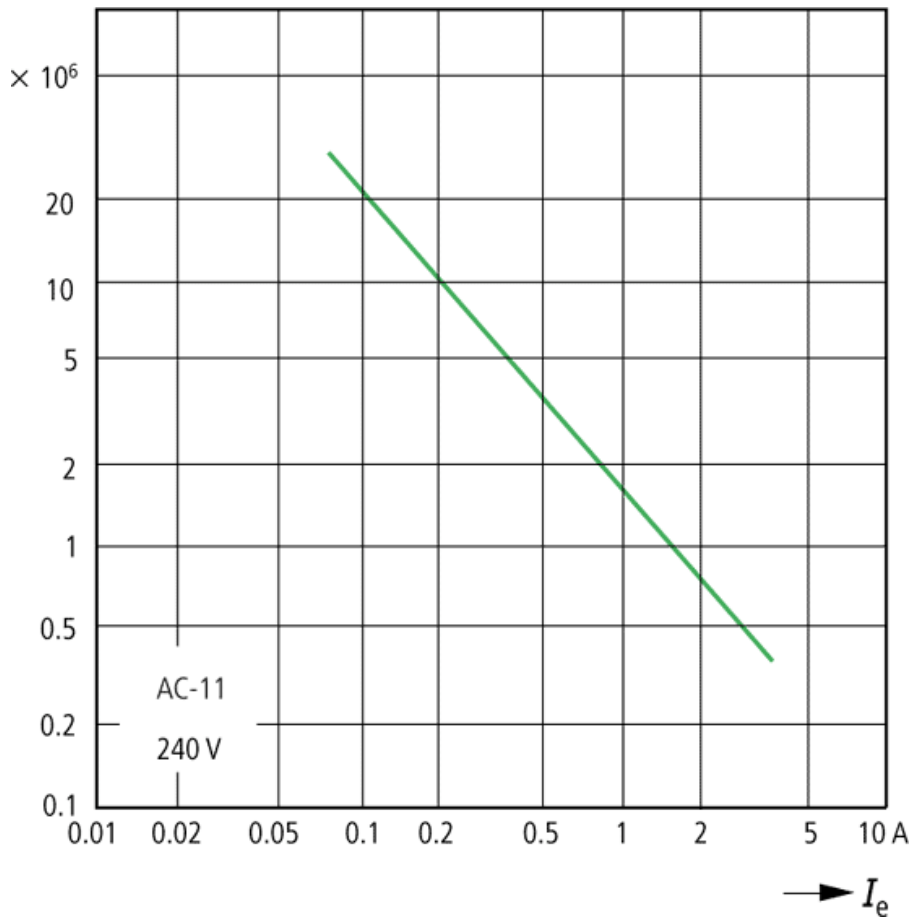

Component lifespan (operations)
 I_e = Rated operational current

Moeller GmbH, Hein-Moeller-Str. 7-11, D-53115 Bonn
E-Mail: catalog@moeller.net, Internet: www.moeller.net, <http://catalog.moeller.net>
HPL-C2007G V2.1 © 2007 by Moeller GmbH