



IP 66 | TYPE 4, 12, 13 | IK 10



The mild steel single door wall mounted range, MAP, with a IP 66 protection degree, comprises enclosures with a horizontally hinged door plus top and bottom gland plate openings. Each of these enclosures can be easily combined with another wall mounted enclosure, which allows for the creation of configurations with two compartments with individual access. Water and dust are prevented from entering the enclosure, thus eliminating the risk for component failure, and with that, unnecessary downtime.

Material: Body: 1.5 mm mild steel. Gland plate: 1.4 mm mild steel. Door: 1.5 mm mild steel MAP0306030R5 / 2 mm MAP0308030R5 and above. Mounting plate: 2 mm galvanized steel.

Body: Folded and seam welded. Four 8.5 mm diameter holes for wall fixing, pressed out in 20.4 mm diameter x 2 mm depressions, to allow air circulation around the rear part of the enclosure.

Front panel: Surface mounted with 130° opening. Concealed removable hinges with captive pin. Hinges can be mounted to allow top or bottom opening. Mechanical door stop keeps the panel open. Inner M6 welded studs. One removable mounting profile on the hinge side. Sealing is ensured by an injected one piece polyurethane gasket.

Lock: Customized lock with double-bit for easy opening of the panel. Double-bit 3 mm insert and 90° movement. Other inserts are available as an accessory.

Mounting plate: The mounting plate is marked vertically at 10 mm intervals, for easy horizontal positioning of equipment. On the top and bottom there are holes to facilitate cable fixing. Fixed onto M8 press welded studs to the rear of the enclosure. All sides, from 800 mm and above, are strengthened by folded edges.

Gland Plate Opening: In top and bottom. Situated at the far rear of the enclosure, to make cabling onto the mounting plate easier. Gland plates (AF) and gaskets (AG) are not included. If the MAP panel is to be combined to an MAS or MAD enclosure, then the gland plate from the MAS/MAD enclosure can be used with the MAP panel.

Protection: Mounted stand alone, complies with IP 66 | TYPE 4, 12, 13 | IK 10, providing you mount the gland plate(s) and gasket(s), supplied as an accessory. Combined with MAS or MAD, complies with IP 55 | TYPE 12.

Finish: RAL 7035 structured powder coating.

Delivery: Enclosure with panel and one panel mounting profile. Plastic double-bit 3 mm key and mounting accessories. Earthing facilities.

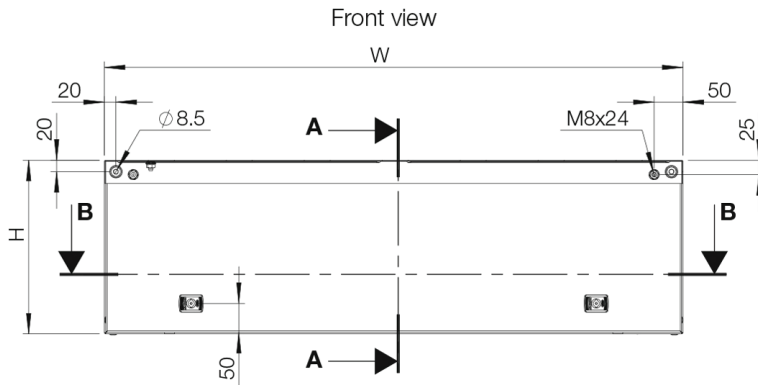

Sectional side view

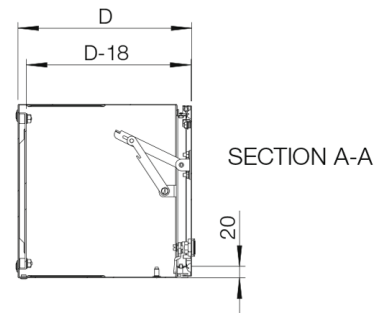

Sectional top view

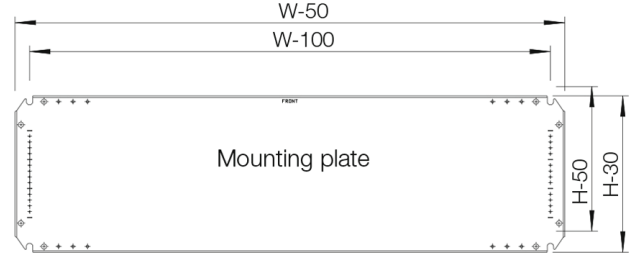
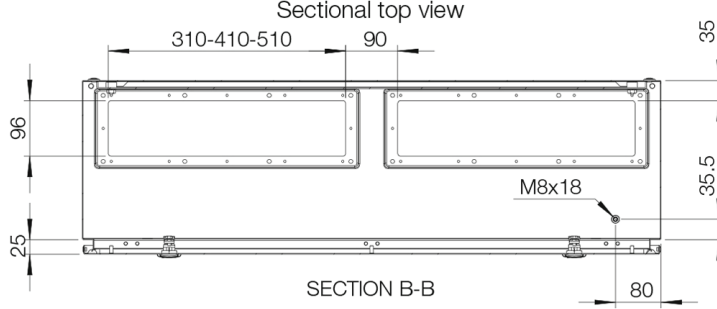

Inside panel view

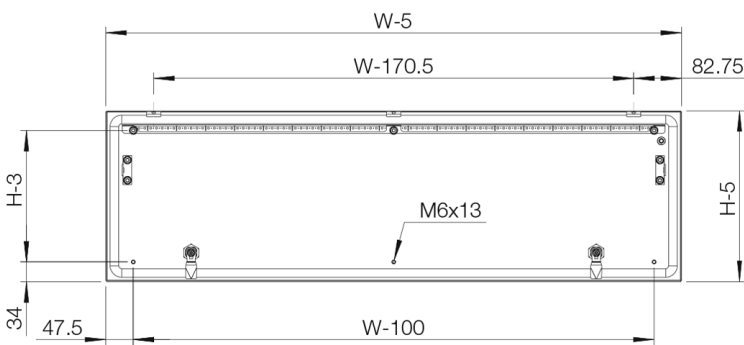

With mounting plate

Enclosure dimensions			Mounting plate dimensions		Usable depth	Gland plate				
H	W	D	h	w	d	Size	Type	Openings	N° of locks	Item no.
300	600	300	270	550	282	510 × 96	4	1 + 1	2	
300	800	300	270	750	282	310 × 96	2	2 + 2	2	
300	1000	300	270	950	282	410 × 96	3	2 + 2	2	
300	1200	300	270	1150	282	510 × 96	4	2 + 2	2	

Without mounting plate

Enclosure dimensions			Gland plate						
H	W	D	Size	Type	Openings	N° of locks	Item no.		
300	600	300	510 × 96	4	1 + 1	2	MAP0306030PER5		
300	800	300	310 × 96	2	2 + 2	2	MAP0308030PER5		
300	1000	300	410 × 96	3	2 + 2	2	MAP0310030PER5		
300	1200	300	510 × 96	4	2 + 2	2	MAP0312030PER5		

MAP

Mild steel panel