

2A-M

CAPICORDA PER APPLICAZIONI GRAVOSE

per conduttori in rame



File no. E125401

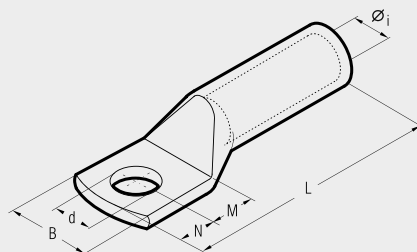

I capicorda della serie 2 A-M sono studiati per impieghi gravosi e per la messa a terra di strutture ed apparecchiature sia in ambienti chiusi che all'esterno.

Sono ricavati da tubo di rame elettrolitico di sezione tale da garantire sia una buona connessione elettrica che un'adeguata resistenza meccanica alla trazione; sono ricotti e protetti superficialmente mediante stagnatura elettrolitica.

Hanno il colletto dimensionato in modo da ricevere più pressate; sono inoltre privi del foro d'ispezione per evitare l'infiltrazione di umidità e di agenti atmosferici e quindi adatti anche per installazioni all'aperto.

Ogni capicorda riporta incisi:

- marchio di fabbrica e numero di catalogo Cembre.
- natura e sezione del conduttore (mm²).
- Ø della vite (mm).

A richiesta possono essere forniti i capicorda della serie 2A-2M con attacco a due fori.



Sezione Conduttore mm²	Ø Vite mm	Tipo	Dimensioni mm						Imballo standard/ minimo	Utensili Meccanici		Utensili Oleodinamici										
			Øi	B	M	N	L	d		HN5	HN25	TN 71	TN 70	TN 120 S*	B 35-45MD B 35-50MD	HT 45	HT 51	RH 50 B 500	HT 81-U RHU 81	HT 120 ed utensili e teste della linea 130 kN	ECW-H3D	DHL LEO
16	8	2 A 3-M 8	5,8	15,0	9,0	8,0	43,5	8,4	600/100													
	10	2 A 3-M10	5,8	18,0	11,0	10,0	47,5	10,5	500/100													
25	8	2 A 5-M 8	7,0	15,0	9,0	8,0	51,0	8,4	400/100													
	10	2 A 5-M 10	7,0	18,0	11,0	10,0	55,0	10,5	300/50													
35	12	2 A 5-M 12	7,0	21,0	14,0	12,0	60,0	13,2	300/50													
	8	2 A 7-M 8	8,9	17,0	9,0	8,0	53,0	8,4	250/50													
50	10	2 A 7-M 10	8,9	19,0	11,0	10,0	57,0	10,5	250/50													
	12	2 A 7-M 12	8,9	21,0	14,0	12,0	62,0	13,2	200/50													
63	10	2 A 10-M 10	10,0	20,0	11,0	10,0	63,0	10,5	200/50													
	12	2 A 10-M 12	10,0	21,0	14,0	12,0	68,0	13,2	150/50													
70	14	2 A 10-M 14	10,0	25,0	16,0	14,0	72,0	15,0	150/50													
	16	2 A 10-M 16	10,0	26,0	18,0	16,0	76,0	17,0	150/50													
95	10	2 A 14-M 10	11,3	21,0	11,0	10,0	70,0	10,5	100/50													
	12	2 A 14-M 12	11,3	22,0	14,0	12,0	75,0	13,2	100/50													
120	14	2 A 14-M 14	11,3	25,0	16,0	14,0	79,0	15,0	100/50													
	16	2 A 14-M 16	11,3	26,0	18,0	16,0	83,0	17,0	100/50													
125	10	2 A 19-M 10	13,5	25,0	11,0	10,0	76,5	10,5	75/25													
	12	2 A 19-M 12	13,5	25,0	14,0	12,0	81,5	13,2	75/25													
150	14	2 A 19-M 14	13,5	25,0	16,0	14,0	85,5	15,0	75/25													
	16	2 A 19-M 16	13,5	27,0	18,0	16,0	90,5	17,0	75/25													
185	20	2 A 19-M 20	13,5	29,5	22,0	20,0	97,5	21,0	75/25													
	10	2 A 24-M 10	15,2	28,5	11,0	10,0	82,0	10,5	50/25													
240	12	2 A 24-M 12	15,2	28,5	14,0	12,0	87,0	13,2	50/25													
	14	2 A 24-M 14	15,2	28,5	16,0	14,0	91,0	15,0	50/25													
300	16	2 A 24-M 16	15,2	28,5	18,0	16,0	95,0	17,0	50/25													
	20	2 A 24-M 20	15,2	30,0	22,0	20,0	103,0	21,0	50/25													
330	10	2 A 30-M 10	16,7	31,5	13,0	11,0	92,0	10,5	50/25													
	12	2 A 30-M 12	16,7	31,5	16,0	14,0	98,0	13,2	30/15													
360	14	2 A 30-M 14	16,7	31,5	18,0	16,0	102,0	15,0	30/15													
	16	2 A 30-M 16	16,7	31,5	19,0	17,0	104,0	17,0	30/15													
400	20	2 A 30-M 20	16,7	31,5	22,0	20,0	110,0	21,0	30/15													
	12	2 A 37-M 12	19,2	35,5	16,0	14,0	108,0	13,2	30/15													
480	14	2 A 37-M 14	19,2	35,5	18,0	16,0	112,0	15,0	30/15													
	16	2 A 37-M 16	19,2	35,5	19,0	17,0	114,0	17,0	30/15													
540	20	2 A 37-M 20	19,2	35,5	22,0	20,0	120,0	21,0	30/15													
	12	2 A 48-M 12	21,1	39,0	16,0	14,0	109,0	13,2	20/5													
600	14	2 A 48-M 14	21,1	39,0	18,0	16,0	113,0	15,0	20/5													
	16	2 A 48-M 16	21,1	39,0	19,0	17,0	115,0	17,0	20/5													
660	20	2 A 48-M 20	21,1	39,0	22,0	20,0	121,0	21,0	25/5													
	12	2 A 60-M 12	23,7	44,0	20,0	14,0	129,5	13,2	20/5													
720	14	2 A 60-M 14	23,7	44,0	22,0	16,0	133,5	15,0	20/5													
	16	2 A 60-M 16	23,7	44,0	22,0	19,0	136,5	17,0	20/5													
780	20	2 A 60-M 20	23,7	44,0	24,0	23,0	142,5	21,0	20/5													
	12	2 A 80-M 12	27,0	51,0	22,0	19,0	140,0	13,2	15/5													
840	14	2 A 80-M 14	27,0	51,0	22,0	19,0	140,0	15,0	10/5													
	16	2 A 80-M 16	27,0	51,0	22,0	19,0	140,0	17,0	10/5													
900	20	2 A 80-M 20	27,0	51,0	24,0	23,0	146,0	21,0	15/5													
	16	2 A 100-M 16♦	30,3	56,5	22,0	19,0	147,0	17,0	10/1													
960	20	2 A 100-M 20♦	30,3	56,5	24,0	23,0	153,0	21,0	10/1													
	16	2 A 120-M 16♦	33,4	61,5	22,0	19,0	159,0	17,0	20/1													
1020	20	2 A 120-M 20♦	33,4	61,5	24,0	23,0	165,0	21,0	20/1													
	20	2 A 160-M 20♦	38,0	72,0	24,0	23,0	187,0	21,0	12/1													
1000	20	2 A 200-M 20♦	44,0	80,0	24,0	23,0	202,0	21,0	6/1													

*Vedi pag 123

*Prodotto non marcato UL