



**Automatización Eléctrica**  
Especialistas en Automatización

At the end of this document you will find links to products related to this catalog. You can go directly to our shop by clicking [HERE](#). [HERE](#)

## Base strip - EMCV 1,5/16-GF-3,5 - 1911305

Please be informed that the data shown in this PDF Document is generated from our Online Catalog. Please find the complete data in the user's documentation. Our General Terms of Use for Downloads are valid (<http://phoenixcontact.com/download>)

Header, Nominal current: 8 A, Rated voltage (III/2): 160 V, Number of positions: 16, Pitch: 3.5 mm, Color: green, Contact surface: Tin, Mounting: Press-in technology



The figure shows a 10-position version of the product

### Why buy this product

- Press-in tools available on request
- Pin strips with ERNI-PRESS flexible press-in zone
- Plug-in direction horizontal and vertical to the PCB
- Processing according to EN 60352-5



### Key Commercial Data

|              |                     |
|--------------|---------------------|
| Packing unit | 50 STK              |
| GTIN         | <br>4 017918 176051 |

### Technical data

#### Dimensions

|                          |              |
|--------------------------|--------------|
| Length                   | 7.25 mm      |
| Pitch                    | 3.50 mm      |
| Dimension a              | 52.5 mm      |
| Constructional height    | 10 mm        |
| Length of the solder pin | 3.8 mm       |
| Pin dimensions           | 0,8 x 0,8 mm |
| Hole diameter            | 1.45 mm      |

#### General

|                             |                 |
|-----------------------------|-----------------|
| Range of articles           | EMCV 1,5/...-GF |
| Insulating material group   | IIIa            |
| Rated surge voltage (III/3) | 2.5 kV          |

# Base strip - EMCV 1,5/16-GF-3,5 - 1911305

## Technical data

### General

|  |        |
|--|--------|
| Rated surge voltage (III/2)            | 2.5 kV |
| Rated surge voltage (II/2)             | 2.5 kV |
| Rated voltage (III/3)                  | 160 V  |
| Rated voltage (III/2)                  | 160 V  |
| Rated voltage (II/2)                   | 250 V  |
| Connection in acc. with standard       | EN-VDE |
| Nominal current I <sub>N</sub>         | 8 A    |
| Maximum load current                   | 8 A    |
| Insulating material                    | PBT    |
| Flammability rating according to UL 94 | V0     |
| Color                                  | green  |
| Number of positions                    | 16     |

### Standards and Regulations

|  |        |
|--|--------|
| Connection in acc. with standard       | EN-VDE |
|  | CUL    |
| Flammability rating according to UL 94 | V0     |

## Classifications

### eCl@ss

|            |          |
|------------|----------|
| eCl@ss 4.0 | 272607xx |
| eCl@ss 4.1 | 27260701 |
| eCl@ss 5.0 | 27260701 |
| eCl@ss 5.1 | 27260701 |
| eCl@ss 6.0 | 27260704 |
| eCl@ss 7.0 | 27440402 |
| eCl@ss 8.0 | 27440402 |
| eCl@ss 9.0 | 27440402 |

### ETIM

|          |          |
|----------|----------|
| ETIM 3.0 | EC001121 |
| ETIM 4.0 | EC002637 |
| ETIM 5.0 | EC002637 |

### UNSPSC

|               |          |
|---------------|----------|
| UNSPSC 6.01   | 30211810 |
| UNSPSC 7.0901 | 39121409 |
| UNSPSC 11     | 39121409 |
| UNSPSC 12.01  | 39121409 |
| UNSPSC 13.2   | 39121409 |

# Base strip - EMCV 1,5/16-GF-3,5 - 1911305

## Approvals

Approvals

---

Approvals

EAC / cULus Recognized

---

Ex Approvals

---

Approvals submitted

---

## Approval details

|     |
|-----|
| EAC |
|-----|

|                                |       |       |
|--------------------------------|-------|-------|
| cULus Recognized               |       |       |
|                                | B     | D     |
| Nominal current I <sub>N</sub> | 8 A   | 8 A   |
| Nominal voltage U <sub>N</sub> | 300 V | 300 V |

## Drawings

Dimensional drawing

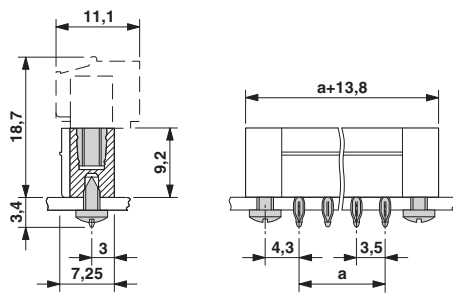

Drilling diagram

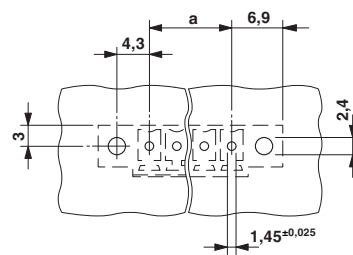

## Base strip - EMCV 1,5/16-GF-3,5 - 1911305

### Drilling diagram

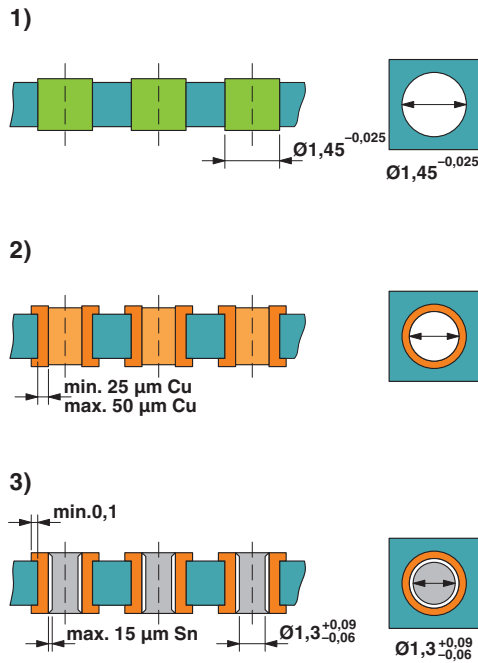

Drill hole layout in FR4 or EP-GC basic material

Phoenix Contact 2016 © - all rights reserved  
<http://www.phoenixcontact.com>

PHOENIX CONTACT GmbH & Co. KG  
Flachsmarktstr. 8  
32825 Blomberg  
Germany  
Tel. +49 5235 300  
Fax +49 5235 3 41200  
<http://www.phoenixcontact.com>



**Automatización Eléctrica**  
Especialistas en Automatización

Below is a list of articles with direct links to our shop Electric Automation Network where you can see:

- Quote per purchase volume in real time.
- Online documentation and datasheets of all products.
- Estimated delivery time enquiry in real time.
- Logistics systems for the shipment of materials almost anywhere in the world.
- Purchasing management, order record and tracking of shipments.

To access the product, [click on the green button.](#)

| <b>Product</b>   | <b>Code</b> | <b>Reference</b>   | <b>Product link</b>        |
|--|-------------|--------------------|----------------------------|
| Header, Nominal current: 8 A, Rated voltage (III/2): 160 V, Number of positions: 16, Pitch: 3.5 mm, Color: green, Contact surface: Tin, Mounting: Press-in | 1911305     | EMCV 1,5/16-GF-3,5 | <a href="#">Buy on EAN</a> |