



**Automatización Eléctrica**  
Especialistas en Automatización

At the end of this document you will find links to products related to this catalog. You can go directly to our shop by clicking [HERE](#). [HERE](#)

# Printed-circuit board connector - MC 0,5/10-G-2,54 P20 THR R44 - 1821326

Please be informed that the data shown in this PDF Document is generated from our Online Catalog. Please find the complete data in the user's documentation. Our General Terms of Use for Downloads are valid (<http://phoenixcontact.com/download>)

Header, Nominal current: 6 A, Rated voltage (III/2): 160 V, Number of positions: 10, Pitch: 2.54 mm, Color: black, Contact surface: Gold, Mounting: THR soldering, Sample values available under SAMPLE MC...



## Key Commercial Data

|                        |                     |
|------------------------|---------------------|
| Packing unit           | 465 STK             |
| Minimum order quantity | 465 STK             |
| GTIN                   | <br>4 046356 789486 |

## Technical data

### Dimensions

|                          |                |
|--------------------------|----------------|
| Length                   | 7.1 mm         |
| Pitch                    | 2.54 mm        |
| Dimension a              | 22.86 mm       |
| Width                    | 29.94 mm       |
| Height                   | 4.8 mm         |
| Length of the solder pin | 2 mm           |
| Pin dimensions           | 0,64 x 0,64 mm |
| Hole diameter            | 1.2 mm         |

### General

|                             |                  |
|-----------------------------|------------------|
| Range of articles           | MC 0,5/...-G-THR |
| Insulating material group   | IIIa             |
| Rated surge voltage (III/3) | 2.5 kV           |
| Rated surge voltage (III/2) | 2.5 kV           |
| Rated surge voltage (II/2)  | 2.5 kV           |
| Rated voltage (III/3)       | 32 V             |
| Rated voltage (III/2)       | 160 V            |

# Printed-circuit board connector - MC 0,5/10-G-2,54 P20 THR R44 - 1821326

## Technical data

### General

|  |        |
|--|--------|
| Rated voltage (II/2)                   | 160 V  |
| Connection in acc. with standard       | EN-VDE |
| Nominal current I <sub>N</sub>         | 6 A    |
| Insulating material                    | LCP    |
| Flammability rating according to UL 94 | V0     |
| Color                                  | black  |
| Number of positions                    | 10     |

### Standards and Regulations

|  |        |
|--|--------|
| Connection in acc. with standard       | EN-VDE |
| Flammability rating according to UL 94 | V0     |

## Classifications

### eCl@ss

|            |          |
|------------|----------|
| eCl@ss 4.0 | 272607xx |
| eCl@ss 4.1 | 27260701 |
| eCl@ss 5.0 | 27260701 |
| eCl@ss 5.1 | 27260701 |
| eCl@ss 6.0 | 27260704 |
| eCl@ss 7.0 | 27440402 |
| eCl@ss 8.0 | 27440402 |
| eCl@ss 9.0 | 27440402 |

### ETIM

|          |          |
|----------|----------|
| ETIM 3.0 | EC001121 |
| ETIM 4.0 | EC002637 |
| ETIM 5.0 | EC002637 |

### UNSPSC

|               |          |
|---------------|----------|
| UNSPSC 6.01   | 30211810 |
| UNSPSC 7.0901 | 39121409 |
| UNSPSC 11     | 39121409 |
| UNSPSC 12.01  | 39121409 |
| UNSPSC 13.2   | 39121409 |

## Approvals

### Approvals

# Printed-circuit board connector - MC 0,5/10-G-2,54 P20 THR R44 - 1821326

## Approvals

### Approvals

cULus Recognized / VDE Gutachten mit Fertigungsüberwachung / IEC60320 CB Scheme

### Ex Approvals

### Approvals submitted

## Approval details

|                                |       |      |
|--------------------------------|-------|------|
| cULus Recognized               |       |      |
|                                | B     | C    |
| Nominal current I <sub>N</sub> | 6 A   | 6 A  |
| Nominal voltage U <sub>N</sub> | 150 V | 50 V |

|   |       |
|---|-------|
| VDE Gutachten mit Fertigungsüberwachung |       |
| Nominal current I <sub>N</sub>          | 6 A   |
| Nominal voltage U <sub>N</sub>          | 160 V |

|                                |       |
|--------------------------------|-------|
| IECEE CB Scheme                |       |
| Nominal current I <sub>N</sub> | 6 A   |
| Nominal voltage U <sub>N</sub> | 160 V |

## Drawings

Drilling diagram

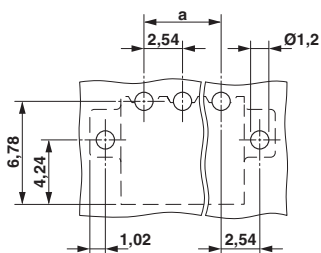

Dimensional drawing

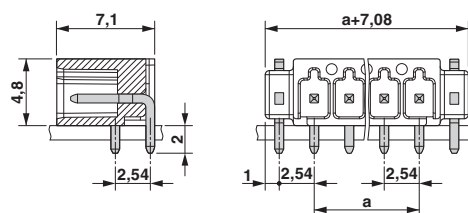

## Printed-circuit board connector - MC 0,5/10-G-2,54 P20 THR R44 - 1821326

Diagram

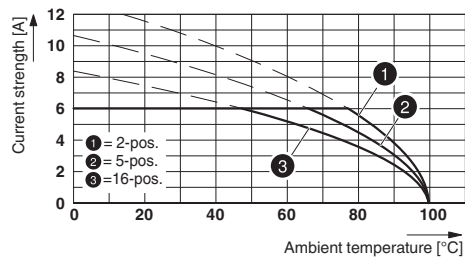

Type: FMC 0,5/...-ST-2,54 with MC 0,5/...-G-2,54 P20 THR R..

Phoenix Contact 2016 © - all rights reserved  
<http://www.phoenixcontact.com>

PHOENIX CONTACT GmbH & Co. KG  
Flachsmarktstr. 8  
32825 Blomberg  
Germany  
Tel. +49 5235 300  
Fax +49 5235 3 41200  
<http://www.phoenixcontact.com>

Below is a list of articles with direct links to our shop Electric Automation Network where you can see:

- Quote per purchase volume in real time.
- Online documentation and datasheets of all products.
- Estimated delivery time enquiry in real time.
- Logistics systems for the shipment of materials almost anywhere in the world.
- Purchasing management, order record and tracking of shipments.

To access the product, [click on the green button.](#)

| <b>Product</b>  | <b>Code</b> | <b>Reference</b>             | <b>Product link</b>        |
|---|-------------|------------------------------|----------------------------|
| Header, Nominal current: 6 A, Rated voltage (III/2): 160 V, Number of positions: 10, Pitch: 2.54 mm, Color: black, Contact surface: Gold, Mounting: Taped SMD/ THT/THR components, Sample values available under SAMPLE MC... | 1821326     | MC 0,5/10-G-2,54 P20 THR R44 | <a href="#">Buy on EAN</a> |