



**Automatización Eléctrica**  
Especialistas en Automatización

At the end of this document you will find links to products related to this catalog. You can go directly to our shop by clicking [HERE](#). [HERE](#)

# Membrane screw connection - MG-INC-M25-M67L-PTES-LG - 1415188

Please be informed that the data shown in this PDF Document is generated from our Online Catalog. Please find the complete data in the user's documentation. Our General Terms of Use for Downloads are valid (<http://phoenixcontact.com/download>)



Membrane screw connection, Cable gland material: Polypropylene, Application: Standard, External cable diameter 9 mm ... 17 mm, Shielding: No, Connecting thread: M25, Color: lightgrey RAL 7035

## Key Commercial Data

Packing unit	20 STK
Minimum order quantity	20 STK
GTIN	 4 055626 038025

## Technical data

### Dimensions

Length	15 mm
Length without connecting thread	7 mm
Connecting thread diameter	25 mm
Hexagon angular dimension GRP	40 mm
Length of the connecting thread	8 mm
External cable diameter	9 mm ... 17 mm

### Ambient conditions

Degree of protection	IP66
	IP67
Ambient temperature (operation)	-40 °C ... 65 °C

### General

Cable gland material	Polypropylene
Seal material	TPE
Shielded	No
Thread type on connection side	M25
Color	light grey RAL 7035
	lightgrey RAL 7035

# Membrane screw connection - MG-INC-M25-M67L-PTES-LG - 1415188

## Classifications

eCl@ss

eCl@ss 5.1	27149109
eCl@ss 6.0	27149109
eCl@ss 8.0	27379218

ETIM

ETIM 5.0	EC002024
----------	----------

## Drawings

Dimensional drawing

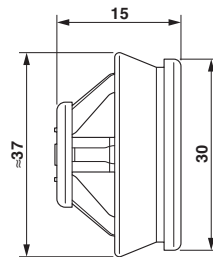

Phoenix Contact 2016 © - all rights reserved  
<http://www.phoenixcontact.com>

PHOENIX CONTACT GmbH & Co. KG  
Flachsmarktstr. 8  
32825 Blomberg  
Germany  
Tel. +49 5235 300  
Fax +49 5235 3 41200  
<http://www.phoenixcontact.com>

Below is a list of articles with direct links to our shop Electric Automation Network where you can see:

- Quote per purchase volume in real time.
- Online documentation and datasheets of all products.
- Estimated delivery time enquiry in real time.
- Logistics systems for the shipment of materials almost anywhere in the world.
- Purchasing management, order record and tracking of shipments.

To access the product, [click on the green button.](#)

<b>Product</b>	<b>Code</b>	<b>Reference</b>	<b>Product link</b>
Membrane screw connection, Cable gland material: Polypropylene, Application: Standard, External cable diameter 9 mm ... 17 mm, Shielding: No, Connecting thread: M25, Color: lightgrey RAL 7035	1415188	MG-INC-M25-M67L-PTES-LG	<a href="#">Buy on EAN</a>