



Automatización Eléctrica
Especialistas en Automatización

At the end of this document you will find links to products related to this catalog. You can go directly to our shop by clicking [HERE](#). [HERE](#)

Cable sleeve - CES-LRG-BK-25 - 0801640

Please be informed that the data shown in this PDF Document is generated from our Online Catalog. Please find the complete data in the user's documentation. Our General Terms of Use for Downloads are valid (<http://phoenixcontact.com/download>)

Large, slotted cable sleeves suitable for cables with a diameter of 24 ... 25 mm, material: NBR



Product Description

Slotted sleeves for accommodating pre-assembled cables and lines with a diameter of 24 ... 25 mm, can be used in CES sealing frames. When fitted, the sleeves also ensure strain relief according to DIN EN 50262.

Key Commercial Data

| | |
|--------------|---|
| Packing unit | 10 STK |
| GTIN |  4 046356 674355 |

Technical data

Dimensions

| | |
|-------------------------|--------------------|
| External cable diameter | 1x 24 mm ... 25 mm |
| Length | 53 mm |
| Width | 39 mm |
| Height | 17 mm |

Ambient conditions

| | |
|---------------------------------|---|
| Degree of protection | IP54 (for sealing frames with screw locking. IP44 sealing frames with locking latch.) |
| Ambient temperature (operation) | -40 °C ... 125 °C (static) |

General

| | |
|---------------------|--|
| Product description | Slotted sleeves for accommodating pre-assembled cables and lines with a diameter of 24 ... 25 mm, can be used in CES sealing frames. When fitted, the sleeves also ensure strain relief according to DIN EN 50262. |
| No. of conductors | 1 |
| Material | NBR |
| Color | black |

Cable sleeve - CES-LRG-BK-25 - 0801640

Classifications

eCl@ss

| | |
|------------|----------|
| eCl@ss 4.0 | 27081002 |
| eCl@ss 4.1 | 27081002 |
| eCl@ss 5.0 | 27081002 |
| eCl@ss 5.1 | 27081002 |
| eCl@ss 6.0 | 27081002 |
| eCl@ss 7.0 | 27081002 |
| eCl@ss 8.0 | 27069220 |

ETIM

| | |
|----------|----------|
| ETIM 3.0 | EC000879 |
| ETIM 4.0 | EC000451 |
| ETIM 5.0 | EC000451 |

UNSPSC

| | |
|---------------|----------|
| UNSPSC 6.01 | 30212109 |
| UNSPSC 7.0901 | 39121708 |
| UNSPSC 11 | 39121708 |
| UNSPSC 12.01 | 39121708 |
| UNSPSC 13.2 | 39121708 |

Approvals

Approvals

Approvals

GL

Ex Approvals

Approvals submitted

Approval details

| |
|----|
| GL |
|----|

Drawings

Cable sleeve - CES-LRG-BK-25 - 0801640

Dimensional drawing

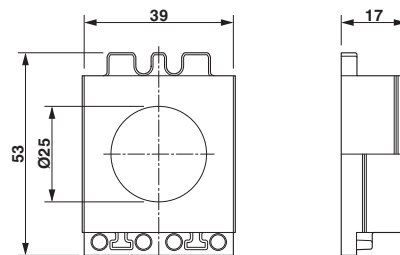

Dimensional drawing

Phoenix Contact 2016 © - all rights reserved
<http://www.phoenixcontact.com>

PHOENIX CONTACT GmbH & Co. KG
Flachsmarktstr. 8
32825 Blomberg
Germany
Tel. +49 5235 300
Fax +49 5235 3 41200
<http://www.phoenixcontact.com>



Automatización Eléctrica
Especialistas en Automatización

Below is a list of articles with direct links to our shop Electric Automation Network where you can see:

- Quote per purchase volume in real time.
- Online documentation and datasheets of all products.
- Estimated delivery time enquiry in real time.
- Logistics systems for the shipment of materials almost anywhere in the world.
- Purchasing management, order record and tracking of shipments.

To access the product, [click on the green button.](#)

| Product | Code | Reference | Product link |
|---|-------------|------------------|----------------------------|
| Large, slotted cable sleeves suitable for cables with a diameter of 24 ... 25 mm, material: NBR | 0801640 | CES-LRG-BK-25 | Buy on EAN |