

The OMRON logo is displayed in a bold, blue, sans-serif font. The letters are closely spaced and set against a light yellow rectangular background.

**Automatización Eléctrica**

Especialistas en Automatización

At the end of this document you will find links to products related to this catalog. You can go directly to our shop by clicking [HERE](#). [HERE](#)

Incremental Rotary Encoder 60 mm dia.

# E6F-C

## The Strongest Shaft for Tough Jobs

- The strongest shaft of any OMRON Incremental Encoder (120 N in radial direction and 50 N in thrust direction).
- Water- and oil-proof structure (IP65f)
- Output short-circuit protection circuit to reduce risks from incorrect wiring.
- Complementary output model can be used with extension cable
- Shock resistance strengthened by metal disk. (600 P/R max.) (Patent)



## Ordering Information

### Sensors

Supply voltage	Output form	Resolution (pulse/rotation)	Model
12 to 24VDC	Complimentary output	100, 200, 360, 500, 600	<b>E6F-CWZ5G</b>
		1000	

### Accessories (Order Separately)

Item	Model	Remarks
Coupling	<b>E69-C10B</b>	---
	<b>E69-C610B</b>	Different end diameter
	<b>E69-C10M</b>	Metal construction
Mounting Bracket	<b>E69-2</b>	Three brackets in a set; included with the Encoder.

## Dimensions (Unit: mm)

### Sensors

#### E6F-CWZ5G

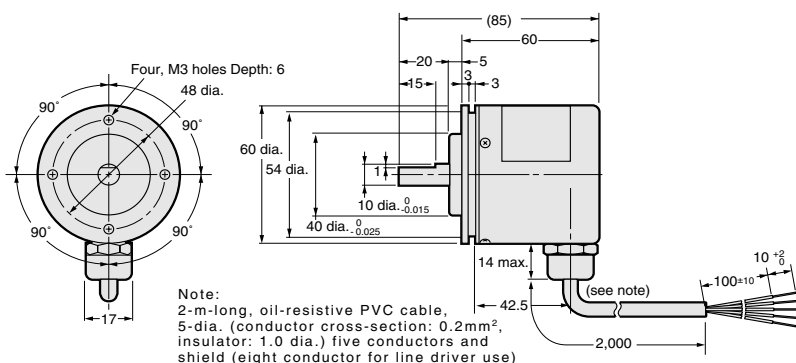

### Accessories (Order Separately)

#### Servo Mounting Bracket

#### E69-2

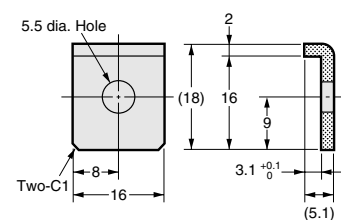

ALL DIMENSIONS SHOWN ARE IN MILLIMETERS.

To convert millimeters into inches, multiply by 0.03937. To convert grams into ounces, multiply by 0.03527.

Below is a list of articles with direct links to our shop Electric Automation Network where you can see:

- Quote per purchase volume in real time.
- Online documentation and datasheets of all products.
- Estimated delivery time enquiry in real time.
- Logistics systems for the shipment of materials almost anywhere in the world.
- Purchasing management, order record and tracking of shipments.

To access the product, [click on the green button.](#)

Product	Code	Reference	Product link
Temperature controller, 1/32DIN (48 x 24mm), 12VDC output + two event inputs, thermocouple/PT100 input, SLC	323323	E5GN-Q1BT-C AC100-240	<a href="#">Buy on EAN</a>
	231265		<a href="#">Buy on EAN</a>