

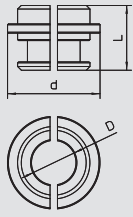

**Automatización Eléctrica**

Especialistas en Automatización

At the end of this document you will find links to products related to this catalog. You can go directly to our shop by clicking HERE. [HERE](#)



**Potential connection for installation in the insulated interception rod isFang IN**

Type	Dimension D Ø mm	Dimension d mm	Dimension L mm	Pack. pcs	Weight kg/100 pcs.	Item No.
<b>isCon IN PAE</b>	23	49.9	35	1	5.900	<b>5408 03 1</b>

**Al** Aluminium /pc.

- To avoid surface discharges on the isCon® cable
- Installation takes place after the first 1.5 metres in the insulated interception rod type isFang IN

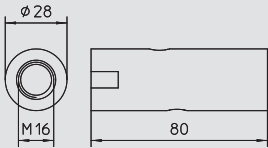

**Connection element for installation in the insulated interception rod isFang IN**

Type	Dimension D Ø mm	Thread	Pack. pcs	Weight kg/100 pcs.	Item No.
<b>isCon IN connect</b>	23	M16	1	27.800	<b>5408 02 4</b>

**V2A** Stainless steel, grade 304 /pc.

- Screw-on termination of the connection for the isCon® cable
- Connection and installation of the cable in the insulated interception rod
- Tested up to 150 kA (lightning protection Class II)

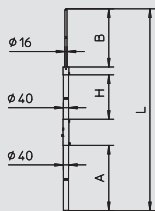

**Insulated interception rod**

Type	Dimension D Ø mm	Dimension A mm	Dimension H mm	Dimension B mm	Length mm	Materials combination	Pack. pcs	Weight kg/100 pcs.	Item No.
<b>isFang 4000 AL</b>	40	1,240	1,500	1,000	4,000	Alu / GFK	1	580.000	<b>5408 94 3</b>
<b>isFang 6000 AL</b>	40	3,340	1,500	1,000	6,000	Alu / GFK	1	600.000	<b>5408 94 7</b>
<b>isFang 4000</b>	40	1,240	1,500	1,000	4,000	V2A / GFK	1	680.000	<b>5408 94 2</b>
<b>isFang 6000</b>	40	3,340	1,500	1,000	6,000	V2A / GFK	1	1,260.000	<b>5408 94 6</b>

**GFK** Fibre-glass-reinforced plastic /pc.

Insulated support pipe for separate installation of interception units and fastening the OBO isCon® cable.

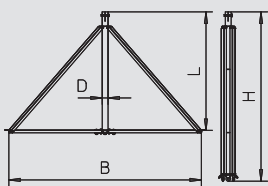

**isFang interception rod stand**

Type	Dimension B mm	Dimension D Ø mm	Dimension L mm	Dimension H mm	Pack. pcs	Weight kg/100 pcs.	Item No.
<b>isFang 3B-100 AL</b>	1,000	40	600	885	1	380.000	<b>5408 96 6</b>
<b>isFang 3B-150 AL</b>	1,500	40	900	1,275	1	560.000	<b>5408 96 7</b>
<b>isFang 3B-100</b>	1,000	40	600	885	1	620.000	<b>5408 96 8</b>
<b>isFang 3B-150</b>	1,500	40	900	1,275	1	950.000	<b>5408 96 9</b>

**V2A** Stainless steel, grade 304 **Al** Aluminium /pc.

Folding tripod stand for screwless installation of free-standing interception rods with a diameter of 40 mm, e.g. for OBO isCon® cable. Roof slope to max. 5 degrees. Incl. Rd 8–10 crossbar for rapid round conductor fastening. The concrete plinth and threaded rods are to be ordered separately.

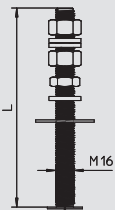
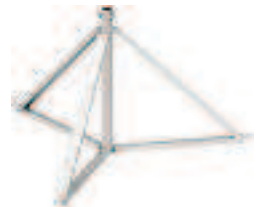

**isFang-3B threaded rod**

Type	Dimension L mm	Pack. pcs	Weight kg/100 pcs.	Item No.
<b>isFang 3B-G1</b>	270	3	48.000	<b>5408 97 1</b>
<b>isFang 3B-G2</b>	340	3	60.400	<b>5408 97 2</b>
<b>isFang 3B-G3</b>	430	3	76.600	<b>5408 97 3</b>

**V2A** Stainless steel, grade 304 /pc.

Threaded rod to fasten 1, 2 or 3 FangFix concrete bases with tripod stand. To mount the threaded rods, the edge protection must be drilled.

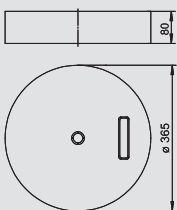

**Concrete block for FangFix-System 16 kg**

Type	Nominal size Ø mm	Pack. pcs	Weight kg/100 pcs.	Item No.
<b>F-FIX-S16</b>	365	1	1,700.000	<b>5403 22 7</b>

/100 pc.

- 16 kg stone of Ø 365 mm, high level of stability
- Concrete, frost-resistant
- Stackable





Below is a list of articles with direct links to our shop Electric Automation Network where you can see:

- Quote per purchase volume in real time.
- Online documentation and datasheets of all products.
- Estimated delivery time enquiry in real time.
- Logistics systems for the shipment of materials almost anywhere in the world.
- Purchasing management, order record and tracking of shipments.

To access the product, [click on the green button](#).

Product	Code	Reference	Product link
Adjustable floor feet for FangFix, 16kg,	5403227	F-FIX-S16	<a href="#">Buy on EAN</a>
Insulated interception rod , 4000mm, Light grey, Fibre-glass-reinforced plastic, GFK	5408942	isFang 4000	<a href="#">Buy on EAN</a>
Insulated interception rod , 4000mm, Light grey, Fibre-glass-reinforced plastic, GFK	5408943	isFang 4000 AL	<a href="#">Buy on EAN</a>
Insulated interception rod , 6000mm, Light grey, Fibre-glass-reinforced plastic, GFK	5408946	isFang 6000	<a href="#">Buy on EAN</a>
Insulated interception rod , 6000mm, Light grey, Fibre-glass-reinforced plastic, GFK	5408947	isFang 6000 AL	<a href="#">Buy on EAN</a>
Tripod stand for insulated interception rod, 1,25x1,35m, Aluminium, Alu	5408966	isFang 3B-100 AL	<a href="#">Buy on EAN</a>
Tripod stand for insulated interception rod, 1,65x1,85m, Aluminium, Alu	5408967	isFang 3B-150 AL	<a href="#">Buy on EAN</a>
Tripod stand for insulated interception rod, 1,25x1,35m, Stainless steel, grade 304, VA, 1.4301	5408968	isFang 3B-100	<a href="#">Buy on EAN</a>
Tripod stand for insulated interception rod, 1,65x1,85m, Stainless steel, grade 304, VA, 1.4301	5408969	isFang 3B-150	<a href="#">Buy on EAN</a>
Threaded rod for 1 FangFix concrete stone, 270mm, Stainless steel, grade 304, VA, 1.4301	5408971	isFang 3B-G1	<a href="#">Buy on EAN</a>
Threaded rod for 2 FangFix concrete stones, 340mm, Stainless steel, grade 304, VA, 1.4301	5408972	isFang 3B-G2	<a href="#">Buy on EAN</a>
Threaded rod for 3 FangFix concrete stones, 430mm, Stainless steel, grade 304, VA, 1.4301	5408973	isFang 3B-G3	<a href="#">Buy on EAN</a>