

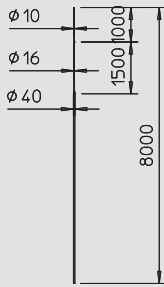

Automatización Eléctrica

Especialistas en Automatización

At the end of this document you will find links to products related to this catalog. You can go directly to our shop by clicking HERE. [HERE](#)



isFang interception rod

Type	Nominal size Ø	Dimension B	Dimension D	Dimension H	Length	Pack.	Weight	Item No.
	mm	mm	mm	mm	mm	pcs	kg/100 pcs.	
101 3B-4000	40/16/10	2,000	1,000	1,000	4,000	1	400.000	5402 86 4
101 3B-4500	40/16/10	2,500	1,000	1,000	4,500	1	480.000	5402 86 6
101 3B-5000	40/16/10	3,000	1,000	1,000	5,000	1	550.000	5402 86 8
101 3B-5500	40/16/10	3,500	1,000	1,000	5,500	1	630.000	5402 87 0
101 3B-6000	40/16/10	4,000	1,000	1,000	6,000	1	700.000	5402 87 2
101 3B-6500	40/16/10	4,500	1,000	1,000	6,500	1	780.000	5402 87 4
101 3B-7000	40/16/10	5,000	1,000	1,000	7,000	1	850.000	5402 87 6
101 3B-7500	40/16/10	5,500	1,000	1,000	7,500	1	930.000	5402 87 8
101 3B-8000	40/16/10	5,500	1,500	1,000	8,000	1	1,000.000	5402 88 0

Al Aluminium

/pc.

Tapered interception rod for isFang tripod stand.

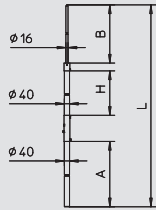

Insulated interception rod

Type	Dimension D	Dimension A	Dimension H	Dimension B	Length	Materials combination	Pack.	Weight	Item No.
	Ø mm	mm	mm	mm	mm		pcs	kg/100 pcs.	
isFang 4000 AL	40	1,240	1,500	1,000	4,000	Alu / GFK	1	580.000	5408 94 3
isFang 6000 AL	40	3,340	1,500	1,000	6,000	Alu / GFK	1	600.000	5408 94 7
isFang 4000	40	1,240	1,500	1,000	4,000	V2A / GFK	1	680.000	5408 94 2
isFang 6000	40	3,340	1,500	1,000	6,000	V2A / GFK	1	1,260.000	5408 94 6

GFK Fibre-glass-reinforced plastic

/pc.

Insulated support pipe for separate installation of interception units and fastening the OBO isCon® cable.

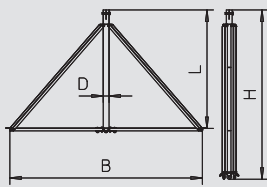

isFang interception rod stand

Type	Dimension B	Dimension D	Dimension L	Dimension H	Pack.	Weight	Item No.
	mm	Ø mm	mm	mm	pcs	kg/100 pcs.	
isFang 3B-100 AL	1,000	40	600	885	1	380.000	5408 96 6
isFang 3B-150 AL	1,500	40	900	1,275	1	560.000	5408 96 7
isFang 3B-100	1,000	40	600	885	1	620.000	5408 96 8
isFang 3B-150	1,500	40	900	1,275	1	950.000	5408 96 9

V2A Stainless steel, grade 304 **Al** Aluminium

/pc.

Folding tripod stand for screwless installation of free-standing interception rods with a diameter of 40 mm, e.g. for OBO isCon® cable. Roof slope to max. 5 degrees. Incl. Rd 8–10 crossbar for rapid round conductor fastening. The concrete plinth and threaded rods are to be ordered separately.

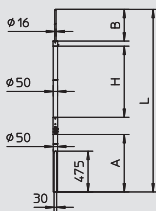
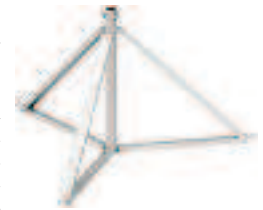

Insulated interception rod for inner-routed isCon cable with side exit

Type	Dimension D	Dimension A	Dimension H	Dimension B	Length	Materials combination	Pack.	Weight	Item No.
	Ø mm	mm	mm	mm	mm		pcs	kg/100 pcs.	
isFang IN-A 4000	50	1,325	1,500	1,000	4,000	Alu / GFK	1	535.000	5408 93 8
isFang IN-A 6000	50	3,325	1,500	1,000	6,000	Alu / GFK	1	835.000	5408 94 0

GFK Fibre-glass-reinforced plastic

/pc.

- For installation of the OBO isCon® cable in the pipe
- With side cable outlet, fitting tripod stand type isFang 3B-A
- Inclusive connection element (type isCon IN connect)
- Inclusive potential connection (type isCon IN PAE)

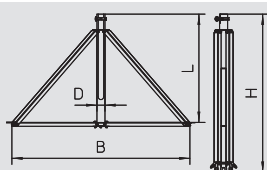

isFang interception rod stand with side exit

Type	Dimension B	Dimension D	Dimension L	Dimension H	Pack.	Weight	Item No.
	mm	Ø mm	mm	mm	pcs	kg/100 pcs.	
isFang 3B-100-A	1,026	50	600	885	1	6,100.000	5408 93 0
isFang 3B-150-A	1,500	50	900	1,275	1	950.000	5408 93 2

V2A Stainless steel, grade 304

/pc.

- Screwless installation of freestanding interception rods as well as insulated interception rods with 50 mm diameter
- e.g. for internal OBO isCon® cable
- Roof slope to max. 5 degrees
- Incl. Rd 8–10 crossbar for quick round conductor fastening
- Concrete plinths as well as threaded rods should be ordered separately





Below is a list of articles with direct links to our shop Electric Automation Network where you can see:

- Quote per purchase volume in real time.
- Online documentation and datasheets of all products.
- Estimated delivery time enquiry in real time.
- Logistics systems for the shipment of materials almost anywhere in the world.
- Purchasing management, order record and tracking of shipments.

To access the product, [click on the green button](#).

Product	Code	Reference	Product link
Lightning rod for tripod stand, 4000mm, Aluminium, Alu	5402864	101 3B-4000	Buy on EAN
Lightning rod for tripod stand, 6000mm, Aluminium, Alu	5402872	101 3B-6000	Buy on EAN
Lightning rod for tripod stand, 8000mm, Aluminium, Alu	5402880	101 3B-8000	Buy on EAN
Tripod stand + outlet for isCon cable, internal, 1,3x1,4m, Stainless steel, grade 304, VA, 1.4301	5408930	isFang 3B-100-A	Buy on EAN
Tripod stand + outlet for isCon cable, internal, 1,7x1,9m, Stainless steel, grade 304, VA, 1.4301	5408932	isFang 3B-150-A	Buy on EAN
Insul. interception rod+outlet for isCon cable, internal, 4000mm, Fibre-glass-reinforced plastic, GFK	5408938	isFang IN-A 4000	Buy on EAN
Insul. interception rod+outlet for isCon cable, internal, 6000mm, Fibre-glass-reinforced plastic, GFK	5408940	isFang IN-A 6000	Buy on EAN
Insulated interception rod , 4000mm, Light grey, Fibre-glass-reinforced plastic, GFK	5408942	isFang 4000	Buy on EAN
Insulated interception rod , 4000mm, Light grey, Fibre-glass-reinforced plastic, GFK	5408943	isFang 4000 AL	Buy on EAN
Insulated interception rod , 6000mm, Light grey, Fibre-glass-reinforced plastic, GFK	5408946	isFang 6000	Buy on EAN
Insulated interception rod , 6000mm, Light grey, Fibre-glass-reinforced plastic, GFK	5408947	isFang 6000 AL	Buy on EAN
Tripod stand for insulated interception rod, 1,25x1,35m, Aluminium, Alu	5408966	isFang 3B-100 AL	Buy on EAN
Tripod stand for insulated interception rod, 1,65x1,85m, Aluminium, Alu	5408967	isFang 3B-150 AL	Buy on EAN
Tripod stand for insulated interception rod, 1,25x1,35m, Stainless steel, grade 304, VA, 1.4301	5408968	isFang 3B-100	Buy on EAN
Tripod stand for insulated interception rod, 1,65x1,85m, Stainless steel, grade 304, VA, 1.4301	5408969	isFang 3B-150	Buy on EAN